

AREA TABLE:

TAX LOT	EXISTING	ADJUSTED
UPRR	N/A	N/A
TAX LOT 701	9,530 SQ.FT. ±	9,798 SQ.FT. ±

REGISTERED PROFESSIONAL LAND SURVEYOR

OREGON  
December 30, 2005  
ERIK M. CARLSON  
72306  
Expires: December, 2013

CS# 2013 048

DATE FILED: 12-18-13

BY: *[Signature]*

OWNER:

BARONE HOLDINGS, LLC  
PASQUALE BARONE  
1730 ORCHARD ROAD  
HOOD RIVER, OR. 97031  
UNION PACIFIC RAILROAD  
1400 DOUGLAS STREET, #1690  
OMAHA, NE



HOOD RIVER COUNTY SURVEY No. 2005027

NOTE: THIS LINE REPRESENTS THE 2ND STREET BRIDGE OVERPASS. THE STATE HAS AN EASEMENT DESCRIBED IN PP-372, DATED 1952. ODOT MAP 1A-22-14.

THIS LINE REPRESENTS THE BOUNDARY LINE ADJUSTMENT WITH THE UNION PACIFIC RAILROAD COMPANY, HOOD RIVER COUNTY SURVEY #2005-027

BASIS OF BEARING  
N 65°31'00" W  
95.06'  
(95.04°)

FOUND 5/8" IRON ROD, L.S.1815

N 65°20'40" W  
20.00'  
(20.00°)

EXISTING UNION BUILDING  
PARCEL 1 OF  
PARTITION PLAT  
#2006-14P

TAX LOT 797

N 65°33'45" W  
75.05'  
(75.04°)

TAX LOT 11200

FOUND 5/8" IRON ROD

NORTHEAST CORNER OF INSTRUMENT No. 851728.

ADJUSTED BOUNDARY LINE

BRIDGE SUPPORTS

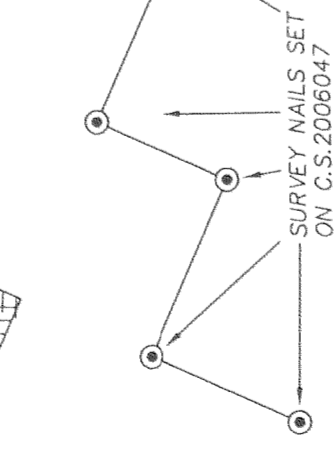

TAX LOT 701  
PARCEL 2 OF  
PARTITION PLAT  
#2006-14P

FOUND RAILROAD SPIKE

N 65°36'41" W  
86.34'  
(86.30°)

TAX LOT 500

TAX LOT 400

FOUND RAILROAD SPIKE

N 88°55'14" W  
20.97'  
(21.00°)

THIS CORNER REPRESENTS THE INTERSECTION OF THE PARCEL QUIT CLAIMED TO THE PORT OF HOOD RIVER, INSTRUMENT No. 851728 AND A LINE PARALLEL TO THE SOUTH LINE OF BLOCK 'A', FIRST ADDITION WEST SUBDIVISION.

REFERENCES:

- HOOD RIVER COUNTY ASSESSORS MAP 3N-10E-25DC
- HOOD RIVER COUNTY SURVEY No. 97003
- HOOD RIVER COUNTY SURVEY No. 2005027
- HOOD RIVER COUNTY SURVEY No. 2005047
- HOOD RIVER COUNTY DEED MICROFILM #20035506
- HOOD RIVER COUNTY DEED MICROFILM #972360
- HOOD RIVER COUNTY DEED MICROFILM #972359
- HOOD RIVER COUNTY DEED MICROFILM #961972
- HOOD RIVER COUNTY DEED MICROFILM #951219
- HOOD RIVER COUNTY DEED MICROFILM #902817
- HOOD RIVER COUNTY DEED MICROFILM #851728

LOCATION OF SURVEY:

LOCATED IN THE SOUTHWEST QUARTER OF THE SOUTH EAST QUARTER OF SECTION 25, TOWNSHIP 3 NORTH, RANGE 10 EAST, W.M., HOOD RIVER COUNTY, OR.

LEGEND:

- SET 5/8" IRON ROD WITH CAP, L.S.72306
- ⊙ FOUND SURVEY NAIL WITH 1" HEAD
- FOUND MONUMENT OF RECORD
- ⊕ FOUND RR SPIKE OF RECORD
- CALCULATED, NOT FOUND OR SET
- ( ) DEED OR PLAT CALL

NARRATIVE:  
THE PURPOSE OF THIS SURVEY IS TO ADJUST A SMALL TRACT OF LAND FROM UNION PACIFIC PROPERTY TO TAX LOT 701. A BOUNDARY LINE ADJUSTMENT WAS CONDUCTED IN 2005 BETWEEN THESE TWO PROPERTY OWNERS, BUT DID NOT EXTEND FAR ENOUGH TO THE EAST LEAVING A NOTCH OF APPROXIMATELY 24 FEET WIDE. MONUMENTS WERE RECOVERED FROM BOTH THE 2005 BOUNDARY LINE ADJUSTMENT AND THE 2006 PARTITION PLAT. RECOVERED MONUMENT POSITIONS FIT WELL WITH RECORDED DISTANCES. THE NORTH LINE OF THE 2005 ADJUSTMENT AND EXTENDED IT TO THE EAST TO THE INTERSECTION OF THE EASTERLY LINE OF PARCEL 2 OF PARTITION PLAT #200614P. THE BASIS OF BEARING IS TWO FOUND MONUMENTS ON THE NORTH LINE OF THE 2005 BOUNDARY LINE ADJUSTMENT.

MONUMENTATION IN THE AREA WAS FOUND AND IS NOTED ON THE FACE OF THE PLAT.

BOUNDARY LINE ADJUSTMENT SURVEY FOR

UNION PACIFIC RAILROAD AND BARONE HOLDINGS, LLC

TERRA SURVEYING

DATE MONUMENTED: NOVEMBER 4, 2013  
SCALE: 1" = 10'  
PROJECT: 10058BLA  
ASSESSORS MAP: 3N-10-25DC  
P.O. BOX 617  
HOOD RIVER, OREGON 97031  
PHONE: (541) 386-4531  
E-Mail: terra@terra.net  
www.terraandsurveying.com