

TERRA SURVEYING
 BOUNDARY LINE SURVEY
 for
 HOOD RIVER COUNTY FORESTRY DEPARTMENT

HOOD RIVER COUNTY
 SURVEYOR'S OFFICE
 CS# 2012 055
 DATE FILED: 12-20-12
 BY: *kg*

FOUND 2" BRASS CAP OF RECORD IN A MONUMENT BOX AT 1/4 CORNER 18/19

BASIS OF BEARING
 N 90°00'00" E 2665.47'
 (40.53 CHAINS = 2674.98' J.L.H. C.S. 0442)

FOUND 3" BRASS CAP IN A MONUMENT BOX AT SECTION CORNER 17/18/19/20

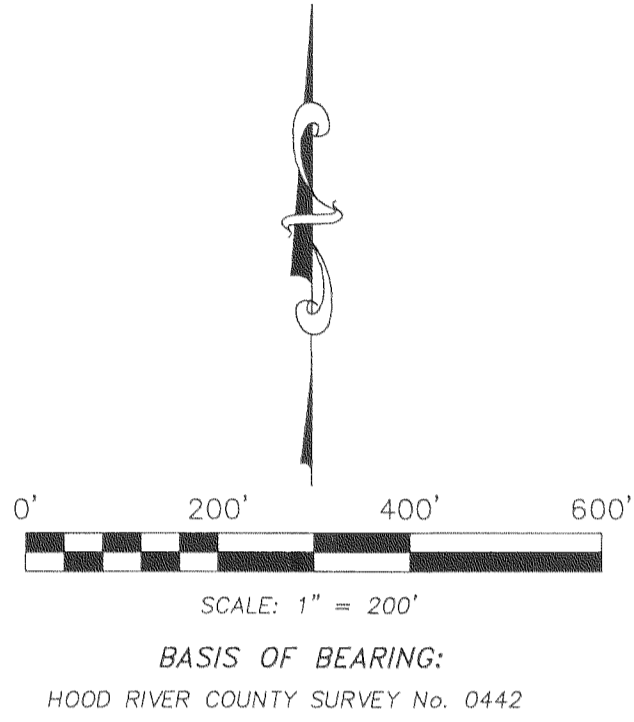

REGISTERED PROFESSIONAL LAND SURVEYOR

Erik M. Carlson

OREGON
 December 30, 2005
 ERIK M. CARLSON
 72306

Expires: December, 2013

NARRATIVE:

THE PURPOSE OF THIS SURVEY WAS TO POST LINES FOR THE HOOD RIVER COUNTY FORESTRY DEPARTMENT. WE SET 5/8" IRON RODS AT THE PROPERTY CORNERS AS SHOWN AND POSTED THE PROPERTY LINES WITH 4' WOODEN LATH AND PINK FLAGGING.

IN THE FIELD WE FOUND THE NORTH QUARTER CORNER OF SECTION 19, THE SECTION CORNER 17/18/19/20 AND THE CENTER QUARTER CORNER OF SECTION 19. THESE MONUMENTS ALONG WITH DEED DESCRIPTIONS OF ADJOINERS WERE USED IN DETERMINING PROPERTY LINES TO POST.
 AFTER AN EXHAUSTIVE SEARCH WE WERE UNABLE TO RECOVER THE EAST QUARTER CORNER OF SECTION 19. I BELIEVE THIS MONUMENT WAS OBLITERATED BY LOGGING ACTIVITY. THE ONLY LINE REQUIRING A BREAKDOWN OF THE NORTHEAST QUARTER WAS THE WEST LINE OF TAX LOT 300. THIS DEED FOLLOWS SOUTH ALONG THE WEST LINE OF THE QUARTER-QUARTER LINE. WE WERE ABLE TO CALCULATE THIS BREAKDOWN USING THE CENTER QUARTER AND A RECORD DISTANCE TO THE EAST AS BEING THE LAST KNOWN EVIDENCE OF THE POSITION OF THE EAST QUARTER CORNER. THE LEGAL DESCRIPTIONS OF REMAINING LINES WERE DESCRIBED BY HOLDING PARALLEL TO NORTH SECTION LINE AND HOLDING DISTANCES FROM THE NORTHEAST CORNER OF SECTION 19. THE WEST AND SOUTH BOUNDARIES OF TAX LOT 300 WERE FOUND TO BE INTO AN EXISTING ORCHARD WITH AN ELK FENCE AND SOME ORCHARD TREES OVER THE BOUNDARY LINE.

MONUMENTATION FOUND IN THE FIELD IS NOTED ON THE SURVEY.

LEGAL DESCRIPTIONS OF PROPERTIES ADJOINING POSTED COUNTY LINES:

TAX LOT 300:
 BEGINNING AT THE NORTHWEST CORNER OF THE NORTHEAST QUARTER OF THE NORTHEAST QUARTER OF SECTION 19, TOWNSHIP 2 NORTH, RANGE 10 EAST OF THE WILLAMETTE MERIDIAN, IN THE COUNTY OF HOOD RIVER AND STATE OF OREGON; THENCE SOUTH, ALONG THE WEST LINE OF SAID QUARTER-QUARTER FOR 595.0 FEET TO AN IRON PIPE; THENCE EAST, PARALLEL TO THE NORTH LINE OF SECTION 19, FOR 814.8 FEET; THENCE NORTH 03°45' EAST 595.3 FEET, MORE OR LESS, TO THE NORTH LINE OF SECTION 19; THENCE WEST, ALONG SAID SECTION LINE, 849.1 FEET TO THE PLACE OF BEGINNING.

TAX LOT 100:
 BEGINNING AT THE NORTHEAST CORNER OF SECTION 19, TOWNSHIP 2 NORTH, RANGE 10 EAST OF THE WILLAMETTE MERIDIAN IN THE COUNTY OF HOOD RIVER, STATE OF OREGON, AND RUNNING THENCE NORTH 87°29' WEST ALONG THE NORTH LINE OF SAID SECTION 19 244.2 FEET; THENCE SOUTH 01°15'30" WEST 891.7 FEET; THENCE SOUTH 87°29' EAST PARALLEL WITH THE NORTH LINE OF SAID SECTION 19 263.65 FEET TO THE EAST LINE OF SAID SECTION 19; THENCE NORTH ALONG SAID EAST LINE 891.7 FEET TO THE POINT OF BEGINNING.

TAX LOT 200:
 BEGINNING AT A POINT ON THE NORTH LINE OF SECTION 19, TOWNSHIP 2 NORTH, RANGE 10 EAST OF THE WILLAMETTE MERIDIAN; SAID POINT BEING NORTH 87°29' WEST A DISTANCE OF 244.2 FEET FROM THE NORTHEAST CORNER OF SAID SECTION 19; THENCE NORTH 87°29' WEST ALONG SAID NORTH LINE 244.2 FEET; THENCE SOUTH 02°31' WEST 891.7 FEET; THENCE SOUTH 87°29' EAST PARALLEL TO SAID NORTH LINE 263.65 FEET; THENCE NORTH 01°15'30" EAST 891.7 FEET TO THE PLACE OF BEGINNING.

SEARCHED EXTENSIVELY FOR THE EAST QUARTER OF SECTION 19. THIS MONUMENT WAS LAST TIED BY BISHOP IN 1980. THIS MONUMENT WAS USED BY BISHOP TO BREAKDOWN SECTION 19 AND TO MONUMENT THE CENTER QUARTER CORNER. WE WERE ABLE TO RECOVER SAID CENTER, WHICH WE USED BY HOLDING BISHOP'S DISTANCE TO CALCULATE THE SEARCH POSITION. WE ALSO HELD JOHN LELAND HENDERSON'S DISTANCE FROM THE NORTHEAST CORNER OF SECTION 19. NOTHING WAS FOUND. IT IS MY OPINION THAT LOGGING ACTIVITY HAS KNOCKED THE CORNER OUT. AREA IS ALL SCRUB AND 6" - 8" FIR REPROD. OUR SEARCH AREA WAS BELOW AN EXISTING LOGGING ROAD. A MONUMENT WAS SET AT THE CALCULATED POSITION.

- LEGEND:**
- SET 5/8" X 30" IRON ROD WITH PLASTIC CAP
 - FOUND MONUMENT OF RECORD
 - CALCULATED, NOT FOUND OR SET
 - () DEED OR PLAT CALL
 - x-x- EXISTING 8' TALL BRAIDED WIRE ELK FENCE

FOUND 2 1/2" BRASS CAP AT CENTER OF SECTION 19

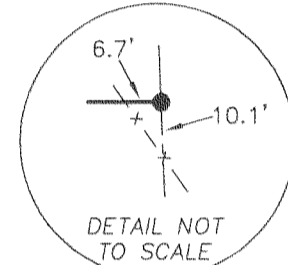

LOCATION OF SURVEY:
 LAND LOCATED IN THE NORTHEAST QUARTER OF SECTION 19, TOWNSHIP 2 NORTH, RANGE 10 EAST, WILLAMETTE MERIDIAN, HOOD RIVER COUNTY, OREGON.

- REFERENCES:**
- HOOD RIVER COUNTY SURVEY No. 0442
 - HOOD RIVER COUNTY SURVEY No. 0444
 - HOOD RIVER COUNTY SURVEY No. 0445
 - HOOD RIVER COUNTY SURVEY No. 0446
 - HOOD RIVER COUNTY SURVEY No. 80082
 - HOOD RIVER COUNTY SURVEY No. 83051
 - HOOD RIVER COUNTY SURVEY No. 93046
 - HOOD RIVER COUNTY SURVEY No. 96095

TERRA SURVEYING

DATE OF MONUMENTATION: OCTOBER 29, 2012
 SCALE: 1" = 200'
 PROJECT: 12094
 ASSESSORS MAP: 2N-10E-19
 P.O. BOX 617
 HOOD RIVER, OREGON 97031
 PHONE: (541) 386-4531
 E-Mail: terra@gorge.net
 www.terralandsurveying.com