

# BOUNDARY LINE ADJUSTMENT

A PORTION OF LOT 3 OF BLOCK 5 OF PARKHURST  
 LOCATED IN NW 1/4, OF SECTION 36,  
 T. 3N., R. 10E., W.M.  
 COUNTY OF HOOD RIVER, STATE OF OREGON  
 3N 10E 36BD TAX LOTS 4400, 4401

HOOD RIVER COUNTY  
 SURVEYOR'S OFFICE

SURVEY NO. *CS 2011 008*

FILED *3-18-11*

BY *[Signature]*

## AREA NOTE:

PARCEL	ORIGINAL AREA	NEW AREA
TAX LOT 4400	8,065 SQ. FT. 0.19 AC±	5,086 SQ. FT. 0.12 AC±
TAX LOT 4401	6,789 SQ. FT. 0.16 AC±	9,768 SQ. FT. 0.23 AC±

## LEGEND

- SET 5/8" X 30" REBAR W/1 1/4" YELLOW PLASTIC CAP MARKED (KLEIN&ASSOC. 59002LS)
- FOUND 5/8" REBAR W/1 1/4" YELLOW PLASTIC CAP MARKED (KLEIN&ASSOC. 59002LS)
- ⊙ FOUND 1/2" REBAR NO CAP
- ⊙ FOUND 1" IRON PIPE
- ⊙ FOUND BRASS SCREW IN SIDEWALK
- ⊗ FOUND 1/2" IRON ROD W/ 1/2" YELLOW PLASTIC CAP MARKED (WYEAST LS 2393)
- ▲ FOUND 5/8" REBAR
- FOUND 1/2" IRON PIPE
- ANGLE POINT NO MONUMENT FOUND OR SET
- CS NO. RECORD OF SURVEY
- RM REFERENCE MONUMENT
- FD FOUND DATA
- R1 RECORD OF SURVEY NO. 2003053
- R2 RECORD OF SURVEY NO. 80088
- R3 RECORD OF SURVEY NO. 7332
- x FENCE



## NARRATIVE

THE PURPOSE OF THIS SURVEY IS TO ADJUST THE COMMON BOUNDARY LINE BETWEEN TAX LOT 4400 AND 4401 OF HOOD RIVER COUNTY ASSESSOR MAP 3N 10E 36BD, BEING MORE PARTICULARLY DESCRIBED IN WARRANTY DEED, INSTRUMENT NO. 20032507 AND STATUTORY BARGAIN AND SALE DEED, INSTRUMENT NO. 20063283, ON FILE WITH HOOD RIVER COUNTY.

MULTIPLE SURVEYS PERFORMED ON BLOCK 5, OF PARKHURST SUBDIVISION WERE USED TO COMPUTED THE EXTERIOR BOUNDARY OF SAID BLOCK 5. BRASS SCREWS SET IN A CONCRETE SIDEWALK FOR REFERENCE MONUMENT ON THE EAST SIDE OF LOT 1 WERE HELD FOR THE BASIS OF BEARING OF THIS SURVEY, WHICH WAS ESTABLISHED BY WYEAST SURVEYS IN COUNTY SURVEY NO. 2003053. EXISTING 3/8" REBARS FOUND AROUND TAX LOT 4500, ESTABLISHED BY DIELSCHNEIDER & ASSOC. FILED AS COUNTY SURVEY NO. 7332 WERE ACCEPTED AND HELD FOR LOCATION IN THIS SURVEY. THE POSITION OF ADJUSTED LINE WAS ESTABLISHED BY THE CLIENT AND 3/8" REBARS WERE SET ON THE COMMON LINE BETWEEN SAID TRACTS LOCATED AT THE SOUTHEAST AND NORTHEAST CORNER OF TAX LOT 4400.

## REFERENCED DEEDS

STATUTORY BARGAIN & SALE DEED,  
 INSTRUMENT NO. 20063283

WARRANTY DEED, INSTRUMENT NO. 20032507

WARRANTY DEED, INSTRUMENT NO. 20092066

## REFERENCED SURVEYS

COUNTY SURVEY NO. 2003053 (WYEAST SURVEYS)  
 COUNTY SURVEY NO. 80088 (D.L.C. SURVEYING)  
 COUNTY SURVEY NO. 7332 (DIELSCHNEIDER ASSOC.)  
 COUNTY SURVEY NO. 2006037 (KLEIN AND ASSOC.)

## EASEMENT NOTE

A VARIABLE WIDTH INGRESS, EGRESS AND UTILITY EASEMENT FOR THE BENEFIT OF TAX LOT 4400 THRU TAX LOT 4401, RECORDED IN A SEPARATE DOCUMENT, RECORDED IN INSTRUMENT NO. 2011-00574, HOOD RIVER COUNTY RECORDS.

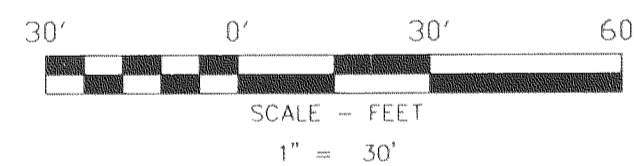

## BASIS OF BEARINGS

COUNTY SURVEY NO. 2003053

## OWNER

JEREMIAH BISHOP

SURVEY PERFORMED FOR:  
 JEREMY BISHOP  
 DATE OF MONUMENTATION  
 JAN. 14, 2011  
 PROJECT: 10-11-05  
 FILE: 101105.DWG  
 DRAFT: CEM

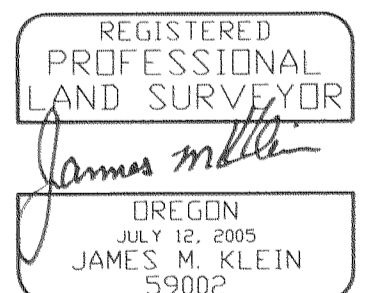

Expires 6-30-2011

**Klein & Associates, Inc.**  
 ENGINEERING • LAND SURVEYING • PLANNING

1308 12th Street, Hood River, Oregon 97031  
 Tel: (541)386-3322  
 EMAIL info@kleinassocinc.com

SHEET 1 OF 1  
 WILLAMETTE MERIDIAN  
 HOOD RIVER COUNTY, OREGON

1/4	SEC	T.	R.
36BD	3N.	10E.	

KLEIN & ASSOCIATES, MAKES NO WARRANTY AS TO MATTERS OF UNWRITTEN TITLE, ADVERSE POSSESSION, ESTOPPEL, ACQUIESCENCE.

*CS 2011 008*

RECEIVED MAR 11 2011

