

CENTER QUARTER CORNER  
SECTION 11  
FOUND AXLE

11

S88°52'39"E 672.32'

S88°52'39"E 672.32'

C-E 1/16 CORNER  
FOUND BRASS CAP  
IN MONUMENT CASE

HOOD RIVER COUNTY  
SURVEYOR'S OFFICE  
SURVEY NO. *CS 2010 037*  
FILED DATE: *9.2.10*  
BY: *[Signature]*

REGISTERED  
PROFESSIONAL  
LAND SURVEYOR

*Kevin Dowd*

OREGON  
JULY 26, 1989  
KEVIN DOWD  
2393

RENEW DATE: 12-31-11  
JULY 10, 2010

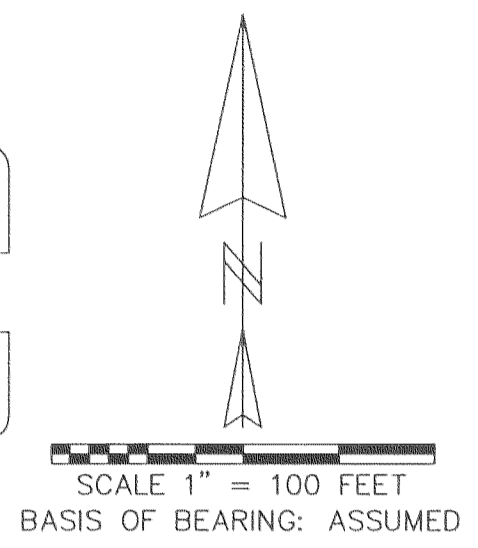

**AREA TABLE**

EXISTING TAX LOT 1200: 5.05 ACRES  
ADJUSTED TAX LOT 1200: 3.77 ACRES  
  
EXISTING TAX LOT 1800: 4.47 ACRES  
ADJUSTED TAX LOT 1800: 5.75 ACRES  
AREA INCLUDES ORCHARD ROAD RIGHT OF WAY

**LEGEND**

- SET 5/8" X 30" IRON ROD WITH YELLOW PLASTIC CAP MARKED "WYEAST LS 2393"
- CALCULATED POSITION

DATE OF FIRST MONUMENTATION: JULY 10, 2010

**NARRATIVE**

THE PURPOSE OF THIS SURVEY IS TO FILE FOR RECORD AND TO MONUMENT THE ADJUSTED LINE OF A PROPERTY LINE ADJUSTMENT BETWEEN PARCELS 1 AND 4 OF THOSE TRACTS OF LAND DESCRIBED IN MEMORANDUM OF REAL PROPERTY SALES CONTRACT RECORDED AS DOC# 2010-01408. TO ESTABLISH THE DEED DESCRIPTIONS REQUIRED A SUBDIVISION OF THE SOUTHEAST QUARTER OF SECTION 11. MONUMENTS WERE RECOVERED AND ACCEPTED AS SHOWN FOR THE SECTION SUBDIVISION. THE NORTH LINES OF THE SUBJECT TRACTS WERE ESTABLISHED BY AREA AS CALLED FOR BY THE DEED DESCRIPTIONS. THE ADJUSTED LINE WAS ESTABLISHED 169 FEET EAST OF AND PARALLEL TO THE WEST LINE OF THE SE1/4, NW1/4, SE 1/4 AS PER CLIENT INSTRUCTION.

**PROPERTY LINE ADJUSTMENT**

LOCATED IN THE SOUTHEAST QUARTER  
OF SECTION 11  
T2 NORTH, R10 EAST, W.M.  
HOOD RIVER COUNTY, OREGON

FOR: BOB ACRES, LLC

WYEAST SURVEYS  
KEVIN DOWD  
4399 WOODWORTH DR.  
MT HOOD, OR 97041  
(541) 352-6065

ORCHARD ROAD (40 FEET WIDE)  
N00°54'34"E 655.85'

WINSTON ROAD S01°07'30"W 652.04'

N00°54'34"E 655.85'

S01°01'01"W 653.94'

S89°02'23"E 671.09'

S89°02'23"E 671.09'

(TAX LOT 1700)  
PARCEL 3  
DOC# 2010-01408

(TAX LOT 1300)  
PARCEL 2  
DOC# 2010-01408

RUFF CONVEYED THE NORTH 5 ACRES TO BEERMAN BY DEED RECORDED IN BOOK 33 AT PAGE 438. A CORRECTION DEED WAS RECORDED IN BOOK 33 AT PAGE 583. THE CORRECTION DEED DESCRIPTION IS A METES AND BOUNDS DESCRIPTION WHICH MAKES NO MENTION OF THE NORTH 5 ACRES. THE CURRENT DESCRIPTION FOR TAX LOT 1300 IS THE SAME METES AND BOUNDS DESCRIPTION. I ESTABLISHED THIS LINE AS THE SOUTH LINE OF THE NORTH 5 ACRES AS PER THE TAX LOT 1200 DESCRIPTION. BOTH TAX LOTS ARE UNDER ONE OWNERSHIP AT THIS TIME WITH NO VISIBLE DEMARCATION BETWEEN THE TWO TAX LOTS.

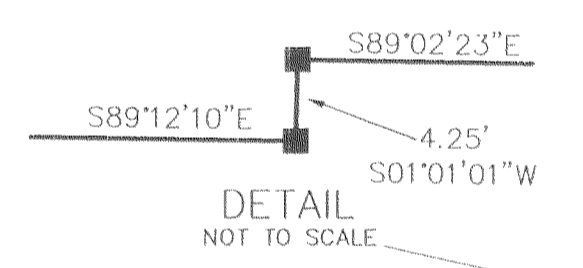

S89°12'10"E 670.47'  
NORTH LINE OF THE SOUTH 5 ACRES OF W1/2, NW1/4, SE1/4

SOUTH LINE OF THE NORTH 5 ACRES OF THE SE1/4, NW1/4, SE1/4  
S89°02'23"E 670.47'

ADJUSTED TAX LOT 1800  
5.75 ACRES  
PARCEL 4  
DOC# 2010-01408

ADJUSTED TAX LOT 1200  
3.77 ACRES  
PARCEL 1  
DOC# 2010-01408

1311.69'  
N00°54'34"E

327.34'  
S01°07'30"W 652.04'

330.85'

328.94'  
S01°01'01"W  
324.70'

324.70'

189.99'

169.00'

501.47'

117.00'  
S89°12'10"E

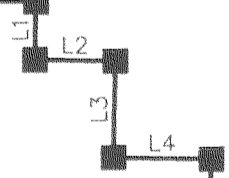

325.00'  
S01°01'01"W  
EXISTING LINE

ADJUSTED LINE  
S01°01'01"W  
328.76'

135.00'

210.00'

N89°12'10"W 669.86'

169.00'

N89°12'10"W 669.86'

327.34'  
S01°07'30"W 652.04'

SE 1/16 CORNER  
FOUND 1" IRON PIPE

LINE TABLE		
LINE	BEARING	DISTANCE
L1	S00°54'34"W	30.00
L2	S89°12'10"E	42.00
L3	S00°54'34"W	50.00
L4	S89°12'10"E	51.00
L5	S00°54'34"W	55.00

N89°38'57"W 1334.26'

E 1/16 CORNER  
CALCULATED POSITION  
CS 9511 POSITION FOR  
SE SECTION CORNER  
BEARS S89°38'57"E, 1334.26'

C-S 1/16 CORNER  
CALCULATED POSITION  
FOUND 1/2" IRON ROD  
BEARS S29°46'31"E, 0.46'

SOUTH QUARTER CORNER  
SECTION 11  
FOUND 2 1/2" IRON PIPE  
WITH LEAD PLUG