

N-C 1/16
calc. not set

Measure 37 Precautionary Notice Statement:
The parcels on this plat were allowed by Hood River County and the State of Oregon pursuant to ORS 197.352 and County Resolution No. 1501. Hood River County makes no warranties as to the transferability of the parcels and/or development rights related to them.

Basis of Bearing
GPS bearing on the east edge of Sect. 12
& CS #83015 of Section 12, T2N R10E WM

Description of total parcel
S 1/2 of NE 1/4 Sec. 12 T2N R10E
Bounded on the east by the west edge of Mount Hood Railroad recorded in Bk 26 Page 338 of deeds and on the West by that portion lying West of the center line of Mount Hood Loop Highway as in existence on Jan. 1, 1962.

400' Sp.
S=2'24'
a=0.3
N 15°41'05" E 140.49'
to offset spiral chord
997+47.16 PCS
S71°09'00"E
80.00'
N 16°40'22" E 614.43' P to P1 Spiral
1'12 CL
T delta = 9.55'00"
Ts = 614.34'
R = 4778.42'
LC = N21°29'45"E, 453.59'

Mt. Hood Hwy
East R/W edge

References:
GLO notes, deeds, surveys of record CS#7337, CS#81106, CS#82002, CS#83012, CS#83015, State Hwy maps 4F 9-8 Sh 10-13, Pacific Corps Powerdale Hydroelectric Project

Equipment: 6" Topcon Total Station or 3" Leica, closed loop, calibrated March 2007, closed loop by Least Squares or Compass Rule, 1/64781 0.058".

NE corner of Sect. 12 2N 10E; Fd. Brass Cap in Mon. Box
This corner is N0°44'29"E 2644.52' (2644.57' CS#83015) from E 1/4 Sect. 12 and the SE of Section 12 2N 10E is S0°02'02"E, 2624.85' (2625.20') CS# 83015) from the E 1/4 Sect. 12

Parcel 1
14.94 Acres

Fd 1/2" IR no cap
6" deep with a 4"x4"
Hwy post
N2°42'07"E, 3.79' from
calc point
F/Bk 2-35 S12 2/10

D = 36°43'23"
A = 414.93'
R = 647.37' at R/W
LC = S34°51'50"W, 407.86'
T = 214.87'

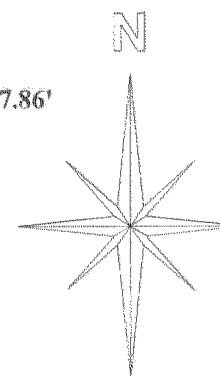

- Note:
1. ODOT requires a Limitations of Access to State Highway 35.
 2. A Road Maintenance Agreement is filed under 2007-5231
 3. Rainbow Drive shall a private road easement as allowed by law, therefore no dedication to the public is needed.
 4. The limited 40' of road easement at the State Hwy 35 is also above the 30' easement required for the number of created lots at this time.
 5. The creation of two Parcels of 2.00 Acres or more also allows for the road easement to be included in the parcel area.
 6. The new improved road at the southwest corner of Parcel 2 widened the existing road to the north and placed it on Parcel 2.

- Legend
- Set 5/8" iron rod with 2" or 2 1/2" AL Cap
 - Found monument of record
 - x-x-x Fence lines from ties near corners
 - Wt Witness tree [scribed] with nail approximating the center
 - Bt Original glo bearing tree
 - [] GLO distance or another surveyor's distance or deed call
 - Na Not accepted at this time
 - Fd. Found corner

D2AB Surveying INC.
22 Cottontail Ridge Road
White Salmon, WA 98672
Phone 509-493-3376

REGISTERED
PROFESSIONAL
LAND SURVEYOR

Dennis R. Peoples
Jan. 1, 1988
LICENSE # 2325
EXPIRES: 12/31/2008

Mt. Hood Railway
60' R/W

Fd. 5/8" IR w/2" Al/cap
Fence post east 1.0'
F/Bk 1-23 S12 2/10

Hood River County
Surveyor's Office
Survey No. CS 2007 127
Filed 12/10/07
By Roy Galt

Major Partition #07-074 (Measure 37 #07-08);
Tax Lot #900 Survey is Located in S 1/2 of
NE 1/4 Sec. 12 T2N R10E W.M.
In Hood River County for Joe & Nadine Holt

Surveyor's Certificate:
I Dennis Peoples being first duty sworn, depose and say that I have correctly surveyed and marked with proper monuments and the lands represented on this Partition Plat the boundaries being described in instrument:

Book 26 page 338 of Hood River County
of Deeds Records to Joe & Nadine Holt.

Partition Plat # 200735P
Instrument received on the 28th

Day of Nov., 2007 at 2:35 P M

Beth Day-Clerk
Hood River Director of Records and Assessments

We the owner of this land shown herein hereby declare that this division of land has been made with our free consent, and in accordance with our desires, and provisions of ORS chapter 92.

Joe Rolla Holt 2007
Owner Joe Rolla Holt Date 11-27
Barbara Nadine Holt 2007
Owner Barbara Nadine Holt Date 11-27

Acknowledgements:
This instrument was acknowledged before me

On the 27 day of November, 2007 by
Joe and Nadine Holt.

Catherine Brown
Notary signature

Notary Public in OR State
Commission No 399425
My commission expires 2/8/2009

Approvals:
I hereby certify that all taxes and assessments due have been fully paid as required by law.
Clayton Brown 11/28/2007
Hood River County Director of Budget and Finance

I hereby certify this Major Partition (Measure 37 #07-08) was examined and approved as of this
28th day of November, 2007.

Roy Galt
Hood River County Surveyor

I hereby certify this partition was examined and approved as of this 28th day of Nov., 2007.

Planning File Number #07-027
M Benedict
Hood River County Planning Director

Certified to be a true and correct copy of the ORIGINAL
Dept. of Records & Assessment
By Clay Deputy

RECEIVED DEC 10 2007

CS 2007 127