

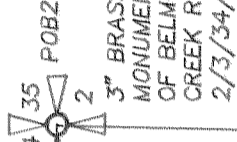

S 89°06'01" E  
675.08 (675.0)



3" BRASS CAP FOUND IN MONUMENT BOX @ INTERSECTION OF BELMONT DRIVE AND INDIAN CREEK ROAD, SECTION CORNER 2/3/34/35.

LINE NO.	BEARING	DISTANCE
L1	S 89°06'01" E	15.00
L2	S 87°06'10" E	15.75
L3	S 88°24'53" W	11.82
L4	N 89°27'28" E	28.23
L5	N 56°40'40" E	43.66
L6	N 67°49'06" E	71.78
L7	N 61°04'05" E	45.93
L8	S 80°25'46" E	53.11
L9	S 67°31'10" E	50.03
L10	S 47°50'07" E	29.56
L11	S 02°13'51" E	24.35
L12	S 61°45'18" E	41.98

**REFERENCES:**

- HOOD RIVER COUNTY SURVEY NO. 2003005(3).
- HOOD RIVER COUNTY SURVEY NO. 92006.
- HOOD RIVER COUNTY SURVEY NO. 92005.
- HOOD RIVER COUNTY SURVEY NO. 89019.
- HOOD RIVER COUNTY SURVEY NO. 87004.
- HOOD RIVER COUNTY SURVEY NO. 76072.
- HOOD RIVER COUNTY SURVEY NO. 1852.
- HOOD RIVER COUNTY SURVEY NO. 1365.
- HOOD RIVER COUNTY SURVEY NO. 1361.
- HOOD RIVER COUNTY SURVEY NO. 1356.
- HOOD RIVER COUNTY SURVEY NO. 1345.
- HOOD RIVER COUNTY SURVEY NO. 0670.
- HOOD RIVER COUNTY SURVEY NO. 0663.
- HOOD RIVER COUNTY BOOK 15 OF DEEDS, PAGE 334-335.

SET THIS CORNER BASED ON THE DEED CALL DISTANCE OF 14 RODS + 9.5' TO THE NORTH BANK OF THE CREEK.

FOUND AND HELD 1/2" IRON ROD SET BY LS 1028.

FOUND AND HELD 1" IRON PIPE ID REPRESENTING THE NORTHWEST CORNER OF TRACT OF LAND IN DEED BOOK 15, PAGE 334 OF HOOD RIVER COUNTY RECORDS. DID NOT ACCEPT A FOUND 1/2" IRON ROD LS 1028, BEARING S 78°59'43" E @ 3.26'. THIS ROD IS NOT AN ORIGINAL MONUMENT

USED THIS MEASURED DISTANCE TO SHOW THE LS 1028 IRON ROD TO THE SOUTH WAS NOT EXACTLY AT THE DEED DISTANCE BUT WITHIN TOLERANCES AS TO ACCEPT HIS CORNER AS ESTABLISHING THE WEST DEED LINE FOR THIS SURVEY.

FOUND DEED 1" ID IRON PIPE PROBABLY SET BY LS 504 IN 1965. ACCEPTED POSITION. IT IS S 45°41' E @ 0.39' FROM THE CALCULATED POSITION OF THE DEED DESCRIPTION.

MEANDER LINE OF THE NORTH TOP OF BANK OF INDIAN CREEK

FOUND 1/2" IRON ROD, LS 1028 ON PROPERTY LINE

FOUND 1/2" IRON ROD, LS 1028, ROD BEARS N 29°46'08" E AT 0.08 FEET FROM CALCULATED POSITION.

FOUND 1/2" IRON ROD, LS 1028 REPRESENTING TOP OF NORTH BANK OF INDIAN CREEK AND PER DEED.

CALCULATED THIS CORNER BASED ON A DISTANCE / DISTANCE INTERSECTION OF FOUND MONUMENTS OF RECORD.

TOTAL ACREAGE = 14.59 ACRES, ±  
LEASE AREA CONTAINS 6.25 ACRES, ±  
NET ACREAGE REMAINING = 8.34 ACRES, ±

ACREAGE REMAINING 8.34 ACRES, ±

DEED CORNER CALLS FOR AN IRON PIPE, DID NOT FIND SET CORNER AT THE DEED DISTANCE AND DIRECTION PARALLEL TO EAST SECTION LINE FROM THE FOUND IRON PIPE CREATING AN ANGLE POINT IN THE WEST LINE.

DEED CALLED IRON PIPE. FOUND 1" ID PROBABLY SET BY LS 504 IN 1965. ACCEPTED POSITION. THE CALCULATED POSITION OF THE DEED DESCRIPTION BEARS S 25°51'42" E @ 13.75' FROM THE FOUND PIPE.

**NARRATIVE:**  
THE PURPOSE OF THIS SURVEY WAS TO DEFINE THE PROPERTY BOUNDARIES OF TAX LOT 800, 900, 1000 AND 1100. MONUMENTS WERE FOUND AND NOTED ON THE PLAT. PLS 504 SURVEY, C.S. #1361, APPEARED TO CHOOSE TO DEFINE THE WEST AND EAST SURVEYED DEED LINES AS BEING NORMAL TO THE SECTION LINE. THIS IS WHERE WE FOUND HIS PIPES. HIS METHOD WOULD HAVE BEEN THE EASIEST WAY TO COMPLETE THE SURVEY IN 1965.  
PLS RESURVEYED A PORTION OF PARCEL 2 OF C.S. #1361 IN 1992, C.S. #92005, AND CHOSE TO USE THE NORTH LINE OF THE SECTION AS THE DIRECTION FOR THE WEST-BEING DEED LINES. THE C.S. #92005 SURVEY FAILED TO MENTION ANY DEED PIPES BEING FOUND OR GIVE ANY MENTION OF THE C.S. #1361 SURVEY. I ATTEMPTED TO RECOGNIZE THE MERITS OF BOTH SURVEYS ALONG WITH THE DEED CALLS. THEREBY, ATTEMPTING TO CLOSE ANY OVERLAPS WHICH MAY HAVE BEEN CREATED BY CONFLICTS BETWEEN THE DEED CALLS, C.S. #1361 AND C.S. #92005.

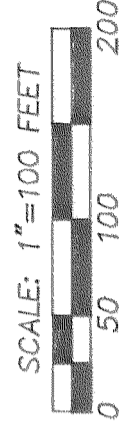

SCALE: 1"=100 FEET

BASIS OF BEARING:  
N.A.D. 83, OREGON NORTH, GRID BEARINGS

TEMPORARY CUL-DE-SAC LOCATION FOR ROAD AND UNDERGROUND UTILITIES. WHEN ARROWHEAD AVENUE IS EXTENDED TO THE WEST, THE NORTH 56.00 FEET BY 127.15 FEET OF THE TEMPORARY CUL-DE-SAC SHALL REVERT TO THE ADJOINING PROPERTY OWNER & THE SOUTH 60.00 FEET SHALL REMAIN A PUBLIC RIGHT OF WAY.

FOUND TERRA 5/8" ROD AT THE SOUTHWEST CORNER OF LOT 5, INDIAN SPRINGS.

ARROWHEAD AVENUE

REGISTERED PROFESSIONAL LAND SURVEYOR  
OREGON  
JULY 13, 1979  
ROY O. GAYLORD  
1815  
Expires: June, 2007

**LOCATION OF SURVEY:**  
PARCELS OF LAND LOCATED IN THE NORTHEAST QUARTER OF SECTION 3, TOWNSHIP 2 NORTH, RANGE 10 EAST, WILLAMETTE MERIDIAN, HOOD RIVER COUNTY, OREGON.

- LEGEND:**
- SET 5/8" X 30" IRON ROD WITH PLASTIC CAP
  - FOUND MONUMENT OF RECORD
  - CALCULATED, NOT FOUND OR SET
  - ( ) DEED OR PLAT CALL
  - ID INSIDE DIAMETER

FILED

MAY 22 2006

Robert T. Hilt  
TERRA SURVEYING

TERRA SURVEYING

DATE: FEBRUARY, 2006

SCALE: 1" = 100'

PROJECT: 206006

ASSESSORS MAP: 2N-10E-31TAX LOTS 800, 900, 1000 & 1100

P.O. BOX 617

HOOD RIVER, OREGON 97031

PHONE & FAX: (541) 398-4531

E-Mail: terra@gorge.net

PROPERTY BOUNDARY SURVEY for BROOKSIDE, INC. c/o ROBERT HANEL

SEARCHED FOR THE DEED IRON PIPE BUT WAS UNSUCCESSFUL. USED DEED CALL DISTANCE TO SET CORNER.

FOUND 2 1/2" IRON PIPE @ 1/4 CORNER SECTIONS 2/3.

CS 2006 042

CS 2006 042