

LINE TABLE		
LINE	LENGTH	BEARING
L1	3.38	S89°02'29"E
L2	15.00	S00°56'13"W
L3	15.00	N00°56'13"E
L4	15.00	N00°56'13"E

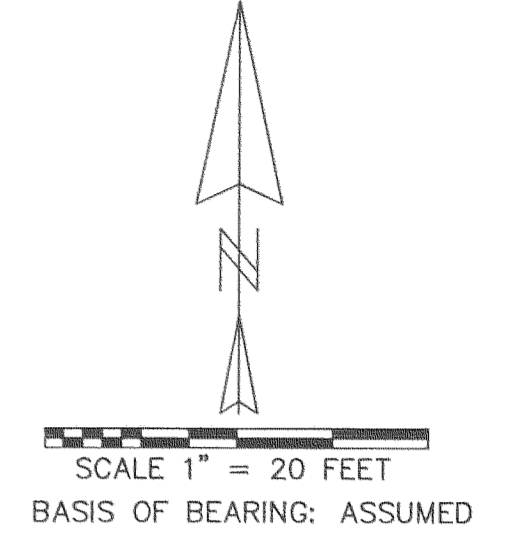

REGISTERED
PROFESSIONAL
LAND SURVEYOR

Kevin Dowd

OREGON
JULY 26, 1989
KEVIN DOWD
2393

RENEW DATE: 12-31-05
OCTOBER 20, 2005

AMENDED PLAT
OF
IDLEWILD ADDITION

LOT 6 LOT 5

15TH STREET

CASCADE STREET

NARRATIVE:

THE PURPOSE OF THIS SURVEY IS TO ESTABLISH THE BOUNDARIES OF LOTS 5 AND 6, BLOCK 9, AMENDED PLAT OF IDLEWILD ADDITION. TOGETHER WITH THAT PORTION OF THE NORTH 15 FEET OF CASCADE STREET WHICH INURED TO BY REASON OF VACATION. THE LOT BOUNDARIES WERE ESTABLISHED BY PRORATION BASED ON THE FOUND MONUMENTS AS SHOWN. MONUMENTS AS SET BY CS 79118 AT THE SOUTHWEST AND NORTHWEST CORNERS OF LOT 5 WERE SEARCHED FOR BUT NOT FOUND. LOT LINES WERE EXTENDED AT RIGHT ANGLES TO CASCADE STREET TO APPORTION VACATED CASCADE STREET.

LEGEND:

- SET 1/2" X 30" IRON ROD WITH YELLOW PLASTIC CAP STAMPED "WYEAST LS 2393"
- FOUND MONUMENT AS NOTED
- CALCULATED POSITION
- (xxx) PLAT DATA

FILED

NOV 2 2005

Kevin Dowd

LAND SURVEYOR

RECORD OF SURVEY

LOTS 5 AND 6, BLOCK 9
AMENDED PLAT OF IDLEWILD ADDITION
IN THE CITY OF HOOD RIVER
HOOD RIVER COUNTY, OREGON

FOR: LARS BERGSTROM AND NATHAN ZIEGLER

WYEAST SURVEYS
KEVIN DOWD
4399 WOODWORTH DRIVE
MT HOOD, OREGON 97041
(541) 352-6065