

BASIS OF BEARING

CENTER OF THE MAIN LINE TRACK AS OWNED AND OPERATED BY THE UNION PACIFIC RAILROAD COMPANY  
S 89°37'32" E 902.45

L2 S 89°13'46" E 12.99'  
L3 S 89°13'46" E 1.88'  
L2 L3

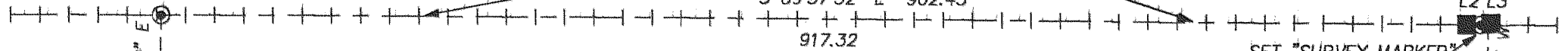

SET "SURVEY MARKER"

Δ = 1'00"14"  
R = 1096.28  
L = 19.21

LOCATED IN THE WATER

ADJUSTED PROPERTY LINE S 89°37'09" E 916.62

AREA TO BE ACQUIRED FROM THE UNION PACIFIC RAILROAD COMPANY CONTAINS 2.24 ACRES, ±.

P.O.B. OF THE ADJUSTED PARCEL TO HOWARD HOUSTON, FOUND TERRA SURVEYING 5/8" IRON ROD. LS 1028 IRON ROD 2.5' NORTHEASTERLY NOT ACCEPTED. SEE NARRATIVE.

EXISTING RAILROAD PROPERTY LINE S 75°28'31" W 421.50

NO.	DELTA	RADIUS	LENGTH
C1	1'00"14"	1096.28	19.21

LOCATED IN THE WATER

SCALE: 1"=100 FEET

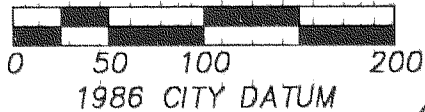

N 00°22'17" E 159.06

S 85°02'29" W 492.81

TAX LOT 700

TAX LOT 700 CONTAINS 5.75 ACRES BY THE ASSESSOR'S MAP. THE ADJUSTED AREA FROM THE RAILROAD PROPERTY WOULD MAKE THE ADJUSTED TAX LOT 700 CONTAIN 7.99 ACRES, ±.

PARCEL 1 AS SHOWN ON THE SURVEY MAP ENTITLED "PROPERTY LINE ADJUSTMENT SURVEY FOR HOWARD HOUSTON & KOK DJEN SU, COUNTY SURVEYOR'S FILE NUMBER 94124, FILED DECEMBER 2, 1994.

NO.	DELTA	RADIUS	LENGTH
C2	19'07'57"	1482.69	495.11

DEED BOOK 72 @ PAGE 211.

**FILED**

3/15/00

*Randy Galt*  
COUNTY SURVEYOR

REGISTERED PROFESSIONAL LAND SURVEYOR

*Roy O. Gaylord*

OREGON  
JULY 13, 1979  
ROY O. GAYLORD  
1815

Expires: June, 2001

**TERRA SURVEYING**

DATE: FEBRUARY 1, 2000  
SCALE: 1" = 100'  
PROJECT: 2007

P.O. BOX 817  
HOOD RIVER, OREGON 97031

PHONE & FAX: (541) 386-4531  
terra@gorge.net

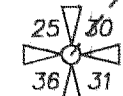

FD RR SPIKE SET BY COUNTY SURVEYOR REPLACING THE DESTROYED U.S.C.E. MONUMENT.

REFERENCES:

1936 CORPS OF ENGINEERS SURVEY OF 1936.  
VARIOUS SURVEYS BY LS1028 OF ADJOINING PROPERTY.  
TERRA SURVEYING SURVEY PROJECT 9060SETT, COUNTY SURVEYOR'S FILE No. 94124.  
LS1028 SURVEY, COUNTY SURVEYOR'S FILE No. 96062.

NARRATIVE:

I FOUND COUNTY SURVEY FILE No. 96062 BY LS 1028'S DEED POINT POINT OF BEGINNING POINT NOT TO BE 100' FROM THE EXISTING CENTER OF THE MAIN LINE TRACK SO ADJUSTED THE DEED CALL FROM THE SECTION CORNER AS NOT TO CAUSE A GAP OR OVERLAP OF THE PROPERTY DESCRIPTION TO THE WEST.

LOCATION OF SURVEY:

A PORTION OF THE SOUTHWEST QUARTER OF SECTION 30, TOWNSHIP 3 NORTH, RANGE 11 EAST, W.M., HOOD RIVER COUNTY, OR. IN A PORTION OF THE NATHAN L. BENSON DONATION LAND CLAIM No. 37.

LEGEND:

- ⊙ SET 1" CAP BY 3" LONG "SURVEY MARKER"
- FOUND TERRA MONUMENT OF RECORD
- CALCULATED, NOT FOUND OR SET
- ( ) DEED OR PLAT CALL

PROPERTY BOUNDARY ADJUSTMENT  
for  
HOWARD HOUSTON