

NOTES:
① Set Iron Rod on property line near old Highway 35 right-of-way
② Set R/R spike at intersection of existing Highway 35 right-of-way with approximate location of old Highway 35 right-of-way

REGISTERED PROFESSIONAL LAND SURVEYOR
Randal B. Johnston
OREGON
JULY 25, 1990
RANDAL B. JOHNSTON
2455
Next Date of Renewal:
December 31, 1999

SURVEY
for
LYNETTE CROWLEY
Hood River, Oregon

FILED
DEC 16, 1999
Rachel A. Smith
COUNTY SURVEYOR

NARRATIVE

Tied iron rods along Highway 35, and on subject parcel as shown on plat. Traversed to Quarter Corner between sections 2 and 3, found iron rod as per PLS 1028. Set iron rods near Old Highway 35 right-of-way, as could find no record of it having been vacated.

BASIS of BEARING:

Bearings based on PLS 1028, dated 10/18/77.

LOCATION:

Property located in the Southwest Quarter of Section 2, Township 1 North, Range 10 East, Willamette Meridian, in Hood River County, Oregon.

REFERENCES:

- PLS 1815, CS #98002, dated 12/97
- PLS 1028, CS #86029, dated 4/29/86
- PLS 1028, CS #88004, dated 12/6/87
- PLS 1028, CS #84029, dated 3/14/84
- PLS 1028, revised 10/15/77
- OSHD 14V-56, As Constructed, 11/10/82
- ODOT 9B-2-11
- Original Highway 35 Location Map
- HRC Film #982716, dated 6/10/98
- HRC Film #701584, dated 10/7/70
- HRC Film #711469, dated 8/19/71
- Book 75, Page 284, HRC Deed Records

LEGEND:

- FOUND MONUMENT OF RECORD, OR AS NOTED
- CALCULATED, NOT SET OR FOUND
- SET IRON ROD W/ RED PLASTIC CAP: "LS 2455" UNLESS NOTED OTHERWISE
- (XX.XX') DEED OR PLAT CALL
- ⊕ FOUND BRASS CAP AS NOTED

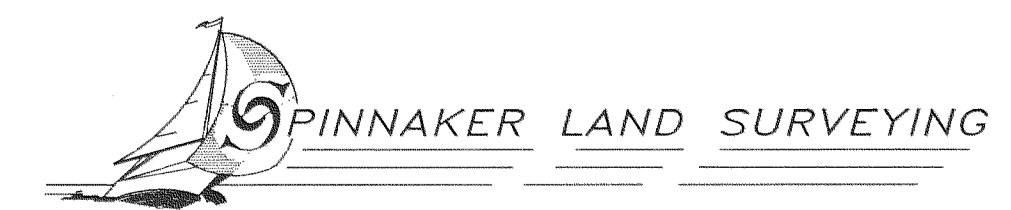

210 East Sherman Avenue
Hood River, Oregon 97031
541-386-1470
Fax: 541-387-2622
email: Spinsur@aol.com
October, 1999

(1N 10 2, TL's 1200)