

PARTITION IN  
NW 1/4 SEC 2 & N 1/2 SEC 11, T 1 N, R 10 E, WM  
HOOD RIVER COUNTY, STATE OF OREGON

OCT 01 1999

Certified to be a true and correct copy of the ORIGINAL  
Dept. of Records & Assessment  
by *[Signature]* Deputy

FILED  
RECORDS AND ASSESSMENT  
HOOD RIVER CO.

SEP 30 3 30 PM '99

PARTITION PLAT NO. 9921

Instrument received on the 30<sup>th</sup> day of September, 1999 at 3:30 p.m.

Hood River County Director of Records and Assessments

SURVEYS CERTIFICATE

I, Anthony C. Klein, being first duly sworn, depose and say that I have correctly surveyed and marked with proper monuments the lands represented on this Partition Plat, the boundaries being described in Instrument No. (See Note:)

*[Signature]*  
ANTHONY C. KLEIN PLS 932

ACKNOWLEDGEMENTS

We the owners of the land shown herein, hereby declare that this division of land has been made with our free consent and in accordance with our desires.

*[Signature]* Michael Paul 9/30/99  
NAME Date

STATE OF OREGON

COUNTY OF Hood River } ss

Subscribed and sworn to before me on this 30<sup>th</sup> day of September, 1999

by *[Signature]* Bertha M. Arborea

Notary Public for the State of Oregon

My commission expires 12-31-2001

*[Signature]* Daniel B. Barlett

*[Signature]* Daniel B. Barlett 9/28/99  
NAME DATE

*[Signature]* Ingrid B. Barlett 9/28/99  
NAME DATE

*[Signature]* Ingrid B. Barlett  
STATE OF OREGON - Arizona } ss

COUNTY OF Maricopa } ss

Subscribed and sworn to before me on this 28<sup>th</sup> day of September, 1999

by *[Signature]* Cynthia K. Meyers

Notary Public for the State of Oregon Arizona

My commission expires 6/30/2003

APPROVALS

I hereby certify that all taxes and assessment due hereon have been fully paid as required by law.

*[Signature]*  
Hood River County Director of Budget and Finance.

I hereby certify this partition was examined and approved as of this 17 day of Sept., 1999

*[Signature]*  
Hood River County Surveyor

I hereby certify this partition was examined and approved as of this 30<sup>th</sup> day of September, 1999

*[Signature]*  
Hood River County Planning Director

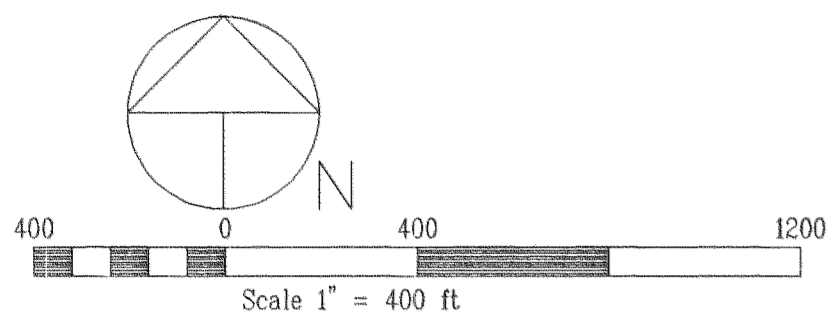

NARRATIVE OF SURVEY

THE PURPOSE OF THIS SURVEY IS TO CONSOLIDATE TAX LOTS 1800, #1803, & #1805, IN T 1 N, R 10 E, SEC. 2, AND TAX LOTS 200 & 302 IN T 1 N, R 10 E, SEC 11, INTO A SINGLE ARCEL AND TO DIVIDE THE PARCEL INTO ONE 80 ACRE PARCEL AND ONE 165 +/- ARCE PARCEL. NO SURVEY WAS DONE ON THE LOCATION OF THE PARCELS. ALL LOCATIONS WERE BY OTHER SURVEYS IN THE AREA.

NOTE:

boundaries being described in Instrument No. 923655 dated DEC. 16, 1992, Hood River County Records, to HUBERT J. PESSL

boundaries being described in Instrument No. 921685 dated MAY 17, 1992, Hood River County Records, to HUBERT J. PESSL

boundaries being described in Instrument No. 923652 dated DEC. 10, 1992, Hood River County Records, to HUBERT J. PESSL

boundaries being described in Instrument No. 910841 dated APRIL 11, 1991, Hood River County Records, to HUBERT J. PESSL

REFERENCE SURVEYS

- SURVEY BY HRC CS #88037
- SURVEY BY HRC CS #76074
- SURVEY BY DLC SURVEYING CS #95097
- SURVEY BY DLC SURVEYING CS #91064
- SURVEY BY DLC SURVEYING CS #86029
- SURVEY BY DLC SURVEYING CS #88004

LEGEND

- = SET 5/8" IR WITH PLASTIC CAP MARKED OR #932 & WA #22098 EXCEPT AS NOTED
- = FOUND MONUMENT AS NOTED
- = CALCULATED CORNER AS NOTED
- ⊗ = CALCULATED 1/4 COR AS NOTED
- ⊗ = CALCULATED SEC COR AS NOTED
- ⊗ = FOUND 1/4 COR AS NOTED
- ⊗ = FOUND SEC COR AS NOTED

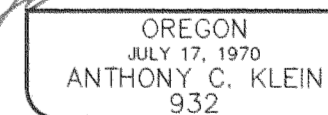
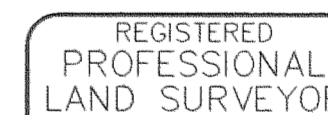
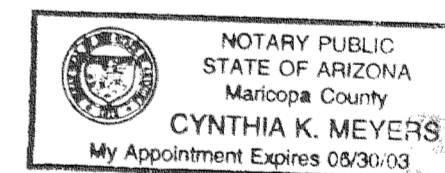
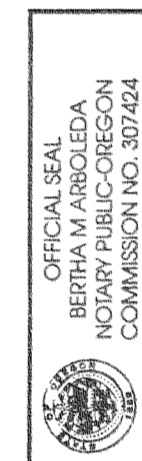

**Klein & Assoc.**  
LAND SURVEYING  
1114 June Street  
Hood River, Oregon 97031  
Tele: (541)386-3322  
DATE: AUGUST 1999  
JOB NO.: 98074

NUMBER	DIRECTION	DISTANCE
L1	N 66°42'26" W	122.91'
L2	N 08°22'41" E	253.00'
L3	N 42°25'25" W	94.80'
L4	S 86°46'30" W	255.00'
L5	N 86°46'34" E	50.00'
L6	N 86°47'58" E	189.62'

**FILED**

OCT 27, 1999  
*[Signature]* Rick G. Abel  
COUNTY SURVEYOR

PARTITION FOR

MICHAEL PESSL, & INGRID & DAN BARLETT