

"BELL-WILLIAMS SUBDIVISION"
 A SUBDIVISION LOCATED IN THE SOUTHEAST 1/4
 OF SECTION 35, T. 3 N., R. 10 E., W.M.,
 HOOD RIVER COUNTY, OREGON

DEDICATION :
 Eagle Homes, Inc., an Oregon corporation, as owner in fee simple of the land shown on the annexed plat and more particularly described in the Surveyor's Certificate hereunto attached, hereby dedicate to the public forever all streets and public easements shown on such plat and that we declare the annexed plat of "Bell-Williams Subdivision" to be a correct plat as located in the Southeast 1/4 of Section 35, Township 3 North, Range 10 East of the Willamette Meridian in Hood River County, Oregon.

R.M. Paddock
 R.M. Paddock, Chairman of Eagle Homes, Inc.

ACKNOWLEDGEMENT :
 On this 25th day of November 1996, before me a notary public for the State of Oregon, personally appeared R.M. Paddock, Chairman of Eagle Homes, Inc., known to me, who being first duly sworn, said that he did sign this instrument of his free and voluntary act. Further more R.M. Paddock did say that he was Chairman of Eagle Homes, Inc., an Oregon Corporation, and that the instrument was signed in behalf of said Corporation and to be the free act and deed of said corporation.

Balene Cooper
 Notary Public for the State of Oregon

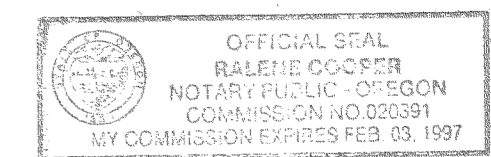

My Commission expires : 2-3-97

NOTE:
 All lots within "BELL-WILLIAMS SUBDIVISION" are required to participate in "BELL-WILLIAMS HOMEOWNERS ASSOCIATION". Said association membership will be automatic upon purchase of lot.

The West 4.00' of the South 90.00' of Parcel No. 3 of Partition Plat No. 9418 being dedicated to "Bell-Williams Homeowners Association"

Basis of bearing, survey control, and monuments found as per Frost Partition Plat No. 9418.

○ = 5/8" iron rod monument set with yellow, plastic cap stamped "LS 1028" affixed, unless noted.

NARRATIVE: The purpose of this survey was to plat "Bell-Williams Subdivision".

GRAPHIC SCALE

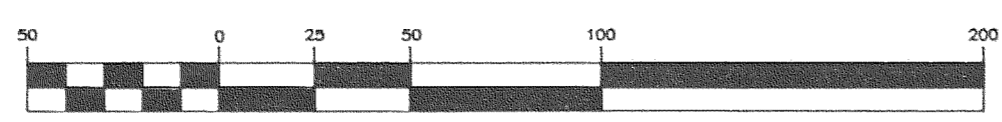

CURVE	RADIUS	LENGTH	TANGENT	CHORD	BEARING	DELTA
C-1	50.00'	80.50'	52.00'	72.09'	N 43°54'28" E	92°15'06"
C-2	50.00'	30.47'	15.72'	30.00'	N 19°40'32" W	34°54'55"
C-3	50.00'	35.76'	18.68'	35.00'	S 57°37'14" E	40°58'29"
C-4	50.00'	62.71'	36.23'	58.68'	N 65°57'46" E	71°51'31"
C-5	50.00'	52.36'	28.87'	50.00'	N 60°02'00" E	60°00'00"
C-6	162.50'	91.34'	46.91'	90.14'	N 73°55'53" E	32°12'15"
C-7	15.00'	23.44'	14.88'	21.13'	S 45°11'45" E	89°32'30"
C-8	40.00'	62.51'	39.68'	56.34'	S 45°11'45" E	89°32'30"
C-9	65.00'	101.58'	64.48'	91.56'	N 45°11'45" W	89°32'30"

SURVEYOR'S CERTIFICATE :

I, Danny L. Cron, registered Professional Land Surveyor for the State of Oregon, No. 1028, being first duly sworn depose and say that I have correctly surveyed and marked with legal monuments the land represented on the annexed plat of "Bell-Williams Subdivision", as located in the Southeast 1/4 of Section 35, Township 3 North, Range 10 East, Willamette Meridian, Hood River County, Oregon, and that a 2 1/2 inch by 36 inch galvanized iron pipe marks the Initial Point of said "Bell-Williams Subdivision".

Said Initial Point bears N.07°28'22"E. a distance of 1549.00 feet from the South 1/4 corner of said Section 35. Said "Bell-Williams Subdivision" being more particularly described as follows:

Beginning at the afore described Initial Point; thence S.89°58'00"E. a distance of 538.80 feet; thence S.00°50'00"E. a distance of 54.45 feet; thence S.81°36'07"W. a distance of 112.48 feet; thence S.00°25'30"E. a distance of 200.00 feet; thence N.88°53'12"W. a distance of 54.02 feet; thence N.00°25'30"W. a distance of 90.00 feet; thence N.88°53'12"W. a distance of 368.89 feet; thence N.02°05'15"W. a distance of 173.08 feet to the point of beginning.

The parcel is also Parcel No. 3 of Partition Plat recorded October 19, 1994 as Partition Plat No. 9418.

Subscribed and sworn before me this 22 day of Nov., 1996.

Annette Santacrose Dowd
 Notary Public for the State of Oregon

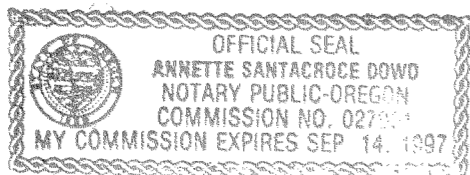

My Commission expires : Sept. 14 1997

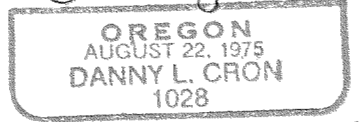
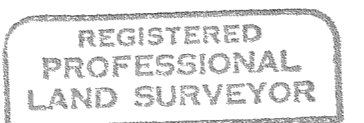
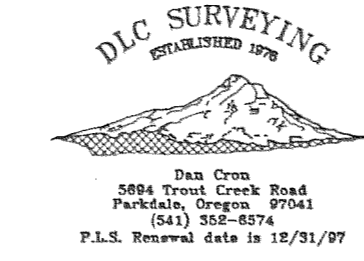

Nov. 22, 1996

APPROVALS :

I, hereby certify that all taxes and assessments due hereon have been paid as required by law and hereby approve the plat of "Bell-Williams Subdivision".

Don Fahn 2-5-97
 Hood River County Director of Budget and Finance Date

I, hereby certify that I have examined the plat of "Bell-Williams Subdivision" and that the name adopted to said plat is a proper name and not included in any other subdivision in Hood River County and hereby approve said plat.

Sandra E. Berry 2/6/97
 Hood River County Director of Records and Assessments Date

We, the undersigned, say that we have examined the plat of "Bell-Williams Subdivision" in Hood River County, Oregon, and hereby approve said Plat.

Donald E. Chandler 11-26-96
 Ice Fountain Water District Date

Richard G. Arnold 11/26/96
 Hood River County Surveyor Date

John F. ... 11/26/96
 County Director of Public Works Date

Roger Kauble 11-26-96
 Hood River City Engineer Date

Cynthia Walbridge 11-25-96
 City Planning Director Date

Cynthia Walbridge 11-25-96
 Farmers Irrigation District Date

Scott Stiel 11-26-96
 Hood River County Sanitarian Date

Duffny S. Hunt 2-5-97
 County Planning Director Date

Jim Thael 11-25-96
 Westside Rural Fire Prot. Dist. Date

... 11-29-96
 County Planning Chairman Date

Chuck Thorne 12-2-96
 County Commissioner Date

John ... 12/2/96
 County Commissioner Date

Blenn E. Best 12/2/96
 County Commissioner Date

Beverly A. Rowland 12/2/96
 County Commissioner Chairman Date

Filed for Record this _____ day of _____, 1996
Sandra E. Berry
 Hood River County Director of Records and Assessments

FILED
 MAR 18 1997
Bill ...
 COUNTY SURVEYOR