

Section Corner  
Found Brass Cap

21 | 22

28 | 27

1/4 Corner  
Found Brass Cap

22

27

2663.02'  
N 85°42'53" W

NOTE: R/W Deed Book 83, pg.497, which calls for existing fence, creates a gap between the South R/W line and the North line of Deed Book 23, pg.577 as shown.

Point held 660.0' from Axle thru fence corner as assumed to have been held in R/W Survey.

Original Deed Line Vauthiers to Aubert Book J, pg. 479, 12/26/1903.

S 86°22'17" E  
990.00'  
Deed/Held

T.L. 1402  
Film #710329, 2/24/1971

T.L. 800

Original Deed Sallstrom to Miller Book 40, page 70, 3/14/1949

Original Deed Vauthiers to Sallstrom Book 23, page 577, 3/14/1933.

Basis of Bearing and Partial Section control as per HRC CS 84054.

NOTE: Iron rod (IR) monuments set have yellow, plastic cap stamped "LS 1028" affixed.

NARRATIVE: The purpose of this survey was to locate certain boundaries of existing Tax Lots as shown.



2687.85'  
N 01°15'08" E

T.L. 1400

660.00' Deed/Held  
Book 23, pg.577  
Book J, pg.479  
Book 83, pg.497

1/4 Corner  
Found Axle S.87°16'09"E. at 1724.40'  
Found Bent 5/8" IR N.89°W. at 22.9'

28 | 27

1354.65'

1/16th Corner

T.L. 1501

1359.74'  
N 86°23'44" W

Gov't Lot 11

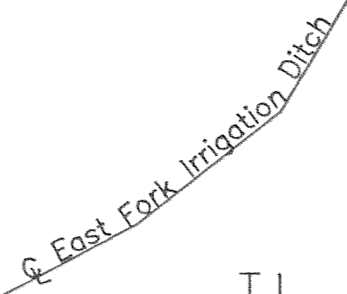

T.L. 1700

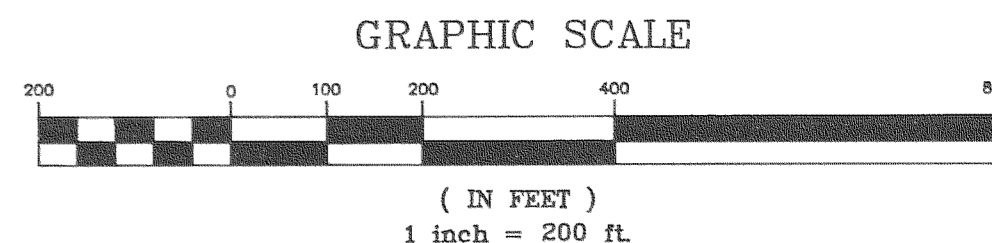

"SURVEY"  
FOR — The Estate of Louis Zeman  
LOCATION — Parcels located in the West 1/2 of Section 27, Township 1 North, Range 10 East, Willamette Meridian —  
HOOD RIVER COUNTY, OREGON

FILED

FEB 2, 1994

*Rick G. Andl*  
COUNTY SURVEYOR

DEPUTY

REGISTERED  
PROFESSIONAL  
LAND SURVEYOR

*Danny L. Cron*  
OREGON  
AUGUST 22, 1975  
DANNY L. CRON  
1028

Nov. 27, 1993

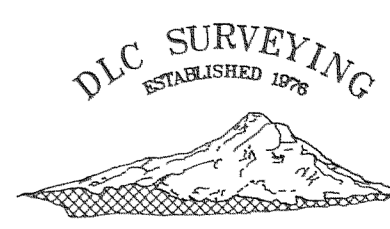

Dan Cron  
5694 Trout Creek Road  
Parkdale, Oregon 97041  
(503) 352-6574

2683.72'  
N 01°25'57" E

28 | 27

33 | 34

Section Corner  
Found Brass Cap

1371.09'

1/16th Corner

S 85°02'52" E  
2742.18'

Found 5/8" IR

391.74'

Found 5/8" IR

437.00'

1/16th Corner  
Found 5/8" IR

See DLC 6/21/77 Survey.

2776.52'  
S 83°44'39" E

1407.29'

27

34

1/4 Corner  
as per HRC