

NORTH LINE @ 20 SCALE

FD: R/R IRON, DLC LINE, CITY MON. B-4  
 FD: IRON ROD @ INTERSECTION OF COE DLC LINE AND NORTH LINE OF BLOCK 1, WINANS ADD., AS PER CS #86024

① CALC. POSITION AS PER CS #78020; FD: IR AS PER CS #90025

CALCULATED AS PER CS #78020.

FD: U.S.C.E. BC/IP, DLC CORNER

FD: I.R. AS PER PERKINS, 8/12/57 FOR METSKER

FD: I.R. AS PER CS #7508

OCT 10, 1990

**FILED**

*Roy O. Cayford*  
 COUNTY SURVEYOR

**NARRATIVE:**

NO DISCREPANCIES WERE FOUND WITH TERRA'S OTHER SURVEYS PLEASE SEE REFERENCED TERRA SURVEYS FOR DETAILS ON SURVEY CONTROL.

**LOCATION OF SURVEY:**

PORTIONS OF LOTS 16 AND 17, BLOCK 25 OF HOOD RIVER PROPER, IN THE CITY OF HOOD RIVER, HOOD RIVER COUNTY, OREGON.

**BASIS OF BEARING:**

ASSUMED DATUM

**REFERENCES:**

TERRA SURVEYING #S 9025, 9025A, AND 9034

**LEGEND:**

- SET 5/8" X 30" IRON ROD W/CAP
- FOUND MONUMENT OF RECORD
- CALCULATED, NOT FOUND OR SET
- ( ) DEED OR PLAT CALL

**TERRA SURVEYING**

DATE: SEPTEMBER, 1990  
 SCALE: 1" = 60'  
 PROJECT: #9034B  
 P.O. BOX 617  
 HOOD RIVER, OR. 97031  
 PHONE (503) 386-4531

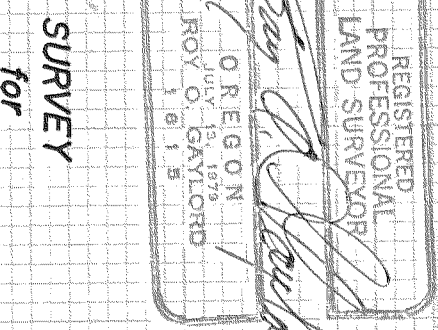

**BRYON L. RAFENSON**

HOOD RIVER, OREGON

SURVEY for

CS # 90078