

FOUND BRASS CAP, ACCEPTED HRC'S 1970 POSITION AS ESTABLISHED BY J.L. HENDERSON FOR THE SAME REASONS AS STATED FOR THE SOUTH 1/4 COR.

ACCEPTED FOUND AXLE AS PERPETUATING HENDERSON'S POSITION.

FOUND HRC BRASS CAP; VERIFIES AXLE @ SE 1/4 TO PERPETUATE HENDERSON'S POSITION.

TERRA SURVEYING MEASURED THREAD OF NEAL CREEK START

SW	82	50	31	70.00
NW	44	44	59	49.59
NW	14	30	17	44.56
NW	13	10	55	40.10
NW	27	14	25	61.16
NW	40	50	13	138.57
NW	86	41	06	84.22
NW	43	34	14	49.96
NW	21	45	58	32.69
NW	51	34	35	83.63
NW	42	57	49	109.54
NW	31	51	52	180.53
NW	65	45	58	57.63
NW	16	47	01	62.31
NE	11	26	55	40.83
NE	28	46	29	69.64
NE	13	18	20	50.23
NW	43	26	32	58.25
NE	14	31	53	100.32
NE	27	10	03	84.65
NE	2	12	39	15.21

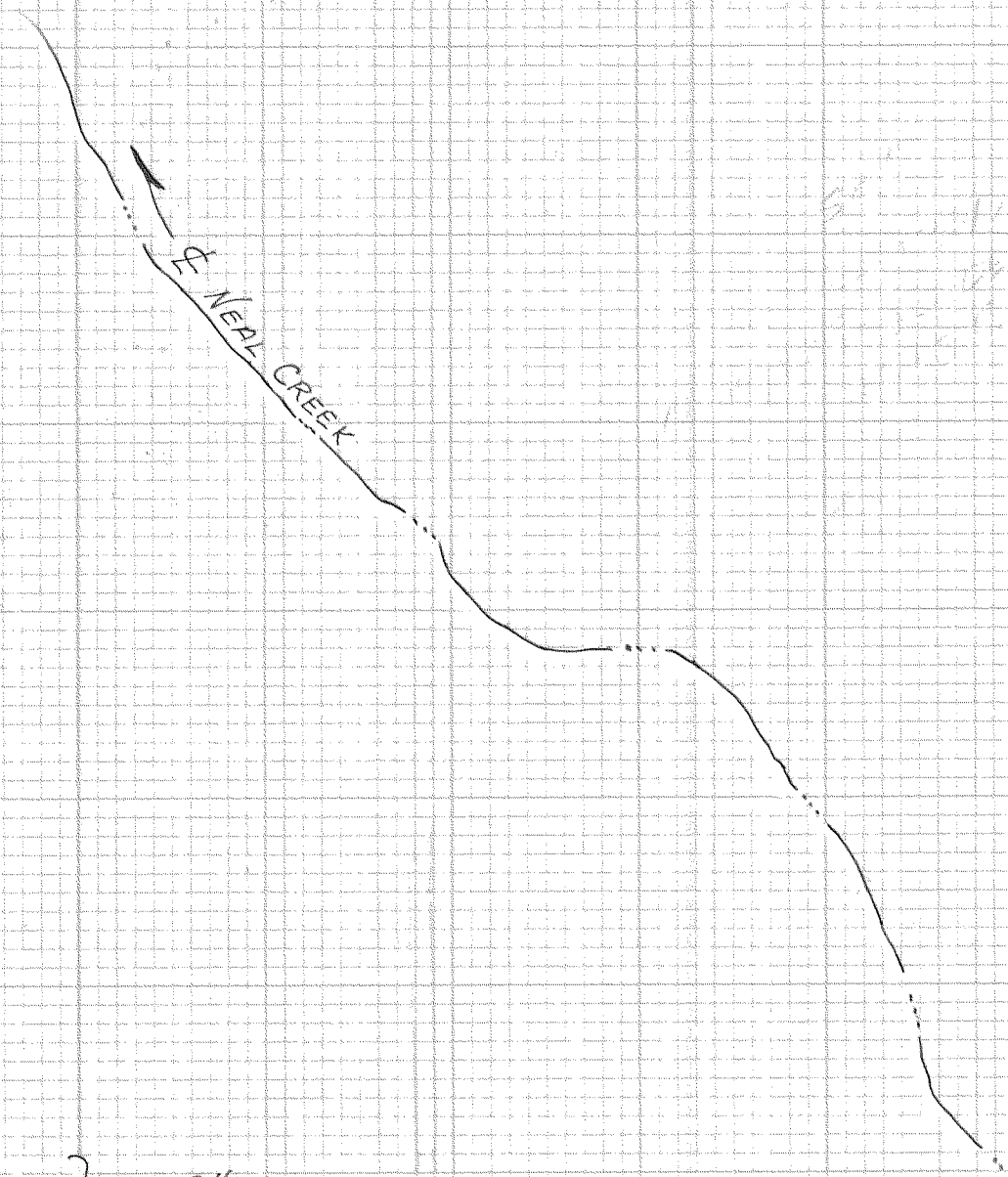

**NARRATIVE**  
 LINES AS MONUMENTED FIT WELL TO LINES OF USE.  
 ACREAGES BASED ON NEAL CREEK'S CHANNEL AS OF DATE OF SURVEY, ACKNOWLEDGING SOME MOVEMENT DUE TO ACCRETION.

**FILED**  
 AUG 29  
 Richard A. Arnold  
 COUNTY SURVEYOR

BASIS OF BEARING  
 TERRA SURVEYING PROJECTS #s 8331, 8352

REFERENCE: J.L. HENDERSON SURVEY # 241, AUGUST 13, 1908, HOOD RIVER COUNTY (H.R.C.) SURVEYS OF 1970 AND OCTOBER 1983, DANNY L. CROON'S VARIOUS SURVEYS OF THIS SECTION.

LOCATION  
 NW 1/4 SE 1/4 SECTION 36,  
 T2N, R10E, W1M.

**LEGEND**  
 ○ FOUND MONUMENT  
 ● SET IRON ROD  
 □ CALCULATED POSITION

REGISTERED PROFESSIONAL LAND SURVEYOR  
 Roy O. Gaylor  
 OREGON  
 JULY 13, 1979  
 ROY O. GAYLORD  
 1915

ACCEPTED 1983 HRC POSITION FOR S 1/4  
 FOUND BRASS CAP  
 J.L. HENDERSON ESTABLISHED THIS POSITION BY THE LAWS AND EQUIPMENT PREVAILING AT THE TIME AND I FEEL IT WOULD BE ARBITRARY TO MOVE SUCH A CORNER. THEREFORE I ACCEPTED THIS POSITION, EVEN THOUGH IT IS OFF THE SECTION LINE'S MIDPOINT.

NOTE: BRASS CAP FOUND AT THE SE 1/4 POSITION BY HRC. WAS NOT ACCEPTED AS IT WAS BASED ON THE ERRONEOUS POSITION OF THE SE SECTION CORNER.

ACCEPTED 1983 HRC POSITION SET FROM BEARING TREES.

SURVEY  
 CLEM POPE  
 HOOD RIVER

TERRA SURVEYING  
 DATE: AUGUST, 1986  
 PROJECT # 8330  
 P.O. BOX 617  
 HOOD RIVER OREGON 97031  
 (503) 386-4531  
 SCALE: 1" = 100'

# 86054