

CITY MON #19

USED CITY COORDINATES

NARRATIVE

SEE TERRA SURVEY PROJECT NO B11 FOR EXPLANATION OF 329 STREET LOCATION.

HELD SOUTH LINE OF BLOCK 1 PARALLEL WITH NORTH LINE D.L.C., AND WESTLINE BLOCK 1 AS PER SURVEY B11

NO BLOCK CORNERS WERE FOUND

SKETCH OF WEST LINE
(SCALE: 1"=20')

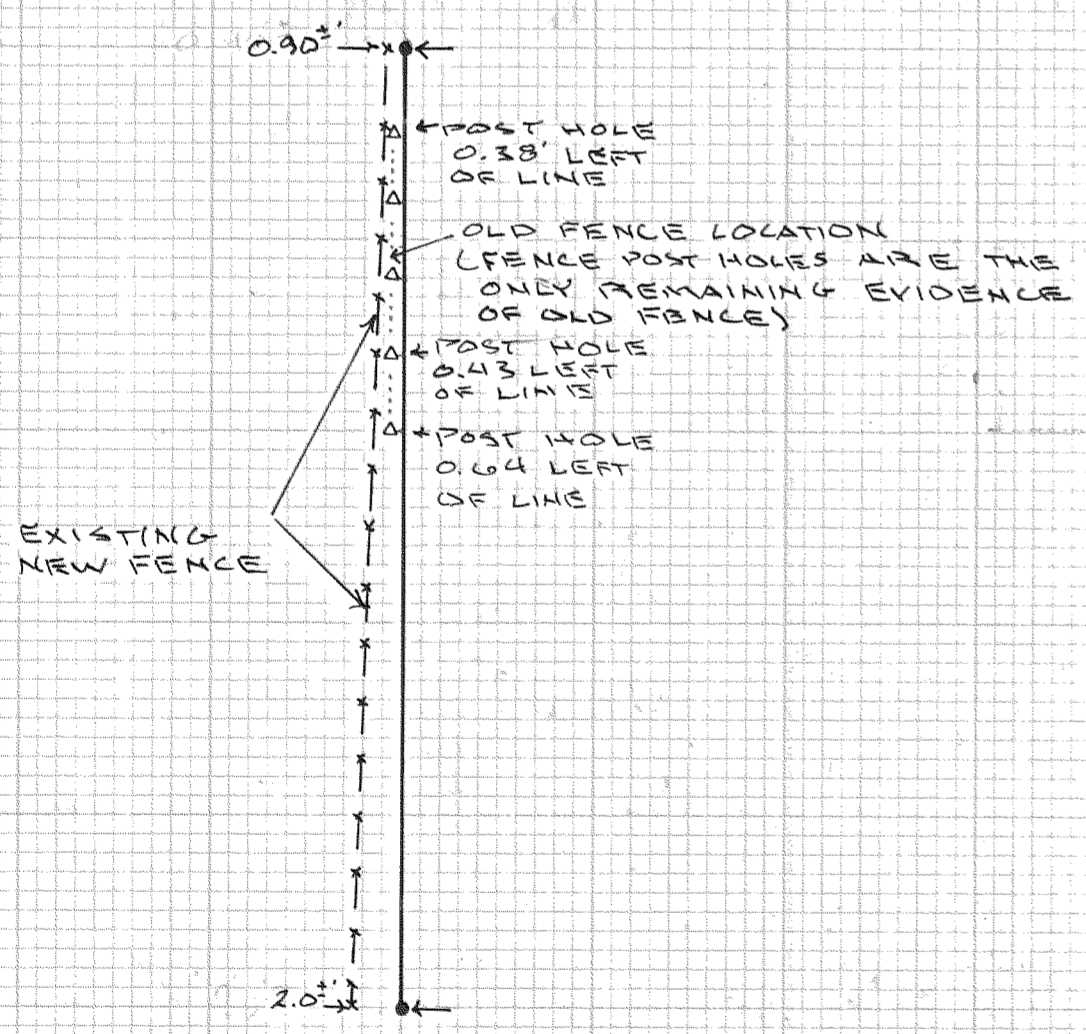

WEST LINE 5TH STREET

4TH STREET

N O - 4 - 1 - 1 E

N O - 5 - 0 - 4 - 0 E @ 300.00

329 STREET

330.00 (PLAT)

N O - 5 - 4 - 1 - 3 E

N O - 5 - 4 - 1 - 3 E

CENTER 1/4 USED CITY COORDINATES

987.28' NORTH LINE COE D.L.C. STREET

MAY 589-34-07 E

390.25'

270.68' (PLAT 270')

134.60'

136.08'

LOT 2

LOT 1

FOUND 1/2" I.P. 1.45' WEST OF LINE

FOUND ANGLE IRON N 67.51-28W @ 0.24'

FOUND 1/2" I.P. N 89.30-38W @ 1.15'

FOUND 1/2" IRON PIPE

589-30-38 E

LOT 3

40' SEE SKETCH

(PLAT 135') 154.36'

589-34-07 E (PLAT 135')

JUNE STREET

BASIS OF BEARING: CITY DATUM

FILED

JUL 12 1985

Richard J. ...
COUNTY SURVEYOR
DEPUTY

SURVEY LOCATION
LOT 4, BLOCK 1, PARKHURST
N.W. 1/4, SECTION 36,
T. 3 N., R. 10 E., W.M.

LEGEND

- SET 5/8" X 30" IRON ROD
- FOUND MONUMENT OF RECORD
- CALCULATED, NOT SET
- △ POST HOLE (SKETCH)

SURVEY FOR
MRS. SHIZHE EDMUNDSON
HOOD RIVER, OR.

REGISTERED PROFESSIONAL LAND SURVEYOR
Roy O. Gaylord
OREGON JULY 13, 1979
ROY O. GAYLORD
F.T.B.

TERRA SURVEYING
DATE: 5/85
SCALE: 1"=40'
PROJECT NO 8522
P.O. BOX 617
HOOD RIVER, OR. 97031
386-4531

85046