

**NARRATIVE**  
 T 15, R 10E, W.M. was subdivided in 1884 by Newton Clark.  
 On Sept 17, 1984 the USDA Forest Service contracted the survey of several of their holdings within the Hood River Ranger District. This particular survey is of Area # 3 of said contracted survey. All field angles were turned with a Wild T-1. All distances were measured with a HPR 3805A. Minimum position closure required was 1:15000. Field notes are contained in D.L.C. Field Book 85-3.

**CERTIFICATION**

I, Danny L. Cron, a registered Land Surveyor in the State of Oregon hereby certify that this plat & the notes hereon, or attached, are a correct representation of a survey I performed during 1984 & 1985 for the USDA Forest Service in accordance with the statutes of the State of Oregon and with the articles of my contract: Said contract being "Surveyors Ridge Cabestral", contract No. 03-0461-4-009315.  
 Danny L. Cron

Danny L. Cron - Registered Land Surveyor - Oregon License #1028

**POSTING & MONUMENTATION**

**1) POSTING** - Lines shown as "USDA Forest Service Line Posted" are marked by 6' long orange fiberless posts marked with 4151FS tags. Said posts are set a maximum interval of 150' & 50' as sign 64-2. Said posts are set a maximum interval of 150' & 50' as to be undesirable if the ground were cleared. All trees 6" or greater in diameter within 3' of line were blazed; 4151FS trees double blazed & private trees single blazed.

**2) BEARING TREES** - Bearing trees set are blazed with a 5/16" scribed blaze placed as close to the ground as possible with a brass disc stamped "51028" nailed at the bottom of said 5/16" scribed blaze unless noted. All bearing trees set or found have the following:  
 a) A 4 1/2" x 5" BT tag attached to face @ eye height.  
 b) A 7' x 10" 4151FS tag warning against destroying attached to back @ eye height.  
 c) A 6" red band painted around tree above signs.

**3) CORNER MONUMENTATION** - Corner monuments set are 2 1/2" x 3" aluminum pipes with a stamped 3" aluminum cap affixed. Said 2 1/2" x 3" pipes are placed at the bottom & are set 2 1/2" in the ground unless noted. At all corner monuments, set or found, a 7' x 10" 4151FS tag warning against destroying attached to a orange fiberless post was set; in addition orange fiberless posts were set within 3' to 5' of corner on lines posted.

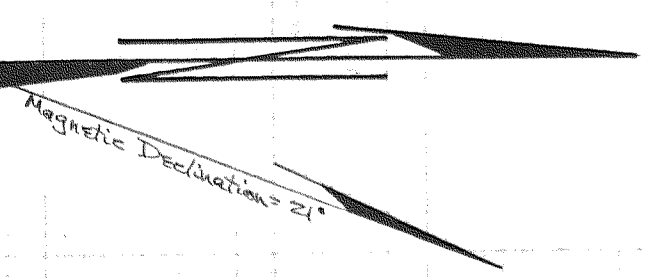

Scale = 1" = 1000'

USDA Forest Service Line Posted

**US SURVEY**  
 FOR USDA Forest Service LOCATION - Lines located in T 15, R 10E, W.M. HOOD RIVER COUNTY, OREGON

D.L.C. Surveying  
 Dan Cron  
 5004 Trent Creek Rd,  
 Portland, OR 97241

REGISTERED  
 PROFESSIONAL  
 LAND SURVEYOR

Danny L. Cron  
 OREGON  
 AUGUST 22, 1980  
 DANNY L. CROON  
 1028

July 11, 1985

**FILED**

JUL 12 1985

ROBERT ANDRUD  
 COUNTY CLERK

85034