

N.W. CORNER OF  
AMENDED CRAGMOUNT ADDITION

N.E. COR.  
BLK. 3 FD.

REF: TERBA  
SURVEY # 8206 4-12-82

AMENDED  
CRAGMOUNT  
ADDITION

MARKING

N.W. COR.  
BLK. 2  
RIVERVIEW  
ADD.  
FD.

RIVERVIEW  
ADDITION

SEE SHEET  
2 OF 2

NORTH

REGISTERED  
PROFESSIONAL  
LAND-SURVEYOR  
*Roy O. Gaylord*  
OREGON  
JULY 13, 1979  
ROY O. GAYLORD  
1 8 1 5

BASIS OF BEARING:  
TERBA SURVEY # 8206

FILED

MAY 1 1984

*Richard A. Arnold*  
COUNTY CLERK

SHEET 1 of 2

SHEET 1 of 2

TERBA SUBVEYING

DATE: 3/83  
PROJ. # 8418  
SCALE: 1"=60'  
P.O. BOX 617, HOOD RIVER  
OR. 386-4531

SURVEY FOR  
DEPARTMENT OF  
VETERANS AFFAIRS  
CASCADE LODGS, OR.

ACCOUNT # F 1748

84017

FOUND ORIGIN MON. @ N.E. COR. LOT 9 RIVERVIEW ADD. (SEE SHEET 1)

HOUSE & YARD IMPROVEMENTS APPEAR TO HAVE BEEN CONSTRUCTED AFTER 1975 SURVEY POSSESSION LINES COINCIDE WITH \*PIPE MONUMENT

NOTE:  
FOUND IRON PIPE (A) AS SET BY X PERSONS UNKNOWN FOR THE S.E. COR. LOT 7 RIVERVIEW ADDITION PERSON APPEARS TO HAVE TRANSPROSED PLAT DIST OF 289 TO 298' AND SET MON. ACCORDINGLY

TERRA SUBDIVIDING SET I.P. ON \*PIPE PROPOSED LINE @ CREST DRIVE WESTEALY B/W

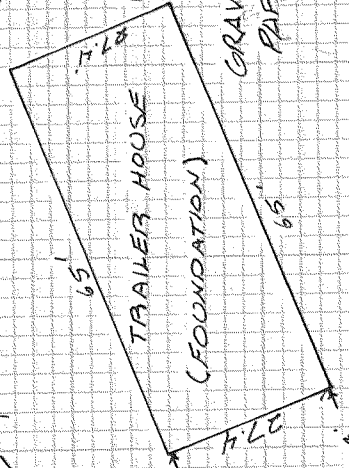
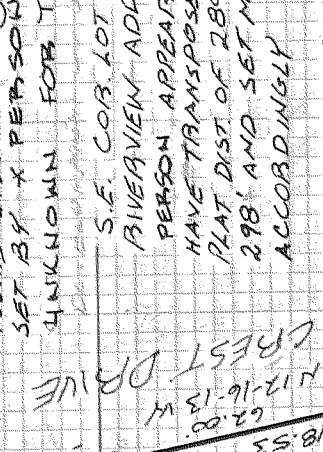

FOUND BISHOP IRON ROD 0.8' EAST OF LINE

NARRATIVE  
DASHED LOT LINES REPRESENT BOUNDARIES ACCORDING TO IRON PIPE (A) (SEE NOTE ABOVE)

OTHER MONUMENTS SET BY L.S. 932 IN THIS AREA THAT WERE TIED ARE ACCEPTABLE, \* THE \* BLINDERS PLACEMENT OF IRON PIPE (A) IS EXPLAINED ABOVE - REFERENCE TERRA SURVEY # B2006 - BISHOP SURVEY OF LOT 4, 7/29/81

\* REVISED THIS PAGE AFTER L.S. 932 FILED HIS 1975 SURVEY

REGISTERED PROFESSIONAL LAND SURVEYOR

*Roy O. Gaylor*

OREGON  
JULY 13, 1979  
ROY O. GAYLORD  
1-8-1-8

- LEGEND
- SET 5/8" x 30" IRON ROD
  - CALCULATED, NOT SET
  - FOUND MON. AS NOTED
  - FENCE

SUBDIVIDED SURVEY LOCATION  
THE N.E. 1/4 OF SECTION 12, T.24, B.7E. W.M.

MAY 11 1984

*Richard J. Arnold*  
COUNTY SURVEYOR

SHEET 2 OF 2

TERRA SURVEYING

DEPUTY

SURVEY FOR  
DEPARTMENT OF  
VETERANS AFFAIRS  
ACCOUNT # F17481

DATE: 3/83  
PLAT # 8418  
SCALE: 1"=230'  
PO-BOX-617, HOOD RIVER OR.  
(503) 386-4531



QUANT