

REGISTERED
PROFESSIONAL
LAND-SURVEYOR

Roy O. Gaylord

OREGON
JULY 19, 1978
ROY O. GAYLORD
1818

NARRATIVE

BASIS OF BEARING -
NEWTON SURVEY OF 1972
FILED #1338

SURVEY LOCATED IN
NE 1/4, SEC 4, T2N, R10E
HOOD RIVER COUNTY, OR.

- LEGEND
- SET 5/8"x30" IRON ROD WITH CAP
 - FOUND MONUMENT OF RECORD
 - CALCULATED, NOT SET

NOTES: USED NEWTON RODS
AS THEY WERE SET IN
1972 AND APPEARED
REASONABLY CORRECT -
MINOR DISTANCE DISCREPANCIES
ARE SHOWN ON THE
DRAWING.

FILLED

DEC 16 1983

Richard G. Arnold
COUNTY SURVEYOR

DEPUTY

MEA 159.69
NEWTON 324.00
MEASUREMENTS WITH
CAPS, NEWTON
160.00

PAUL HELTON
PROPERTY -
SURVEY FOR
IRON BETZ CONST.
HOOD RIVER, OR.

NOTE: ROAD & IS NOT
ALONG THE SECTION LINE
SEE NEWTON SURVEY -

TERRA SURVEYING
DATE: SEP 18, 1983
SCALE: 1" = 50'
PROJECT: 8344

RD. BOX 617, HOOD
RIVER, OR. 97031
386-4531 #83070

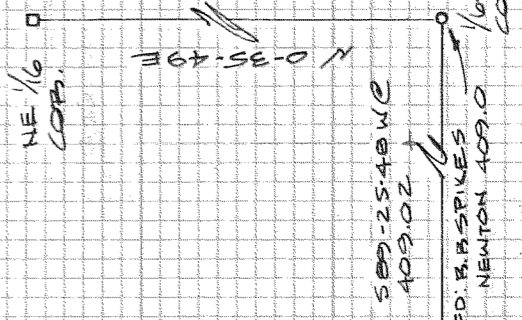
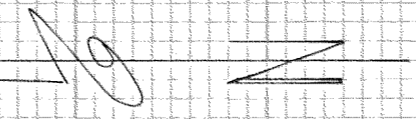

NEWTON 324.00, MEA 323.22
DEED 173.98, MEA 174.00
DEED 178.0, DEED 172.12
DEED 173.98, MEA 174.00
DEED 152.0