

Found - B.C.  
in Mon. Case  
N. 1/4 Cor. Sec. 10  
T. 2 N., R. 10 E.

(bearing of record)  
S. 89° 52' 33" E.  
1316.20

Calculated of  
N.E. Cor. of  
the N.W. 1/4 of  
the N.W. 1/4 of  
Sec. 10

1317.69  
N. 01° 22' 00" E.

Calculated  
S.E. Cor. of  
the N.W. 1/4 of  
the N.W. 1/4 of  
Sec. 10

**FILED**

JUN 22 1977

*Ronald J. Mery*  
COUNTY SURVEYOR

DEPUTY

66 SURVEY 2A

FOR - Brian Bellus

LOCATION - Parcel located

in the N.W. 1/4 of the

N.W. 1/4 of Sec. 10,

T. 2 N., R. 10 E., Co. M.

HOOD RIVER COUNTY, ORE.

Found - B.C.  
in Mon. Case  
N.W. Cor. Sec. 10  
T. 2 N., R. 10 E.

1316.20

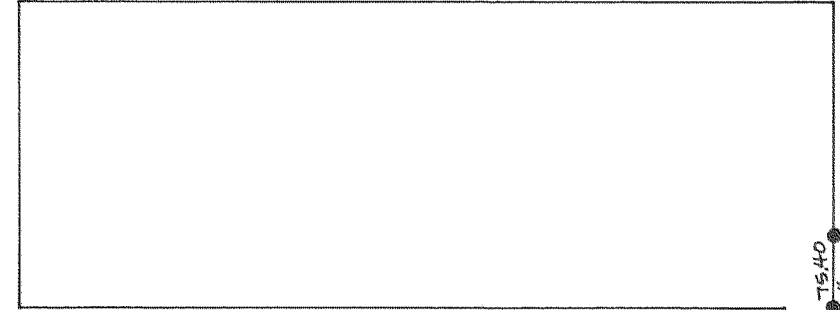

473.7  
S. 89° 58' 43" E.

473.7  
S. 89° 58' 43" E.  
792.62

330.00

N. 01° 33' 51" E.

1320.82  
S. 89° 58' 43" E.

Calculated of  
S.W. Cor. of  
the N.W. 1/4 of  
the N.W. 1/4 of  
Sec. 10

Found - B.C.  
in Mon. Case  
W. 1/4 Cor. - Sec 10



SCALE - 1" = 200'

• = 5/8" I.R. MONUMENT  
SET UNLESS NOTED

REGISTERED  
PROFESSIONAL  
LAND SURVEYOR

*Danny L. Cron*

OREGON  
AUGUST 22, 1975  
DANNY L. CRON  
1028

JUNE 8, 1977

NOTE - FOR SECTION Breakdown SEE County Survey records #77051  
7-076