

Fd-Brass Cap
SEE H.R.C. COR.
CARD # 530

T.15, R.10E., W.M.

#7628

N.E. COR.
of the S.W. 1/4
of the N.W. 1/4
of Sec. 20

FOUND-I.P.
SEE H.R.C. COR.
CARD # 675
S.W. cor. of
the S.W. 1/4 of the
N.W. 1/4 of the
N.W. 1/4 of SEC 20

H.R.C. COR.
CARD # 534
T.15, R.10E.

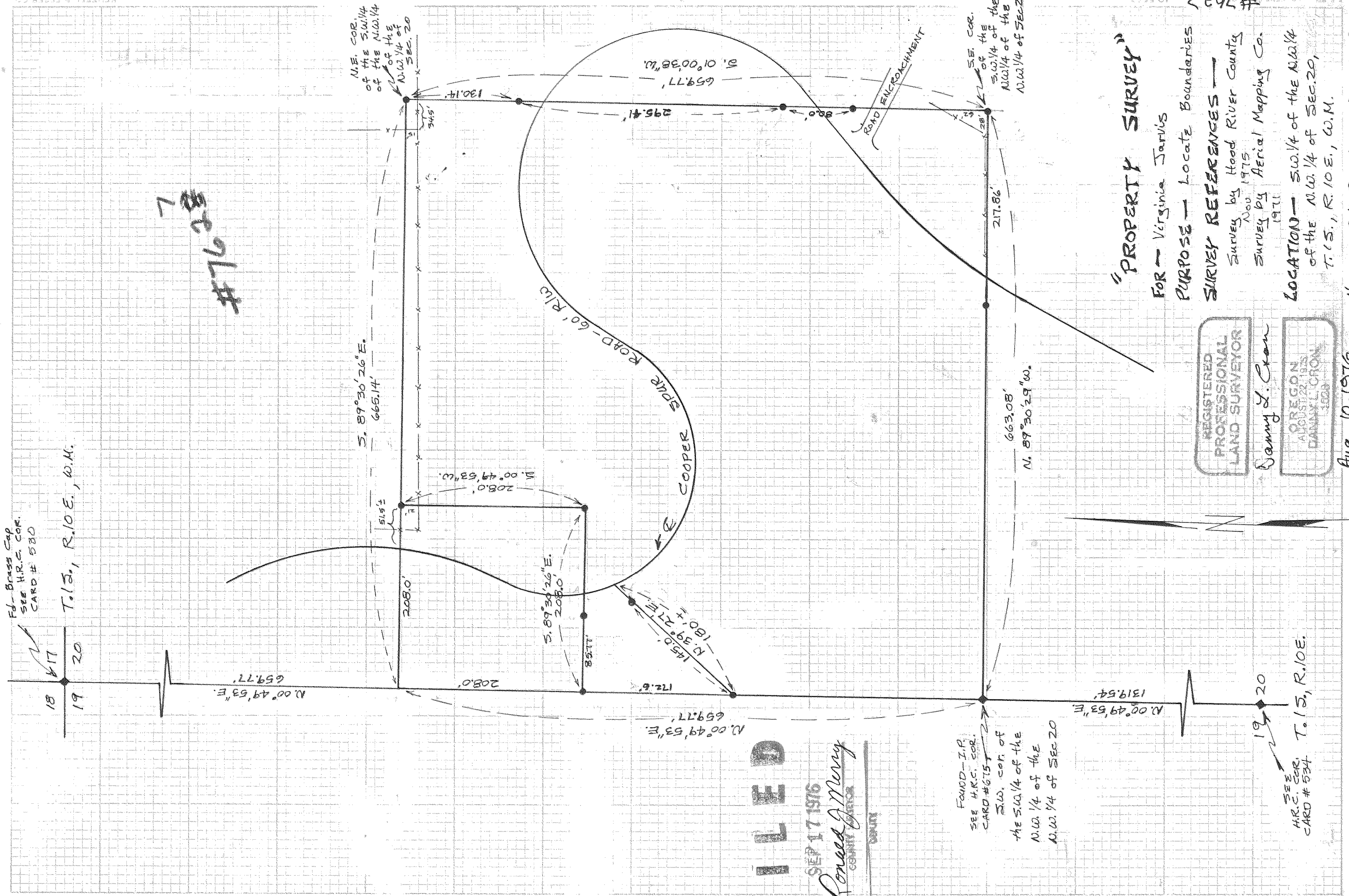

FILED

SEP 17 1976

Ronald J. Murray
COUNTY CLERK

BY COUNTY CLERK

"PROPERTY SURVEY"

FOR - Virginia Jarvis

PURPOSE - Locate Boundaries

SURVEY REFERENCES -

Survey by Hood River County Nov 1975

Survey by Aerial Mapping Co. 1971

LOCATION - S.W. 1/4 of the N.W. 1/4 of the N.W. 1/4 of SEC. 20, T.15., R.10E., W.M.

Aug. 10, 1976

HOOD RIVER COUNTY, ORE.

REGISTERED
PROFESSIONAL
LAND SURVEYOR

Danny L. Chan

OREGON
REGISTERED 1975
DANNY L. CHAN
3503

SCALE
1"=100'

● = 5/8" I.R. Monument set

◆ = Monument of record found

⊠ = Accepted

7627 6-022

7627

KEUFFEL & ESSER CO.
MADE IN U.S.A.