

Contour Interval = 5 feet

Contour Interval = 1 foot

File # 115-116 for NW 1/4 of Sec 3 or SW 1/4 of Sec 3

N 89° 53' 04" E 1323.97'

Parcel # 4

Parcel # 1

Parcel # 2

Parcel # 3

Parcel # 4

Parcel # 5

Parcel # 6

Parcel # 7

Parcel # 8

Parcel # 9

Parcel # 10

Parcel # 11

Parcel # 12

Parcel # 13

Parcel # 14

Parcel # 15

Parcel # 16

Parcel # 17

EXCEPTION: That part of the South half of the NE 1/4 of the SE 1/4 of Sec 3 which lies westerly of the center of Indian Creek

Notes:  
 1. Zoning: Under the jurisdiction of the County of Hood River, Oregon, Ordinance No. 2, Aug 1966, City of Hood River, Oregon, Ordinance No. 1, Aug 1966, and Ordinance No. 2, Aug 1966, Conditional use hearing for school use is required.  
 2. Elevation: One foot taken from City of Hood River, Oregon, U.S.C. & G.S. sea level datum.  
 3. Elevation: One foot taken from City of Hood River, Oregon, U.S.C. & G.S. sea level datum. Add 500 feet to show elevations for topography except where elevation is 600 or greater.  
 4. Utility: City of Hood River and former Irrigation District, City of Hood River water pressure, 50 P.S.I.  
 5. Soil: Sandy loam with no rock in evidence.  
 6. Gas: None in immediate vicinity.  
 7. Sewer: None. City proposed for sewer down Indian Creek. (See vicinity map)  
 8. Power: All power furnished by P.P. & L. Co.  
 9. Telephone: By United Telephone Co. of the Northwest

FILED  
 Date: 11/23/92  
 By: [Signature]  
 #7262

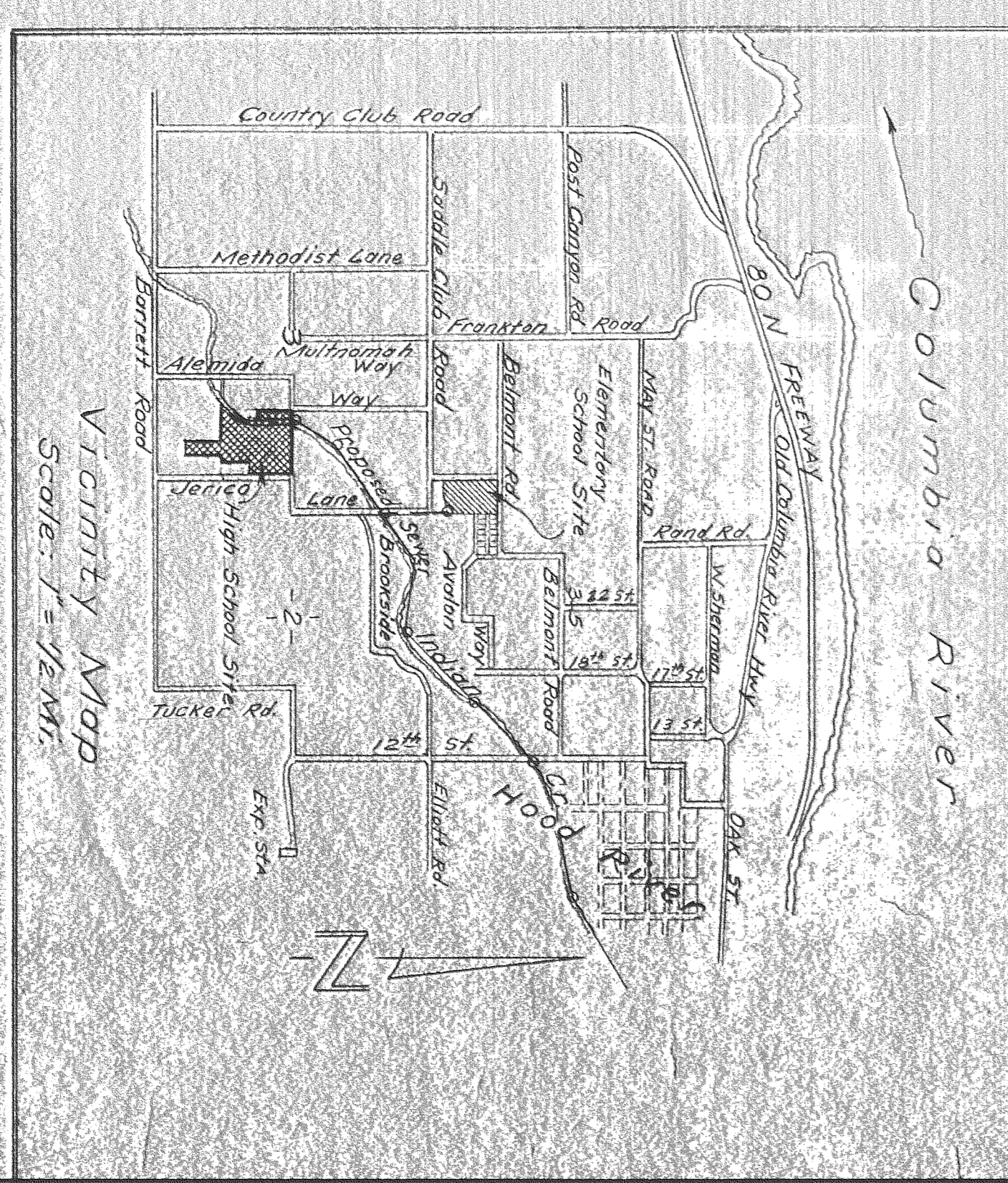

COLUMBIA RIVER

60' N. FRET WALK AND COLUMBIA RIVER BRIDGE

Methodist Lane

Country Club Road

Hood River High School Site

1/2" = 1/2 MILE

Scale: 1/2" = 1/2 MILE

Methodist Lane

Country Club Road

Hood River High School Site

1/2" = 1/2 MILE

#7262

#7262