

# Map of HOOD RIVER PARK

Scale 1 Inch = 200 Feet

Filed For Record Dec. 23<sup>d</sup> 1891  
at 8 A.M.

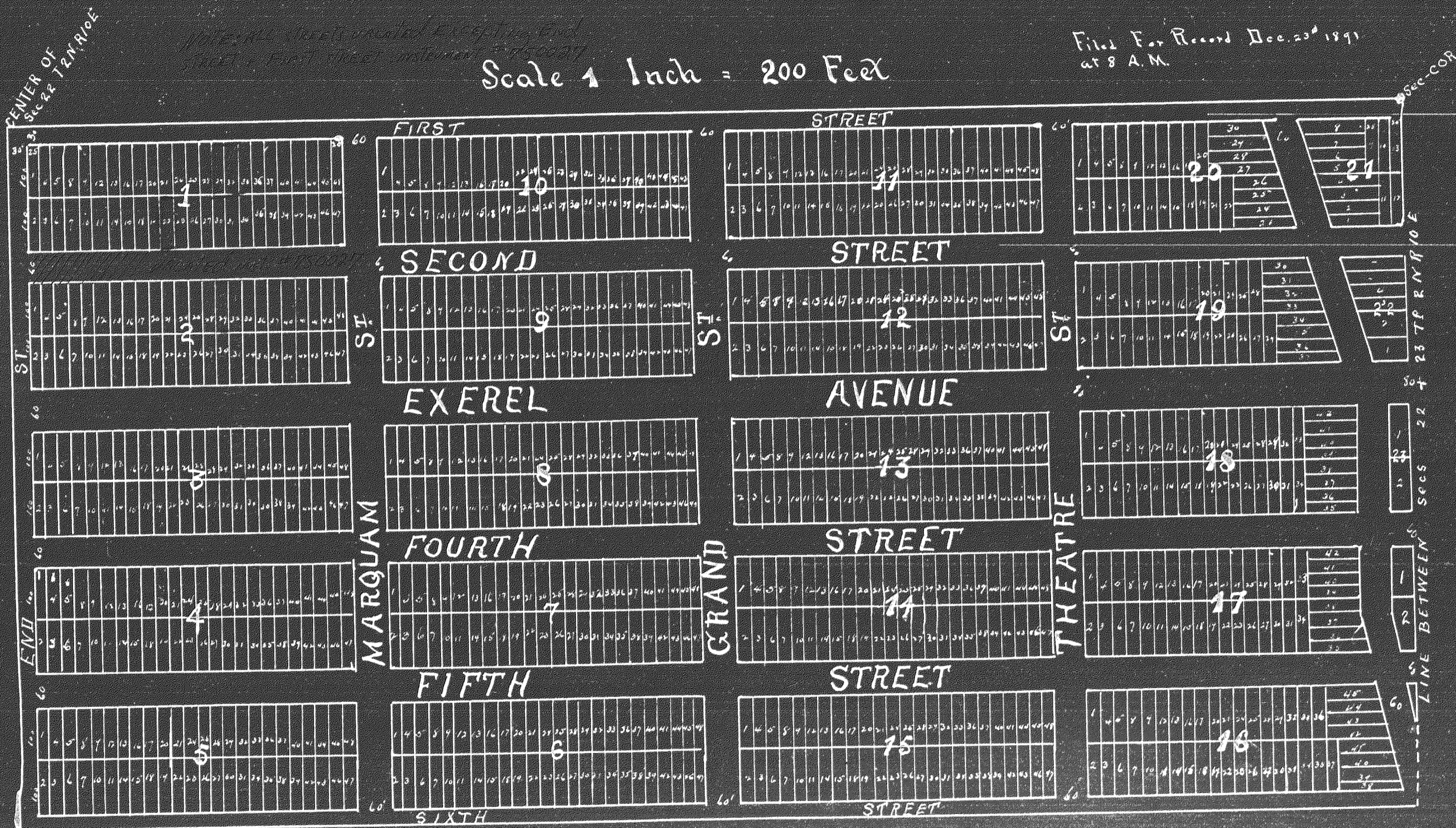

Transcribed from Hood Records Book 5 page 247.

Acknowledgment to Map of Hood River Park Filed Dec. 22d, 1891. 8 A.M.

Know all men by these presents, That I, Bruce L. Carr, an unmarried man, of the city of Portland Multnomah County, State of Oregon, do hereby declare the accompanying map to be the true map of Hood River Park, the same being the north half of the southeast quarter of section 22, in township 2 north range 10 east Willamette Meridian, Oregon, and I do hereby dedicate to the use of the public as roads, streets, avenues and public highways all such portions thereof as are shown and designated as such thereon. In Witness whereof, I hereunto set my hand and seal this 21st day of December, A.D. 1891.

Signed and sealed in presence of;  
H.D. Graden, I. Goldsmith.  
State of Oregon, )  
County of Multnomah, ) SS

This certifies, that on this 21st day of December, A.D. 1891, before me, the undersigned, a Notary Public in and for said County and State, personally appeared the within named Bruce L. Carr, an unmarried man, known to me to be the identical person described in and who executed the within instrument, and acknowledged to me that he executed the same.

In Testimony whereof, I have hereunto set my hand and Notarial seal the day and year last above written.

H.D. Graden,  
Notary Public in and for the State of Oregon.

seal

seal