

SURVEY IN NE 1/4 SE 1/4, SECT. 27, TWP. 2-N, RANGE 10, EAST W. M.

FOR Harry Rose

DATE Jan. 11, 1954

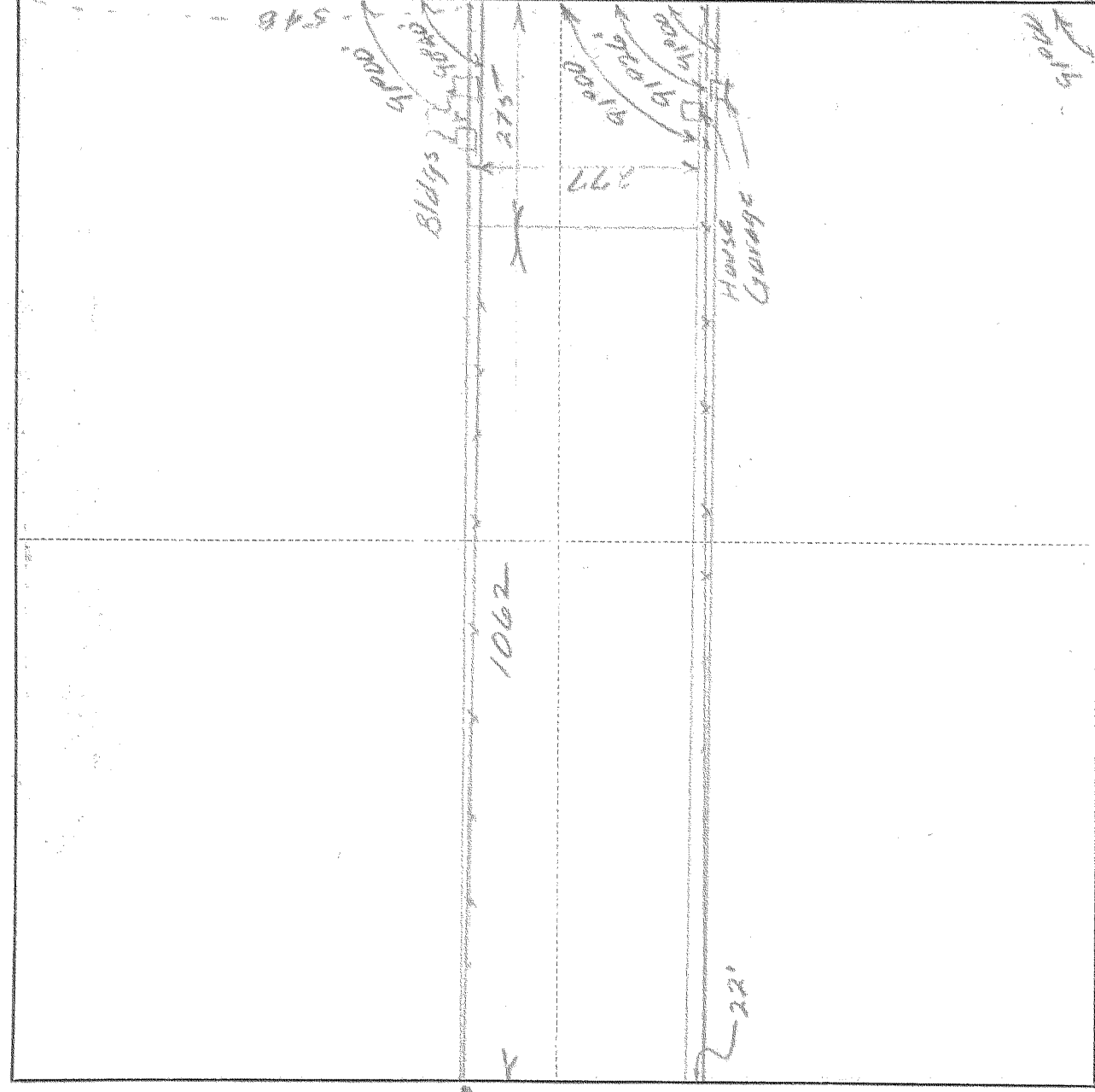

Scale 1 inch =

I do hereby certify that this sketch was made from notes taken during an actual survey by me on Jan. 11 + 12 19 54, and that it correctly represents the field work of said survey.

*Mark C. Robinson*  
County Surveyor  
Hood River County, Oregon

Helpers \_\_\_\_\_

PLUM 10297

1445 7-488

Jan. 11, 1954

FROM \_\_\_\_\_ TO- Harry Rose

Beginning at the S.E. corner of the N.E. 1/4 of the S.E. 1/4 of Sec. 27, T-2-N., R-10-E., W.M. Thence North along Section line a distance of 485 ft., Thence S. 89°00'W., a distance of 275 ft., to the point of true beginning of the property herein described, Thence S. 89°00'W., a distance of 1062 ft., to the West line of said N.E. 1/4 of the S.E. 1/4, Thence North along said subdivisional line a distance of 294 ft., Thence N. 89°20'E., a distance of 1062 ft., Thence South a distance of 287.6 ft. to the point of beginning. Containing 7.10 Acres.

*Mark C. Robinson*

*Harry Rose*