

FD SPIKE
660'

TUCKER RD.

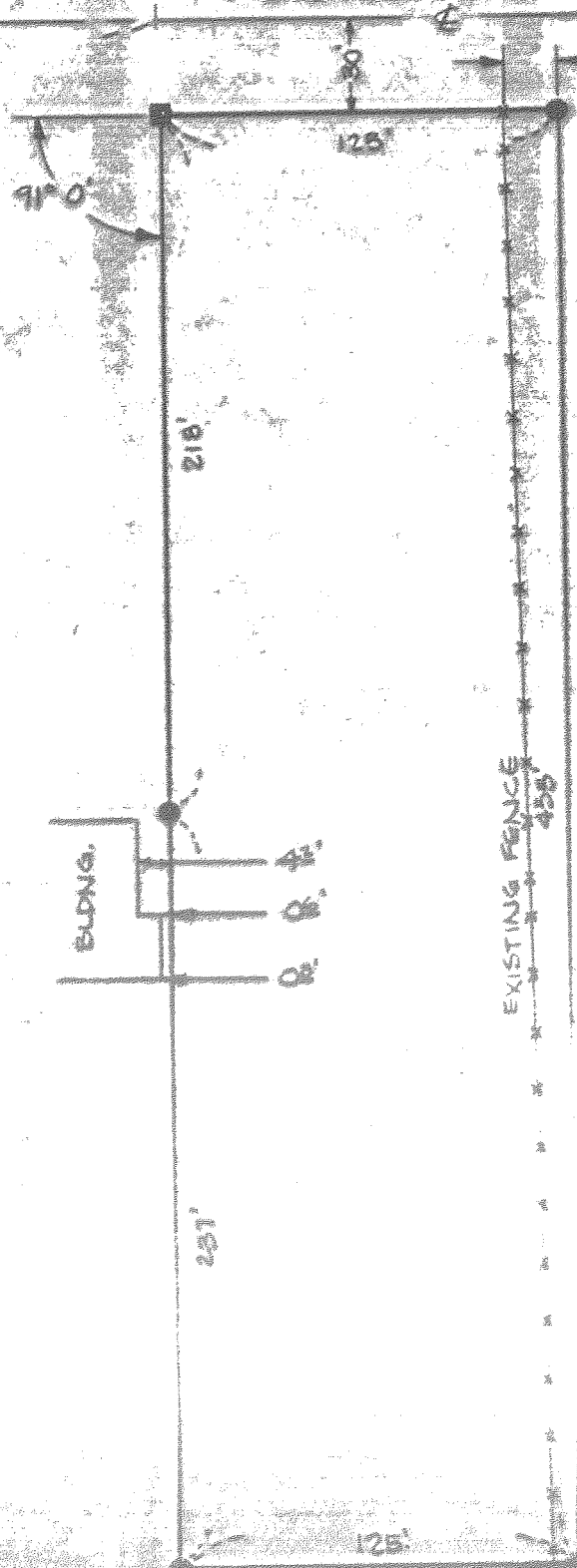

■ = FD 3/4" IR
● = SET 3/4" IR

A PARCEL OF LAND IN
NE 1/4 SEC 11
T2N R10E W1M

FILED

AUG 7 2 1971

Carole Van Elberg
COUNTY SURVEYOR

By _____
DEPUTY

20

REGISTERED
OREGON
LAND SURVEYOR

Anthony C. Klein
JULY 17 1970
ANTHONY C. KLEIN
932

SURVEY FOR:
HARRY CHAMBERS

DIELSCHNEIDER ASSOC INC
HOOD RIVER, OREGON
SURVEY ACK DATE: 7-30-71
DRAWN: JMM DATE: 8-4-71
SCALE: 1"=60' DRAWG: 71249

386 7-119

Engineering

Surveying

Data Processing

Dielschneider Associates Inc

No. 8 Fourth St. Hood River, Oregon 97031

Phones: Hood River 503/386-2912, The Dalles 503/296-3721

CS 1386

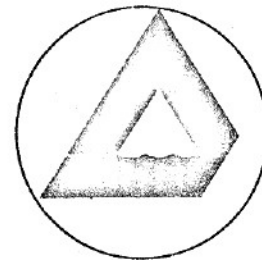

17 August 1971

FIELD NOTES:

FOR: Harry Chambers, Project No. 71249, survey of a parcel of land in the Northeast $\frac{1}{2}$, Section 11, Township 2 North, Range 10 East, Willamette Meridian.

CREW: Anthony C. Klein - Party Chief
James P. Robinson - Instrumentman
Don Robinson - Chainman

DATE COMPLETED: August 4, 1971

Our firm was requested by Mr. Chambers to establish the four (4) corners of a parcel of land in the Northeast $\frac{1}{2}$, Section 11, Township 2 North, Range 10 East, Willamette Meridian.

The initial point was a $\frac{3}{4}$ inch iron pipe found at the Northwest corner of said parcel and the remaining corners were established by chaining and turning the deeded description angles from a thirty (30) foot offset line South of the center line of Tucker Road, being the North section line of section 11.

All corners found and established during the course of this survey together with measured angles and distances are shown on the attached map, which by reference is a part hereof.



Anthony C. Klein

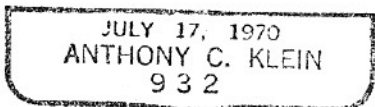

Signed *Anthony C. Klein*
Anthony C. Klein
Oregon Registered Land Surveyor
Number 932

FILED

AUG 7 2 1971

Carol Van Esberg
COUNTY SURVEYOR
By _____
DEPUTY