

Set I.R. & 3 B.Ts.
R.P.s are Nails in
blazed trees.

1/4 Cor. Fd. I.R.
at fence cor.
Ref. Iron #3534
27 34
20.55 697.40
N. 52° 00' 00\"/>

Fd. I.R. 2' high
Forest Service tag on
16" Fir
N. 29° 56' W 22.50'
Set I.R.
R.P. Nail in 16" Fir
N. 54° 15' W. 20.70'

VICINITY MAP
Scale: 1" = 1000'

Govt Lot 3

Irrigation Canal

Hess Road
660' ROAD
S. 0° 47' 50" W

N.W. Cor. Govt Lot 3
Set I.R.
Fd. I.R. 1" x 1/2" 0.5" N
& 0.2" E

Set I.R.
R.P. X on rock

Set I.R.

S.W. Cor. Lot 3

I.R. in Conc.

B.P.A. Big Eddy - Troutdale Line.

Fd. T.E.C. Cross Cops

Ref: Boise Line Survey #4027

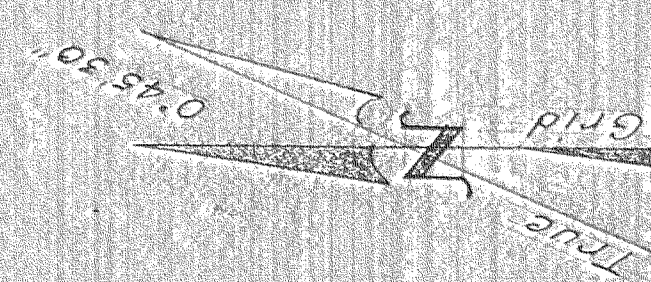

Ore Grid - North Zone
Factor 0.9997123

Note:
B.P.A. Grid bearings
& coord's used on this
survey.

& Mt. Hood Loop Highway

FILED

NOV 10 1970
Casper Van Osberg
COUNTY SURVEYOR
DEPUTY

REGISTERED
OREGON
LAND SURVEYOR

W. R. Fralby

SEPT. 2, 1958
VERL B. FRALLY
183

Date	No.	Revisions	By	App.
Survey For Jarrell J. Bell In Govt Lot 3, Section 34, Twp. 1 N., R. 10 E., W.M. Hood River County, Ore.				
Design	TENNESON ENGINEERING CORP. Consulting Engineers			Scale 1" = 100'
Survey	V.F.	412 West Second Place The Dalles, Oregon		Date 7-24-70
Drawn	V.F.	Checked [Signature]	Approved [Signature]	Work Order No. 4157
				Sheet 1 of 1

DRWG #1

August 17, 1970

FIELD NOTES

FOR: Jarrell J. Bell, Frontier Development Company
Hood River, Oregon W.O. #4157
Survey in Government Lot 3, Sec. 34, Twp. 1 N.; R. 10 E., W.M.

CREW: Verl R. Fraley, Registered Oregon Land Surveyor #183
Mike McAllister, Chainman
Butch Schmidt, Chainman

DATES PERFORMED: July 15, 16, 17, 20, 22, 24, 1970

WEATHER: Fair.

REFERENCE: TEC 18" x 24" Map W.O. #4157.

On June 26, 1970, our firm was retained by Jarrell J. Bell to survey a tract of land located in Government Lot 3, in the aforesaid Sec. 34. Mr. Bell furnished us with a map and description of the property which he wanted surveyed.

Before beginning the field work, an investigation was made in the County Surveyor's office and our office for records of previous surveys in the area. On a Bonneville Power Administration map, Big Eddy - Troutdale Line, Sheet #24, the Sec. corner 27-28-33-34 was tied in and coords shown. BPA also had found the N.E. corner and E. 1/4 corner of Sec. 34, with coords shown. On our survey for Louis Zeman W.O. #3534 and dated 1965, we show the N. 1/4 corner of Sec. 34 as being an I.R. found. On our survey of the Willamette Base Line, W.O. #4027, we show the S.W. corner and S. 1/4 corner of Sec. 34 as being found or set. Also, a brass cap was set for the N.W. corner of Sec. 4, T. 1 S., R. 10 E., on our Map No. 4027. We show coordinates for these corners which are based on the Oregon Coordinate System, North Zone Grid.

We started the field work by finding a hub at the center of Tower No. 5. A true line was established between Tower No. 5 and the 1st one to the West. BPA gave this line a bearing of S. $88^{\circ}19'27''$ W. (Grid). They showed a bearing of N. $0^{\circ}17'$ E. for the West line of Sec. 34. We traced this line and at 1900.45' from the power line, we found an I.R. in concrete which is the N.W. corner of Sec. 34. From this section corner, we ran a random line to the N. 1/4 corner of Sec. 34, which is an I.R. at a fence corner. A grid bearing of S. $83^{\circ}46'30''$ E and a true distance of 2777.60 ft. was calculated. At the N.W. corner of Government Lot 3, we set an I.R. which was only 0.5' South and 0.2' West of a found 1" axle.

Beginning again at BPA Tower #5, we ran a random line to the S.W. corner of Section 34 and the Section Cor. 4-5 on the Willamette base line. From this survey data, we were able to verify the accuracy of our work by comparing the coordinates. A slight difference will be noted due to different surveys and coordinate systems used. B.P.A. coordinates were used throughout to calculate and sub-divide the West half of Sec. 34, as shown on our Vicinity Map W.O. #4157.

Monuments found and set on the above survey are shown on the attached map, which by reference, is made a part of these notes.

SIGNED

Verl R. Fraley

Verl R. Fraley

Oregon Land Surveyor #183

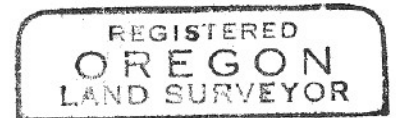

CHECKED AND APPROVED:

TENNESON ENGINEERING CORPORATION

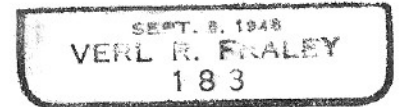

Donald J. Branton, President

VRF/rh