

PROPERTY DESCRIPTION  
for  
HINES LUMBER COMPANY  
Dee, Ore., on  
Hardboard Plant

A tract of Land located in the Northwest one-quarter (NW<sup>1</sup>/<sub>4</sub>) of Section 7, Township 1 North, Range 10 East of the Willamette Meridian, Hood River County, being more particularly described as follows:

Beginning at the centerline of the Easterly end of a Hood River County Bridge, said point being South 29° 23' 30" East 1481.00 feet from the Northwest corner of Section 7 in said Township and Range; thence along the extended centerline of said Bridge, North 83° 17' 30" East 172.33 feet; thence leaving said extended centerline South 16° 20' East 457.14 feet; thence South 1° 05' West 264.79 feet; thence North 88° 55' West 180.54 feet; thence South 1° 21' 48" East 252.18 feet; thence South 83° 37' West 70.11 feet; thence North 6° 23' 10" West 939.27 feet to the centerline of said Hood River Bridge; thence along said centerline North 83° 17' 30" East 54.38 feet to the point of beginning.

SUBJECT TO: The Northerly 30 feet of said tract which is Hood River County Road Right-of-way.

Contains . . . . . 4.857  
Less County Road Right-of-way . . . . . 0.157  
Net . . . . . 4.70 acres

Rev. 1	Revised Location Co. Road	VR	AA
Date	No.	Revisions	By App.
MAP OF HARDBOARD PLANT TRACT			
EDWARD HINES LUMBER CO. DEE, HOOD RIVER COUNTY, ORE. IN NW 1/4 SEC. 7, T. 1 N., R. 10 E.			
Design	TENNESON ENGINEERING CORP.		Scale 1"=100'
Survey	412 West Second Place The Dalles, Oregon		Date 5-23-66
Drawn	Checked	Approved	Work Order No. 3586 Sheet 1 of 2

**FILED**  
APR 29 1969  
County Surveyor  
Verl R. Fralby  
DEPUTY



CONSULTING  
*Engineers* TENNESON ENGINEERING CORPORATION

PHONE Cypres 6-9177  
412 WEST SECOND PLACE  
THE DALLES, ORE. 97058

June 1, 1966

FIELD NOTES

FOR: Hines Lumber Company - Work Order #3586-66 - Survey of Hardboard Plant Site in the Northwest one-quarter of Section 7, Township 1 North, Range 10 East of the Willamette Meridian, Hood River County, Oregon.

CREW: Verl R. Fraley, Party Chief and Registered Oregon Land Surveyor #183  
Rollo Solvester, Chainman  
Lowell Finn, Chainman

DATE PERFORMED: May 13-23, 1966

WEATHER: Fair

REFERENCE: 18" X 24" Map #3586-66 Hardboard Plant

On April 28, 1966, our firm was retained by the Edward Hines Lumber Company at Dee, Oregon to survey and mark with proper monuments their Plant Site together with the preparation of a legal description. They also required drafting a map showing building locations and facilities.

Before beginning the survey, we obtained a map from the Oregon Highway Department entitled, "North Unit, Dee - Parkdale Section, Hood River Highway, Drawing No. 5B-31-15". This map shows a tie from Station 32 + 88.2 P.I. to the Northwest corner of Lot 7, which is an iron bolt. On the Easterly right-of-way line, at Stations 31 + 46.7 P.C. and 34 + 28.8 P.T., we found iron rods and right-of-way posts. From these points, we re-established the centerline P.I. and then traversed to the Northeast corner of the Hardboard Plant Site survey. A distance and bearing was computed from the Northwest corner of Section 7 to a nail on the centerline of the East end of the bridge, which we used for the Point of Beginning of the legal description.

State Highway Bearings were used on this survey.

The attached 18" X 24 map, which is by reference made a part of these notes, shows the distances, bearings, and points established on this survey.

1  
IN-10-7

FIELD NOTES  
Edward Hines Lumber Company  
June 1, 1966

Page -2-

I certify that this work was done under my direct supervision.

Signed Verl R. Fraley  
Verl R. Fraley, Oregon Land Surveyor No. 183

CHECKED AND APPROVED:

TENNESON ENGINEERING CORPORATION

Donald J. Branton  
Donald J. Branton, President

DJB:kkk

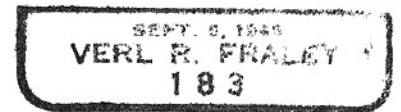
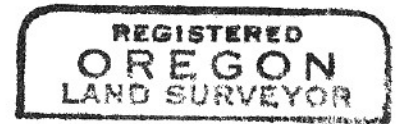

**FILED**

APR 29 1969

Charles Van Elsberg  
COUNTY SURVEYOR