

Clear Creek Road

Plat of land required for road easement and description of same
x SURVEYED IN NE 1/4, SW 1/4, SECT. 18, TWP. 1. South RANGE 10 EAST W. M.

FOR Hood River County DATE Sept. 21, 1943

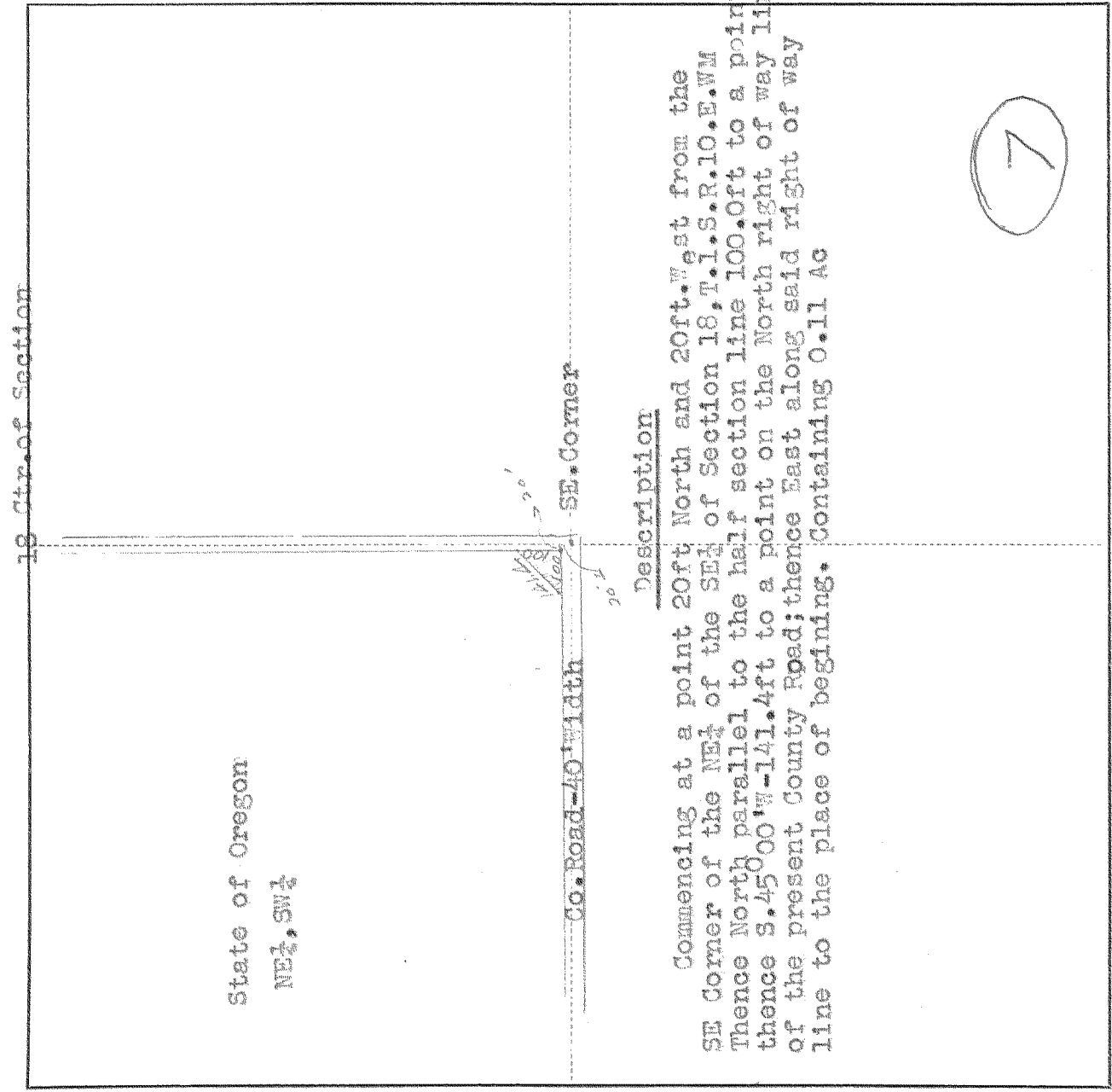

Description

Commencing at a point 20ft North and 20ft. West from the SE Corner of the NE 1/4 of the Section 18, T. 1. S. R. 10. E. W. M Thence North parallel to the half section line 100.0ft to a point; thence S. 45° 00' W - 141.4ft to a point on the North right of way line of the present County Road; thence East along said right of way line to the place of beginning. Containing 0.11 Ac

7

Scale 1 inch = 400ft

I do hereby certify that this sketch was made from notes taken during an actual survey by me on _____ 19_____, and that it correctly represents the field work of said survey.

County Surveyor
Hood River County, Oregon

Helpers _____

1227

KILHAM 10207

6-012