

October 28, 1969

FIELD NOTES:

FOR: W.O.#4105 - Brodehel Bldg., Hood River Village I, Rogers Construction Co,
c/o- Norman Glenn, 11760 N.E. Gleason, Portland, Oregon.

CREW: Verl R. Fraley, Reg. Oregon Land Surveyor #183
Garlan E. Brown, Chainman

DATE PERFORMED: October 24, 1969

WEATHER: Cloudy - Temperature 50°+

REFERENCE: 8 1/2" x 11" Tenneson Engineering Corporation Map #4105

On October 22, 1969, our firm was retained by Rogers Construction Co. to survey a tract and prepare a plot plan for the Brodehel Building at Hood River Village I in Section 30, Township 3 North, Range 11 East, Willamette Meridian, Hood River County, Oregon.

Mr. Norman Glenn of the Rogers Construction Co. sent us a sketch showing where he wanted the corners of the 50' x 50' tract set relative to the foundation of a new building under construction.

The following property corners and survey points were found prior to the laying out of the tract. A nail at the intersection of the Northerly projection of the Westerly line of the Standard Oil tract and the centerline of the Hood River Village Access Road. A tack on the westerly line of the Standard Oil tract which our company had previously surveyed in 1967. An exterior angle of 92° 03' was turned at the nail at the centerline of the Access Road. (The backsight was the found tack). The call distance of 379.02 feet was measured and a nail set. At this point an angle of 45° was turned and we found a hub and tack on line which we had previously set on the North shoulder Highway 80 N as a reference point. The centerline of the Truit Tree Building was established and the tract layed out according to directions from Mr. Glenn.

Bearings are true, taken from our survey of Hood River Village.

The attached map, W.O.#4105, which by reference is made a part of these notes, shows the distances, bearings and points found and established in this survey.

CHECKED AND APPROVED:
TENNESON ENGINEERING CORPORATION
Donald J. Branton, President

Signed: Verl R. Fraley
Verl R. Fraley,
Registered Oregon Land Surveyor #183

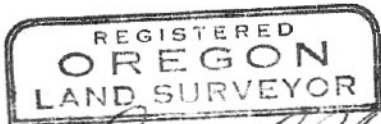

Donald J. Branton

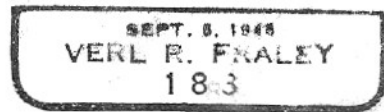
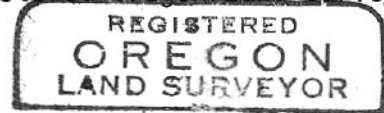
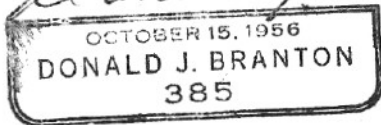

FILED

JAN 9 1970

Casper Van Ekberg
COUNTY SURVEYOR

DEPT.

Work Order #4105

October 24, 1969

PROPERTY DESCRIPTION

FOR

ROGERS CONSTRUCTION CO.

IN

HOOD RIVER VILLAGE

A tract of land in the N. Benson Donation Land Claim No. 37, Section 30, Township 3 North, Range 11 East of the Willamette Meridian, Hood River County, Oregon, more particularly described as follows:

Commencing at a point on the Northerly right-of-way line of the relocated Highway, U.S. 30 Freeway, said point being 626.22 feet North and 1340.08 feet East from the most Southerly Southwest corner of the N. Benson Donation Land Claim No. 40, Township 3 North, Range 10 East of the Willamette Meridian, Hood River County, Oregon; thence along said Oregon State Highway right-of-way line North 39° 00' West 40.00 feet; thence North 8° 57' East 149.43 feet to the centerline of the Hood River Village access road; thence along said centerline South 79° 00' East 379.02 feet; thence leaving said centerline South 34° 00' East 57.46 feet to the true point of beginning of this description; thence continueing South 34° 00' East 50.00 feet; thence at right angles South 56° 00' West 50.00 feet; thence at right angles North 34° 00' West 50.00 feet; thence at right angles North 56° 00' East 50.00 feet to the true point of beginning of this description.

Contains 2500 square feet.

FILED

JAN 9 1970

Carpe Van Elberg
COUNTY SURVEYOR

BERLIN

REGISTERED
OREGON
LAND SURVEYOR

Verl R. Fraley

SEPT. 8, 1948
VERL R. FRALEY
183

Verl R. Fraley,
Registered Oregon Land Surveyor #183