

#7

Country was property as described in deed records, Hood River County, Book 66, Page 654 and Book 67, Page 50c.

NOTE

Under this survey of March 26, 1969, it has been found that the north edge of the existing building is located on the north line of lots 1 and 23.

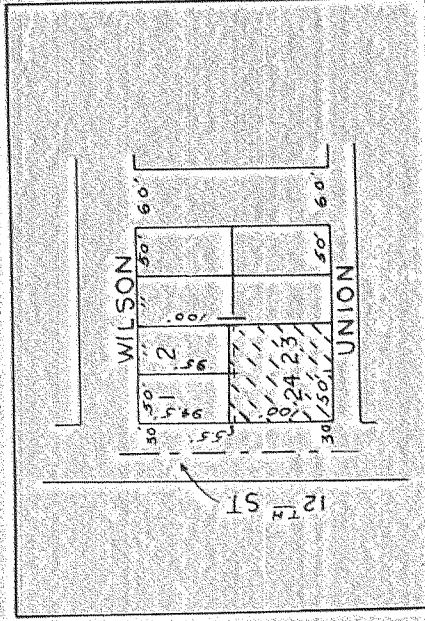

VICINITY MAP BLOCK 1
E.B. CLARK'S FIRST ADDITION

I, James S. Dielschneider, hereby certify that, except as shown on this plat, there are no easements, encroachments or other claims upon these surveyed premises.

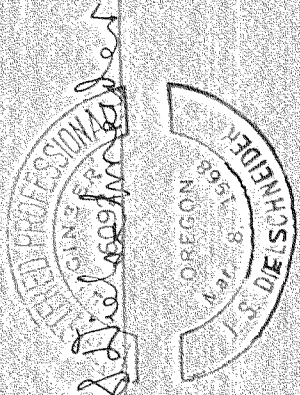

SW 1/4, SEC. 36, 3N10E of Dielschneider

FILED

MAR 27 1969

Carole Ann Clarke
COUNTY SURVEYOR

BY

DEPUTY

J.S. DIELSCHNEIDER & ASSOC. INC.
HOOD RIVER, ORE.
SURVEY JGM 8JSD MAR 26, 69
DRAWN WCB MAR 27, 1969
SCALE 1" = 20' DRWG. 6909

1190 8-674

CS1190

JAMES S. DIELSCHNEIDER & ASSOCIATES, INC.

Engineering & Planning

Hood River (503) 386-2912

606 State Street

January 20, 1970

Hood River, Oregon 97031

Mr. Carlos Van Elsberg, Director
Department of Public Works
Hood River County
P.O. Box 457
Hood River, Oregon 97031

FIELD NOTES:

Country Gas, Project #6909, survey in E. B. Clark's First Addition to the City of Hood River, Oregon, located in the SW $\frac{1}{4}$ of Sec. 36, T3N, R10E WM, Hood River County, Oregon.

CREW: J. S. Dielschneider, Party Chief
J. G. Mahoney, Instrumentman
W. C. Brown, Chainman

DATE PERFORMED: March 1969.

WEATHER: Fair

On March 8, 1969, our firm was retained by Chuck Wilson of Country Gas to do an ALTA survey to verify the location of their building.

We referred to Hood River County Map No. 3N 10 36C which shows the corners in the vicinity. We also referred to plats of previous surveys in the area, including: Plat of Survey Lots 1 and 24, Clark's First Addition, Hood River, Oregon, by Perkins, Nov. 12, 1952, and Plat Plan of Heights Mobile Service Station, Clark's First Addition, 1961, by Perkins.

CORNERS FOUND: NW Corner of the SW $\frac{1}{4}$, Sec. 36, T3N, R10E WM.

The location of the building was determined by measurements from the $\frac{1}{4}$ corner and the centerline of Belmont Street.

Monuments found and set, together with the measured distances and bearings used on this survey, are shown on the attached map, which is by reference made a part of these notes.

I certify that this work was done under my direct supervision.

FILED
1969
Carlos Van Elsberg
COUNTY CLERK

