

CHURCH PROPERTY

313.37'

60'

PUBLIC R/W

365.95'

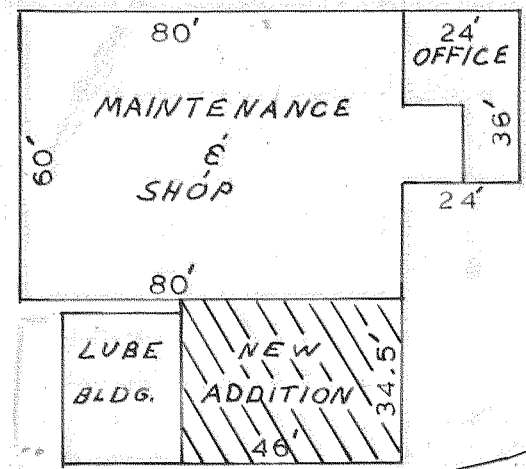

PUBLIC R/W

18 th STREET



HOOD RIVER COUNTY SURVEY OFFICE

PLOT PLAN FOR COUNTY SHOP AREA
North line to be amended - land exchange with LDS.
 IN

SEC. 35 T3N R10E WM

DATE: 15 JUNE 66	JOB NO. <u>15-66</u>
SCALE: 1 in = 40 ft.	FILE NO. _____
DRAWING: AMN	SHEET <u>1</u> OF <u>1</u>

1100
1100

8-372 15