



BEARINGS BASED ON PREVIOUS SURVEYS

ADAMS PARADISE LOT 1

OAK STREET

STREET

STREET

STATE ST.

SHERMAN AVENUE

AVENUE

ACRES

± 1.06 AC.

ORCHARD

1/2" IRON RODS AS PER T.E.C. SURVEY (W.O. 3728 10-17-67)

(RECORD: 201.87) 202.23

S. 01° 57' 09" W. 202.23

N. 81° 54' 00" W. 87.60

3/4" PIPE

N. 05° 09' 00" E. 42.00

1/2" PIPE

141.55

N. 83° 16' 00" W. 46.38

1" PIPE

N. 02° 07' 34" E. 132.62

S. 86° 39' 16" E. 27.00

1/2" I.R.

S. 03° 20' 44" W. 62.00

S. 86° 39' 16" E. 173.00

200.36
3/4" PIPE
1.53 N. AND
1.07 W. OF
TRUE POSITION

1" PIPE
5.39 N. AND
1.25 E. OF
TRUE POSITION
ALSO 5/8" I.R. IS
0.5 N. OF PIPE

150.0

POINT 488.5' E.
& 20.0' N. OF SW
COR. LOT 1 OF
ADAMS PARADISE ACRES

1/2" PIPE

99.74

S. 86° 39' 16" E.

1/2" PIPE
0.11 S. AND
0.26 W. OF
TRUE POSITION

NOTE :

- FOUND CORNER
- SET 5/8" IRON ROD

FILED

MAY 18 1971
Charles Van Elburg
COUNTY SURVEYOR

SECTION 26
T. 3 N., R. 10 E., W. M.

REGISTERED
OREGON
LAND SURVEYOR
Anthony C. Klein
JULY 17, 1970
ANTHONY C. KLEIN
932

SURVEY FOR CHARLES JACKSON
DESCRIPTIVE PARCEL IN LOT 2
ADAMS PARADISE ACRES
HOOD RIVER, OREGON

J. S. DIELSCHNEIDER & ASSOC. INC
HOOD RIVER, OREGON
SURVEY: T.K.:J.R. DATE: 5-7-71
DRWN: NAN DATE: 5-11-71
SCALE: 1"=50' DRWG: 71223

Engineering

Surveying

Data Processing

Dielschneider Associates Inc

No. 8 Fourth St. Hood River, Oregon 97031

Phones: Hood River 503/386-2912, The Dalles 503/296-3721

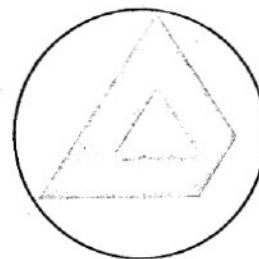

May 13, 1971

FIELD NOTES

FOR: Mr. Charles Jackson - Project No. 71223 - Survey of descriptive parcel situated in Lot 1 of Adams Paradise Acres, City of Hood River, Hood River County, Oregon.

SW 1/4 SEC. 26
3N10E

CREW: Anthony C. Klein
James Robinson

DATE COMPLETED: May 11, 1971

On April 30, 1971, our firm was requested by Mr. Charles Jackson, Hood River, Oregon, to survey a portion of his property located at 13th and State Streets and provide him with a legal description. We met with Mr. Jackson at the property and were instructed as to his intentions which were to establish sufficient new corners to delineate an existing orchard from his house, outbuildings and yard.

A field search of the area surrounding the orchard revealed many property corners which had been set during a series of metes and bounds land transactions surrounding the area. A transit traverse was run and all found corner monuments were tied in, including several outside the general project area for purposes of further verification of those corners nearby. As shown on the attached map of survey, nearly all found monuments fit the deed descriptions except in the Southwest corner of the surveyed property. The distance along the West property line was lengthened by 0.36 foot from deed call when the boundary line was projected Southerly to the intersection of a straight line between two found and accepted corner monuments.

Bearings used throughout this survey were extended from that as established by Tenneson Engineering Corp. (REF. W.O. 3728 10-17-67).

Mr. Charles Jackson Project 71225

All corners found and established in the course of this survey, together with measured distances and angles, are shown on the attached map which by reference is made a part hereof.

I certify that this work was done under my direct supervision.

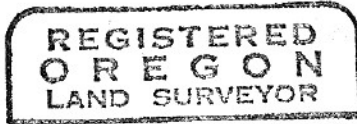

Norman A. Newton

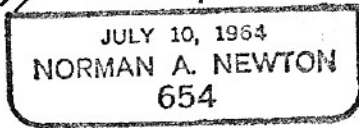

Signed

Norman A. Newton

Norman A. Newton
Registered Oregon Land Surveyor
No. 654

FILED

MAY 18 1971

Carlos Von Elsberg
COUNTY SURVEYOR

By

DEPUTY