

~ Hood River ~

Wasco County, Ore.

SEC. 25, T. 3 N. R. 10 E. W. M.

Scale: 100 ft = 1 in.

Chief Eng. Office, Portland, Ore.

June 1908 - D.E. 120-121 & 122-123.

See Blueprint

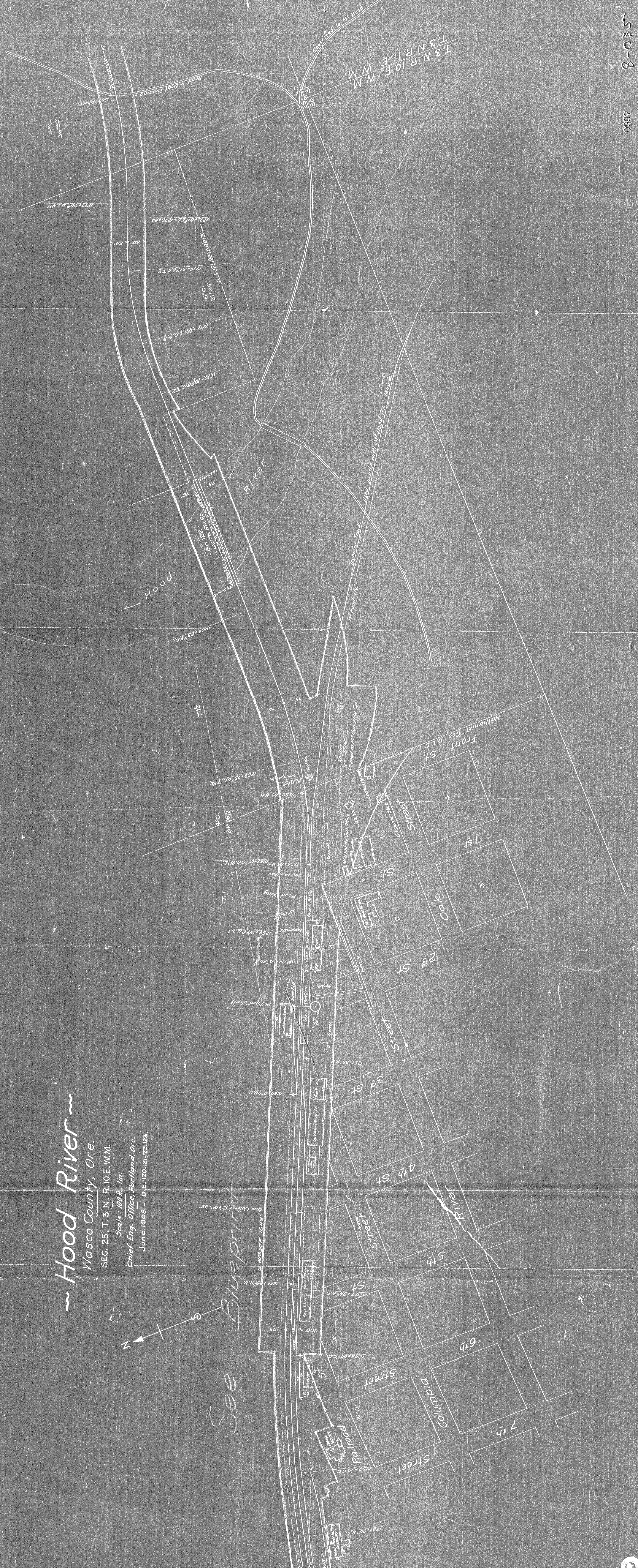

T. 3 N. R. 10 E. W. M.

530-8

2660