

SURVEY IN SE 4 SE 4, SECT. 34, TWP. 3N, RANGE 10, EAST W. M.

FOR Dale Nunnemaker

DATE Oct. 30, 1949

East 7 Rods Rd West 3 Rods 2 ft = 89 ft

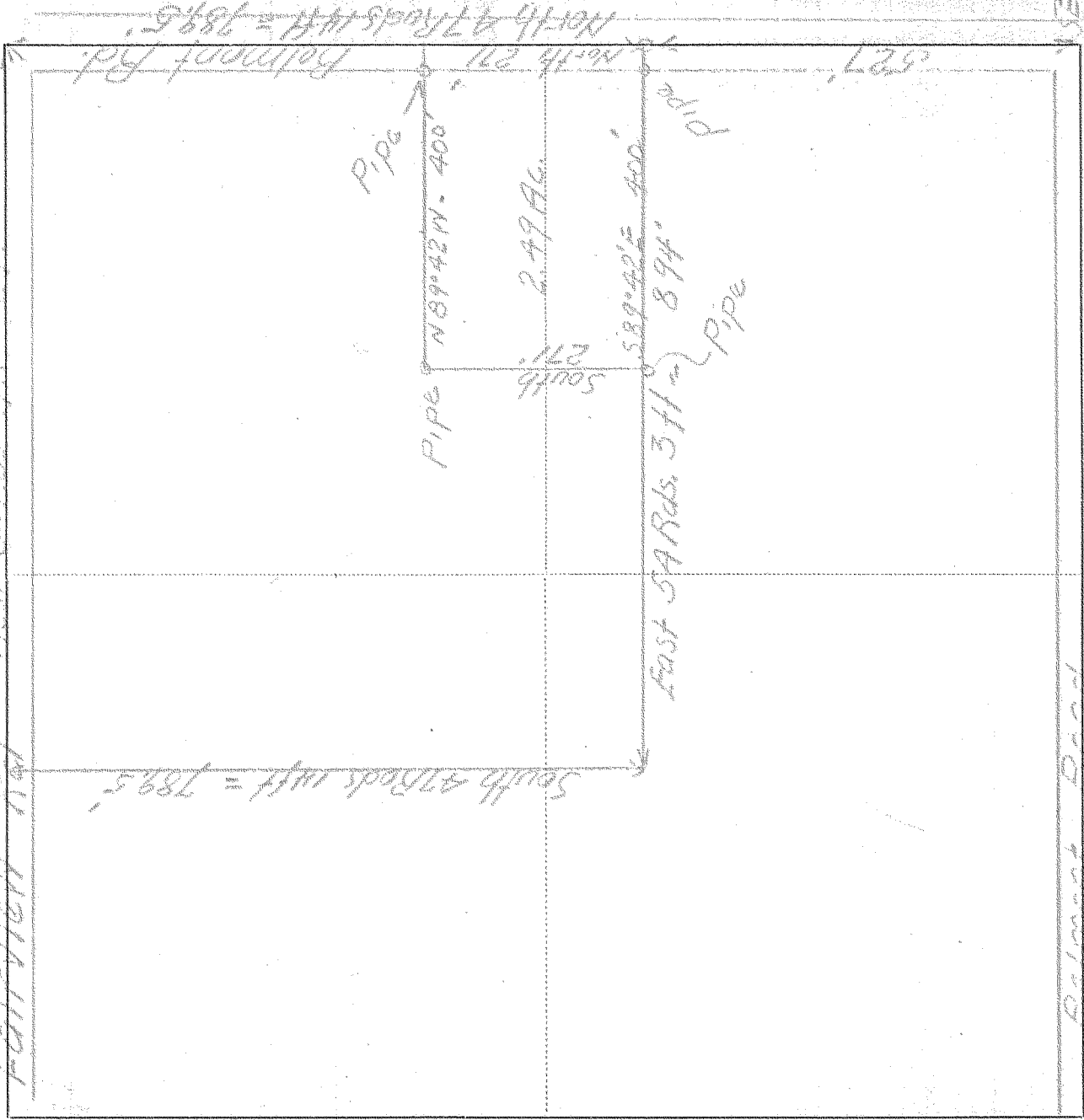

Scale 1 inch = 200 feet

I do hereby certify that this sketch was made from notes taken during an actual survey by me on Oct. 12, 1949, and that it correctly represents the field work of said survey.

Jedur Johnson

County Surveyor
Hood River County, Oregon

Helpers Dale Nunnemaker

0985

2-170