

Handwritten notes:
 1/2 Section 12
 1/2 Section 13
 1/2 Section 14

LEAVENS' HEIGHTS

Adjoining Cascade Tracts,

As laid out by H.A. Leavens,

And being a part of the N.W. 1/4 of the S.E. 1/4 of section 12, township 2 North,
 Range 7 east, Willamette Meridian.

Filed for Record Nov. 30, 1894.

center of Section 12

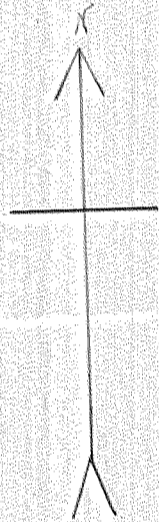
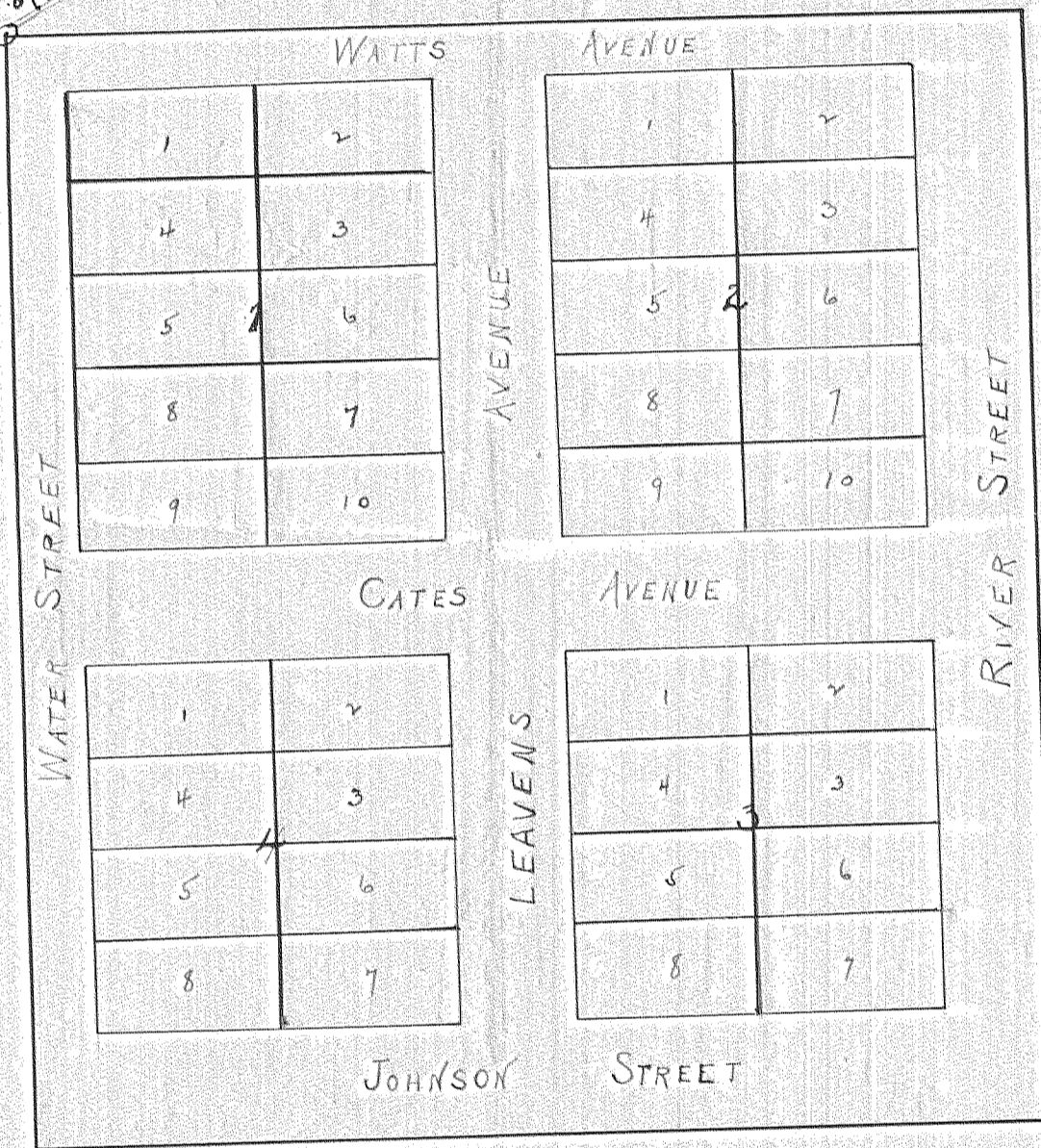

Scale 100 feet = 1 inch.

0868

A 2-420

Leavens Heights
Leavens Heights