

SURVEY IN SW 1/4 S 1/4, SECT 26, TWP 3 N, RANGE 10, EAST W. M.

FOR Harry House DATE July 5, 1949

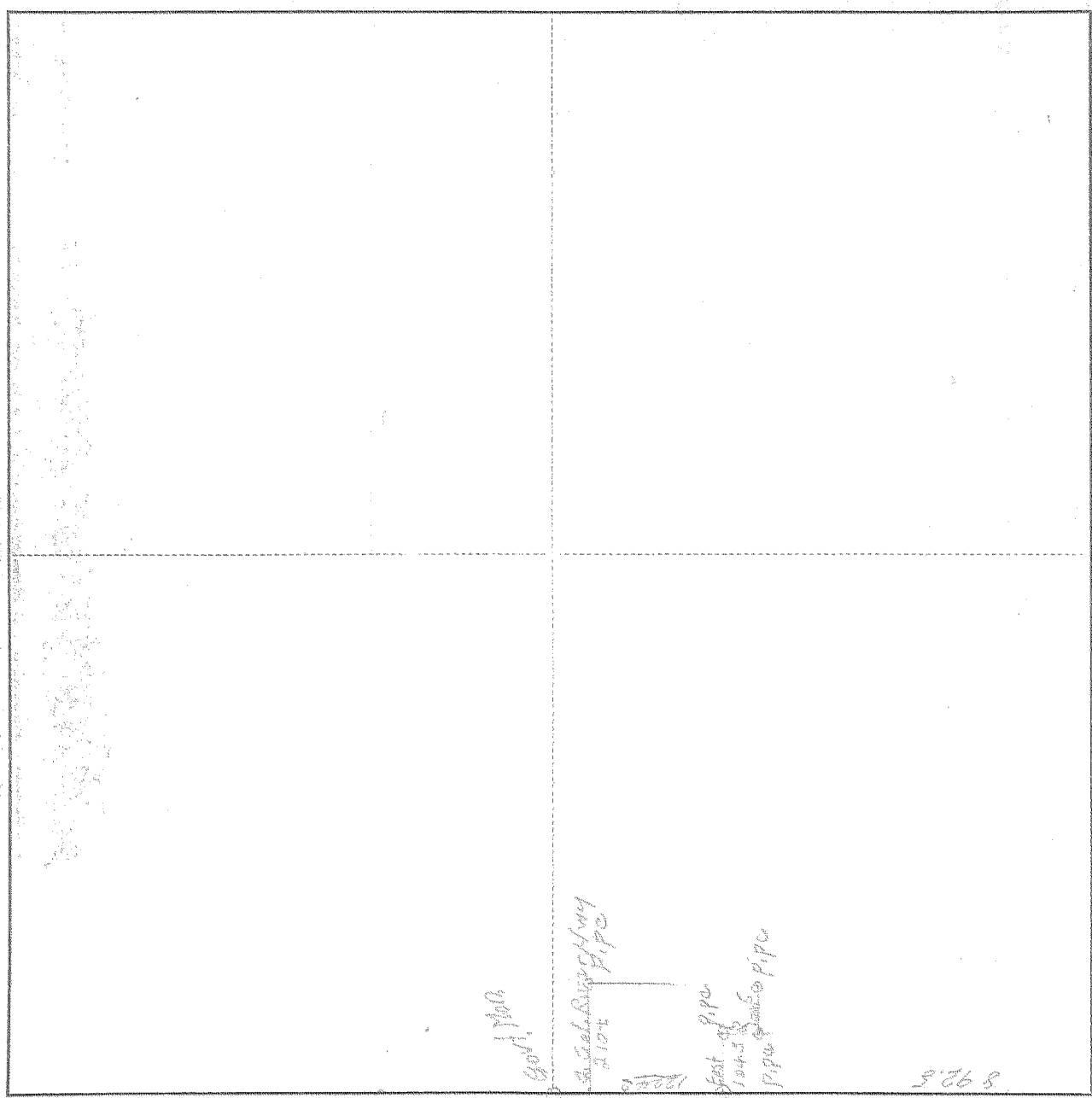

Scale 1 inch =

I do hereby certify that this sketch was made from notes taken during an actual survey by me on July 5 1949, and that it correctly represents the field work of said survey.

Edward Johnson
 County Surveyor
 Hood River County, Oregon

Helpers John Shipley