

SURVEYIN S.W. 1/4 SECT 7 TWP: 2 N RANGE 11 EAST W. M.

FOR A. Thibault

DATE

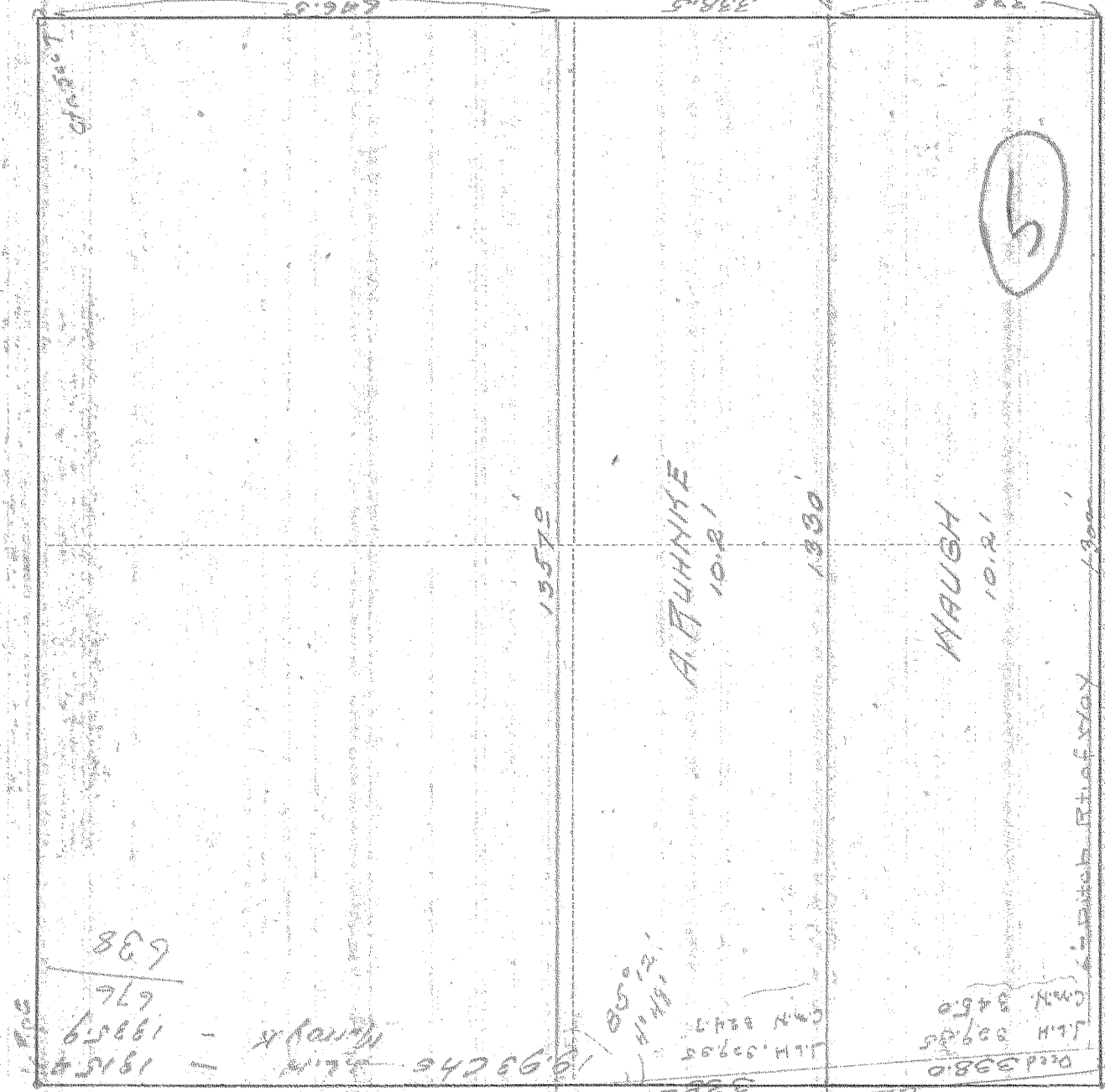

I do hereby certify that this sketch was made from notes taken during an actual survey made by me on \_\_\_\_\_ 192\_\_\_\_, and that it correctly represents field work of said survey.

County Surveyor  
Hood River County, Oregon

Helpers \_\_\_\_\_

#41-475-0630