

SURVEY IN S. 14.4, SECT. 35, TWP. R. 11, RANGE 10, EAST W. M.

FOR Mrs. Guy Mooney DATE July 10-11, 1950

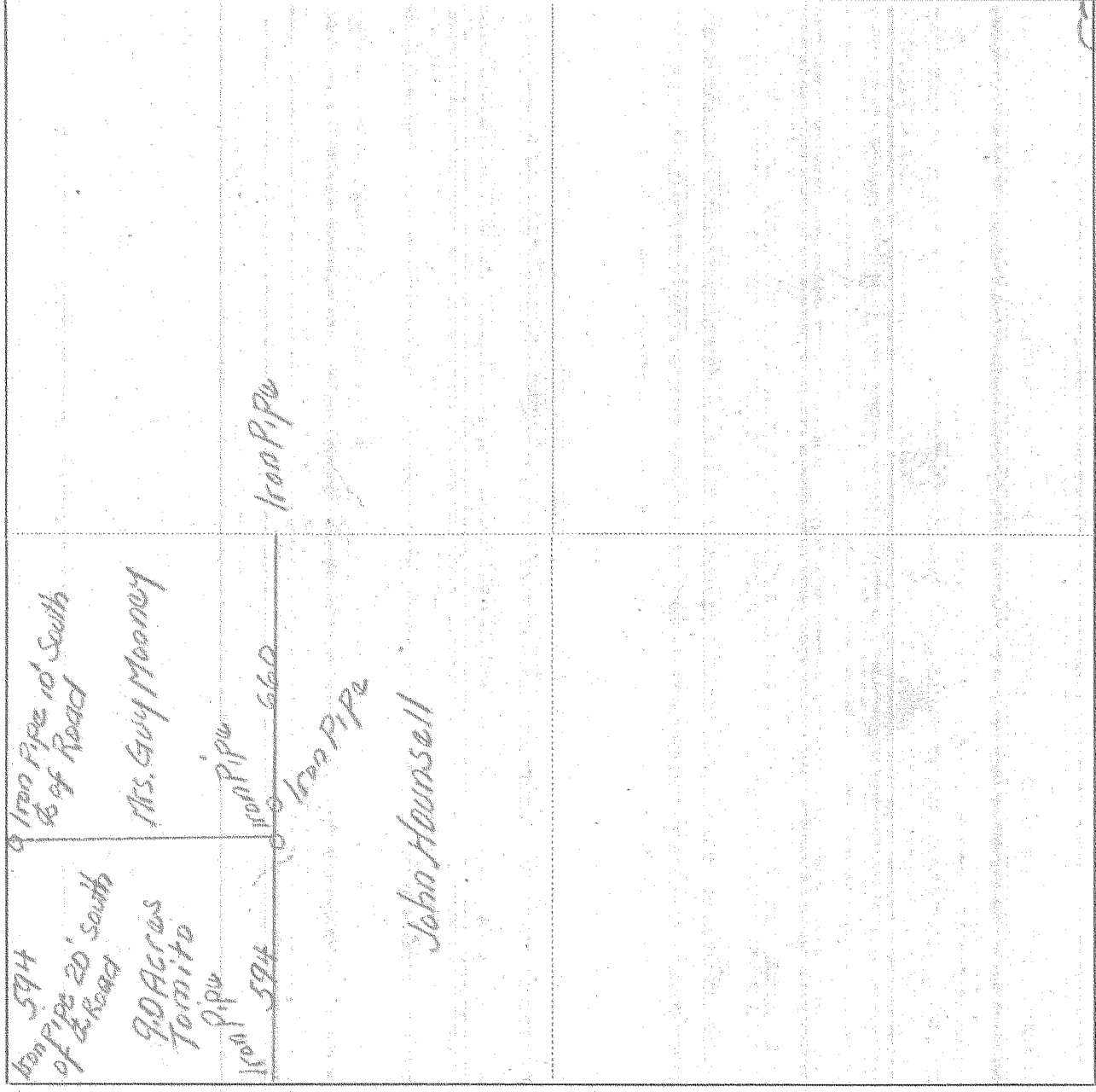

Scale 1 inch = 400 ft

7

I do hereby certify that this sketch was made from notes taken during an actual survey by me on July 10-11 1950, and that it correctly represents the field work of said survey.

Edw. Johnson
County Surveyor
Hood River County, Oregon

Helpers J. G. Chipley

0595

4-424