

HYDRO-ELECTRIC CO.

*Plot showing Hood River
Across a portion of the lands of the
BALTIMORE ORCHARD CO.
In sections 16 and 21 Twp. 2 N. - R. 10 E. - W. 11.
Hydro-Electric Co. water rights in red
Lands sought to be condemned in yellow.
Scale 1" = 100' - Hood River, Or. Feb. 24, 1913*

Murray Kauf Civil Engr.

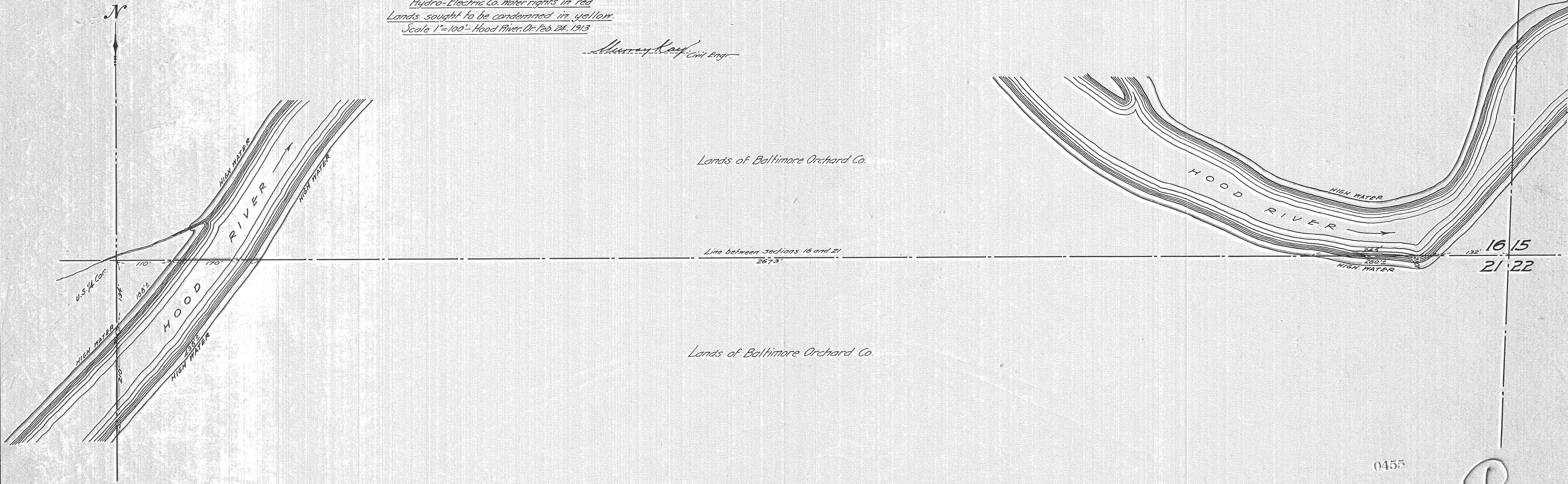

0455

#4-239

1