

SURVEY IN SE 1/4 of NE 1/4 SECTION 14 TWP 2 N RANGE 10 EAST W. M.

FOR _____ DATE _____

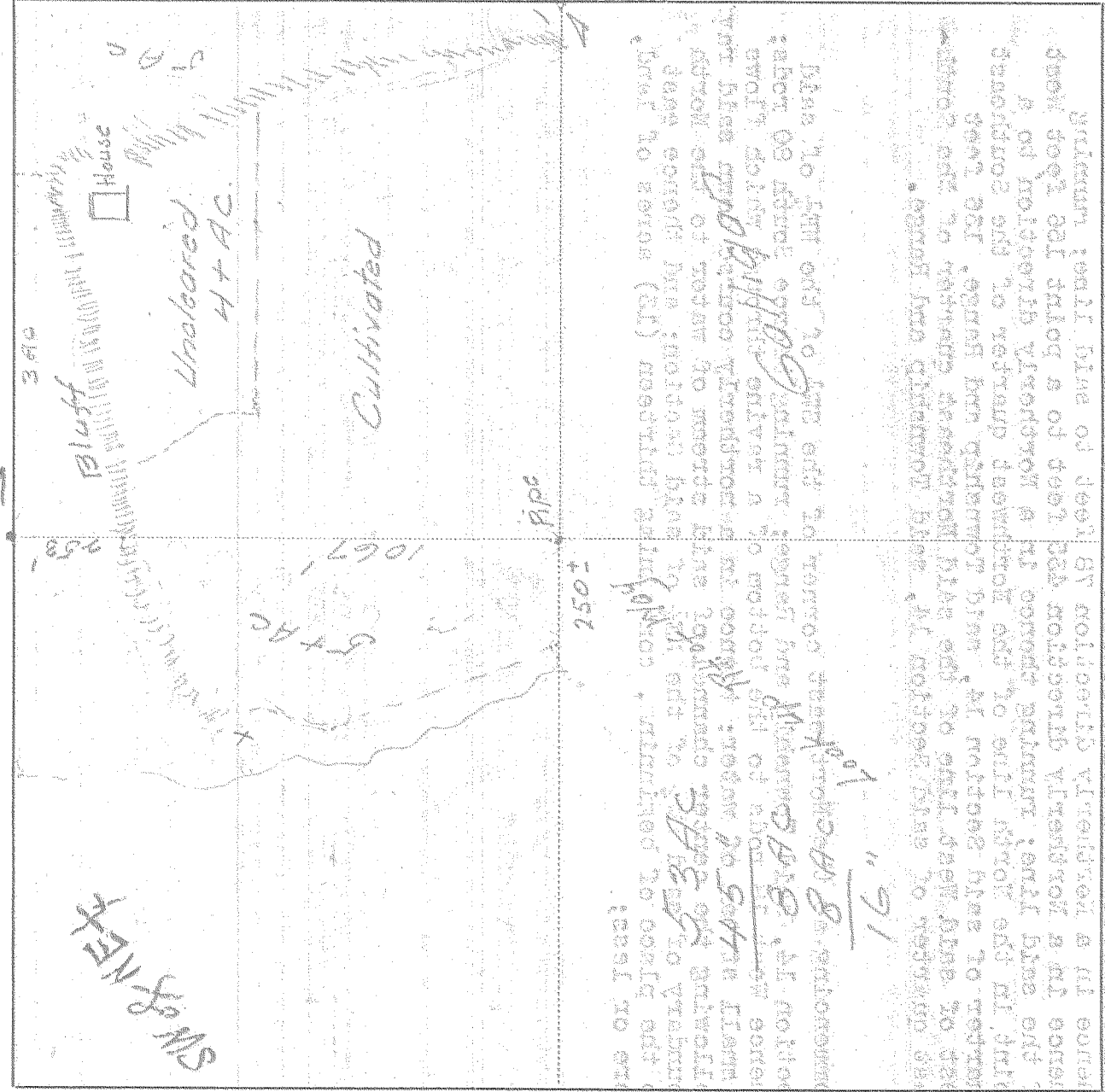

I do hereby certify that this sketch was made from notes taken during an actual survey by me on the 19th day of _____, 19__ and that it correctly represents the field work of said survey. I am a duly licensed Surveyor in the State of Oregon. My name is _____ and my commission number is _____.

County Surveyor
Hood River County, Oregon

9

0408

4-141

Helpers _____

2

Hoop River Camp, Oregon

RESERVING therefrom a right-of-way for road purposes 20 feet wide and extending 10 feet West and 10 feet East along the following described line: commencing ten feet East of the Northwest corner of the Southeast quarter of the Southeast quarter of said Section 14, said Township and Range; running thence in a Northwesterly direction 390 feet to a point 60 feet East of the West line of said Northeast quarter of the Southeast quarter of said Section 14, said Township and Range; running thence in a Northerly direction 360 feet to a point 35 feet East of said West line; running thence in a Northerly direction 78 feet to said line; running thence in a Northerly direction 435 feet to a point 156 feet West of the said line; running thence in a Northerly direction to a point in the North line of the Northwest quarter of the Southeast quarter of said Section 14, said Township and Range, 136 feet West of said West line of the said Northeast quarter of the Southeast quarter of said Section 14, said Township and Range.

Commencing at the Northeast corner of the SW $\frac{1}{4}$ of the NE $\frac{1}{4}$ of said Section 14, said Township and Range; running thence South 80 rods; thence West 18 rods to the bottom of a ravine through which flows a small stream of water; thence in a northerly course down said ravine, following the center channel of said stream of water to the North boundary of said SW $\frac{1}{4}$ of the NE $\frac{1}{4}$ of said Section; and thence east to the place of beginning, containing thirteen (13) acres of land, more or less;

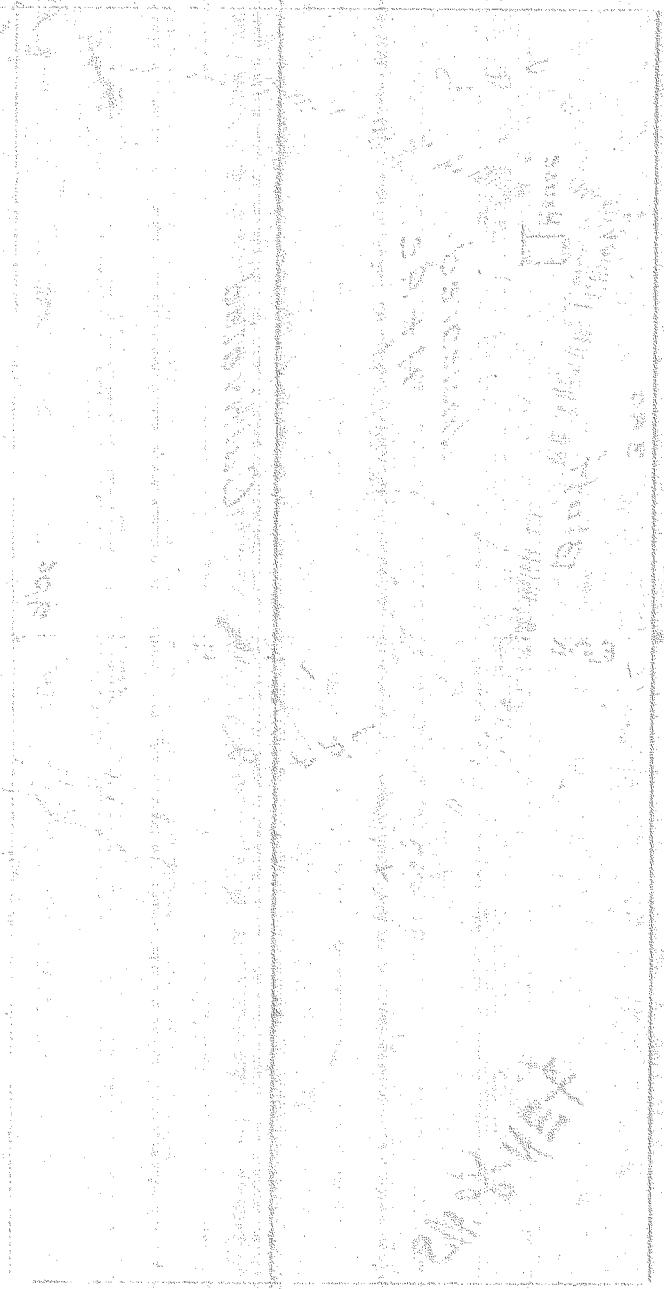

LOK

DVLETT

SECTION 14, TOWNSHIP 14 N., RANGE 10 W., COUNTY 10 W.