

SURVEY IN NE 1/4 NW 1/4, SECT 8, TWP. 1-S, RANGE 10, EAST W. M.

FOR CO DATE 7/7/41

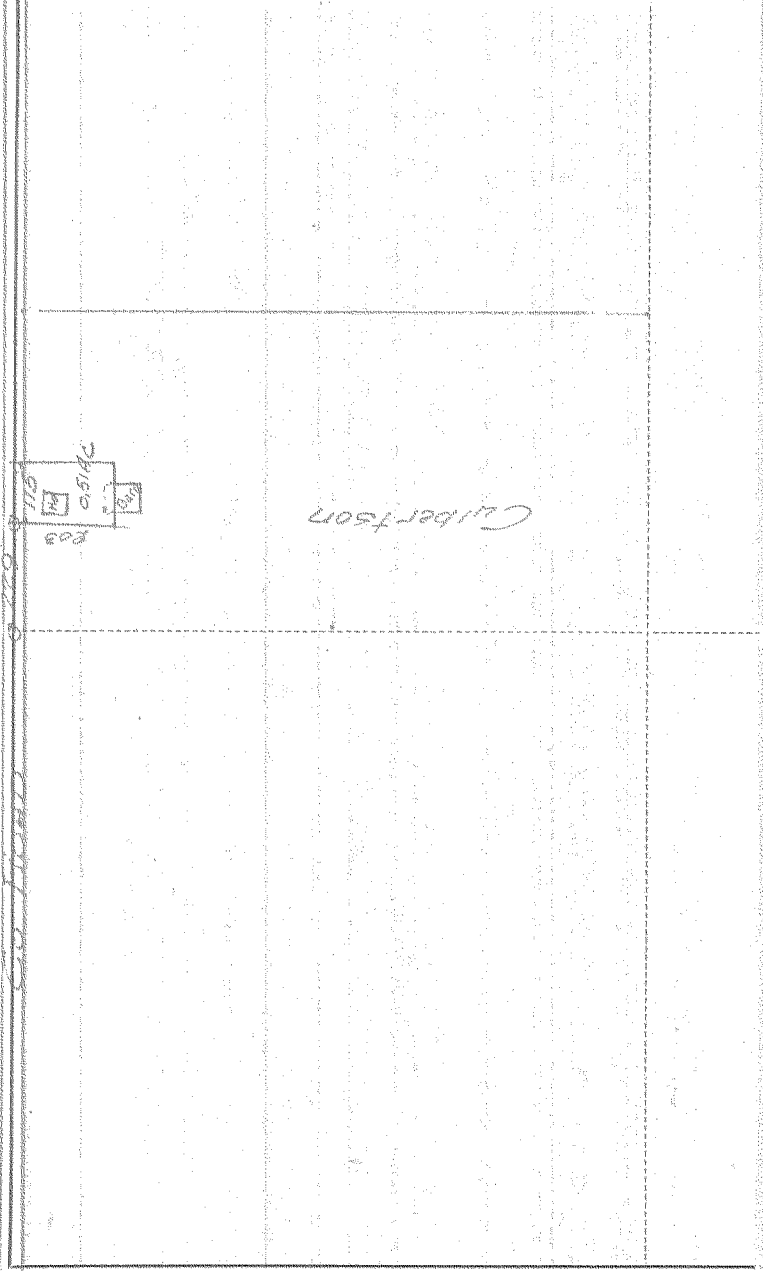

Save and excepting the following described ~~two~~ half acre tract, upon which stands the dwelling house and shed, and described as follows: Commencing at a point 229 ft East of the NW Cor. of the NE 1/4 of the NW 1/4 of Sec. 8 T. 1. S. R. 10. E. W. M.; thence East 115 ft; thence South 203 ft; thence West by the North line of the present barn 115 ft; thence North to the place of beginning 203 ft more or less. Containing 0.51 Ac.

\$

Scale 1 inch =

I do hereby certify that this sketch was made from notes taken during an actual survey by me on _____ 19_____, and that it correctly represents the field work of said survey.

2

County Surveyor
Hood River County, Oregon

Helpers _____

KUJAN 14892

0220 # 1-275