

To N 1/4 COR.  
S 6 T1S, R10E WM. ← 1697.3'

Point of Beginning

CENTER LINE BASE LINE ROAD N 89° 47' 43" E

← 222.00' → To Section corner,  
SECTIONS 32 & 33.

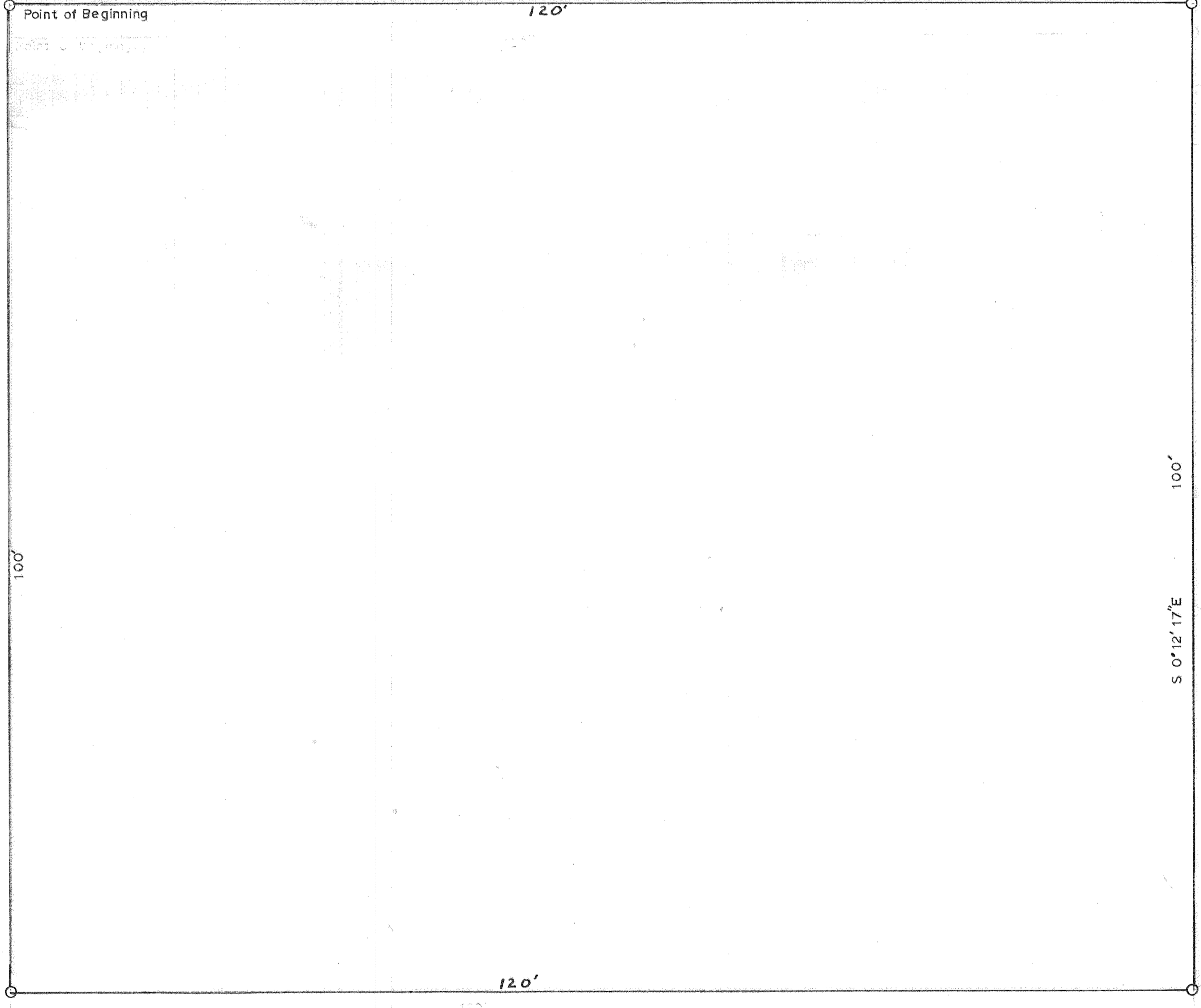

PLAT  
MIDDLE FORK IRRIGATION DISTRICT LOT  
On Base Line Road.  
S 6 T1 S., R10 E. W.M.  
HOOD RIVER COUNTY, OREGON

Scale 1" = 10'  
Date Dec 1962

3

