

Filed Sept. 8th, 1892.

State of Oregon)  
County of Wasco)SS

I hereby certify, that this is a true and correct plat of the Town of Winans in Wasco County State of Oregon, commencing at the  $\frac{1}{4}$  section corner on the township line between Twp 1, North Range, 9 & 10 east, said  $\frac{1}{4}$  sec. corner being the corner between section 4 and 1.

The distance and size of lots, blocks and streets are as shown in the plat. Surveyed June, 1892.

E.P.Sharp,  
County Surveyor.

Scale of 80 ft to the inch.

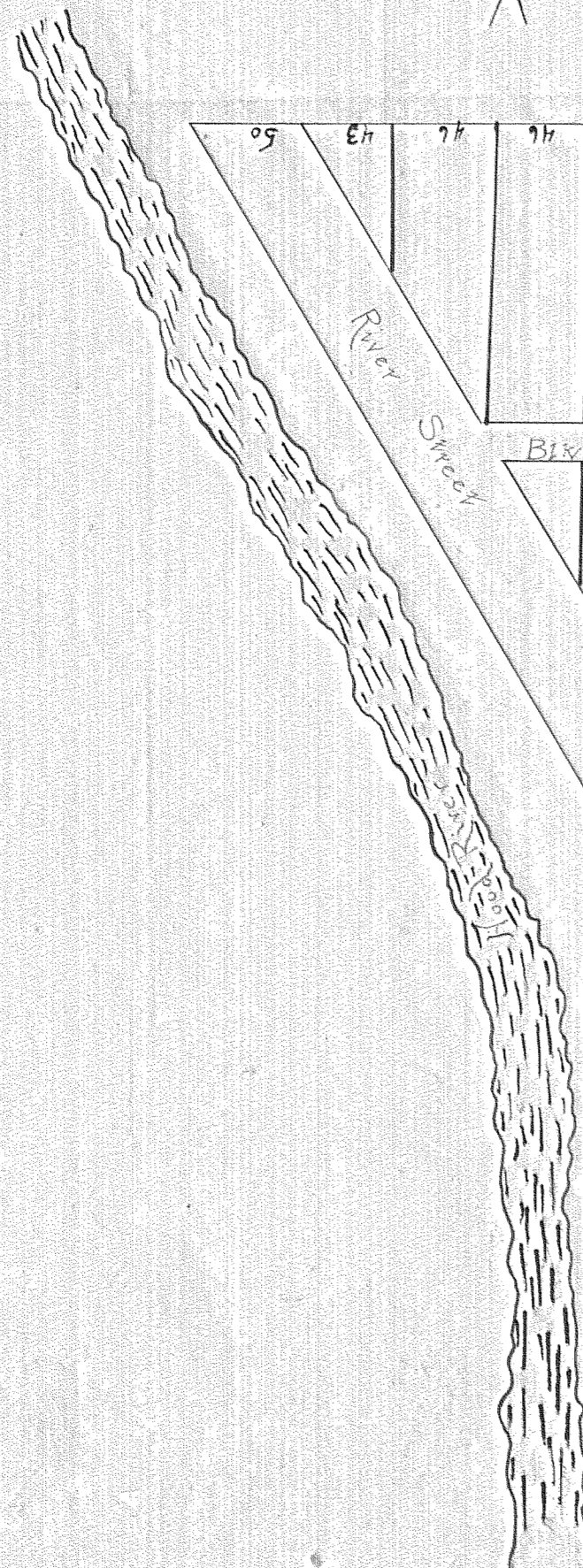

Know all men by these presents, That we, Wilson R. Winans and Mary Winans, husband and wife, of Wasco county, Oregon, owners under U.S. Land Laws of the SE $\frac{1}{4}$  of the NE $\frac{1}{4}$  of sec. (1) One Township One (1) North and of range nine (9) East Willamette Meridian, do hereby declare the attached map to be the record map of the town of Winans Wasco county, Oregon, said map having as its initial point the SE corner of the SE $\frac{1}{4}$  of the NE $\frac{1}{4}$  of section one (1) of township One (1) North of range Nine (9) East Willamette Meridian, said townsite comprising a portion of the said Southeast  $\frac{1}{4}$  of the Northeast quarter of section one (1) of township one (1) North of range Nine (9) East Willamette Meridian, as designated more particularly by the map, hereby dedicating to the use of the public all streets, alleys, avenues and public highways as set forth herein reserving the right of way for any and all railroads, telegraph, telephone and electric light lines, flumes, aqueducts, irrigating ditches, waterpipes.

In Witness whereof, we have hereunto set our hands and attached our seals this 21st day of September, A.D. 1892.  
Witness  
J.H. Cradlebaugh  
S.P. Blythe  
State of Oregon)  
County of Wasco)SS  
Wilson R. Winans  
Mary Winans

Be it remembered, that on this 21st day of September, A.D. 1892, before me, the undersigned, a Notary Public in and for the said County and State, came Wilson R. Winans and Mary Winans, his wife, to me personally known to be the identical persons whose names are attached to the within and foregoing deed of dedication and acknowledged the same to be their free and voluntary act for the purposes therein set forth.

In Witness whereof, I have hereunto set my hand and Notarial seal the day and year last above written.  
John H. Cradlebaugh,  
Notary Public for Oregon.

27