

LEAVENS' HEIGHTS

Adjoining Cascade Locks.

As Laid Out by H.A. Leavens.

And being a part of the N.W. 1/4 of the S.W. 1/4 of section 12, township 2 North,
Range 7 east, Willamette Meridian.

Filed for Record Nov. 30, 1894.

center of section 12

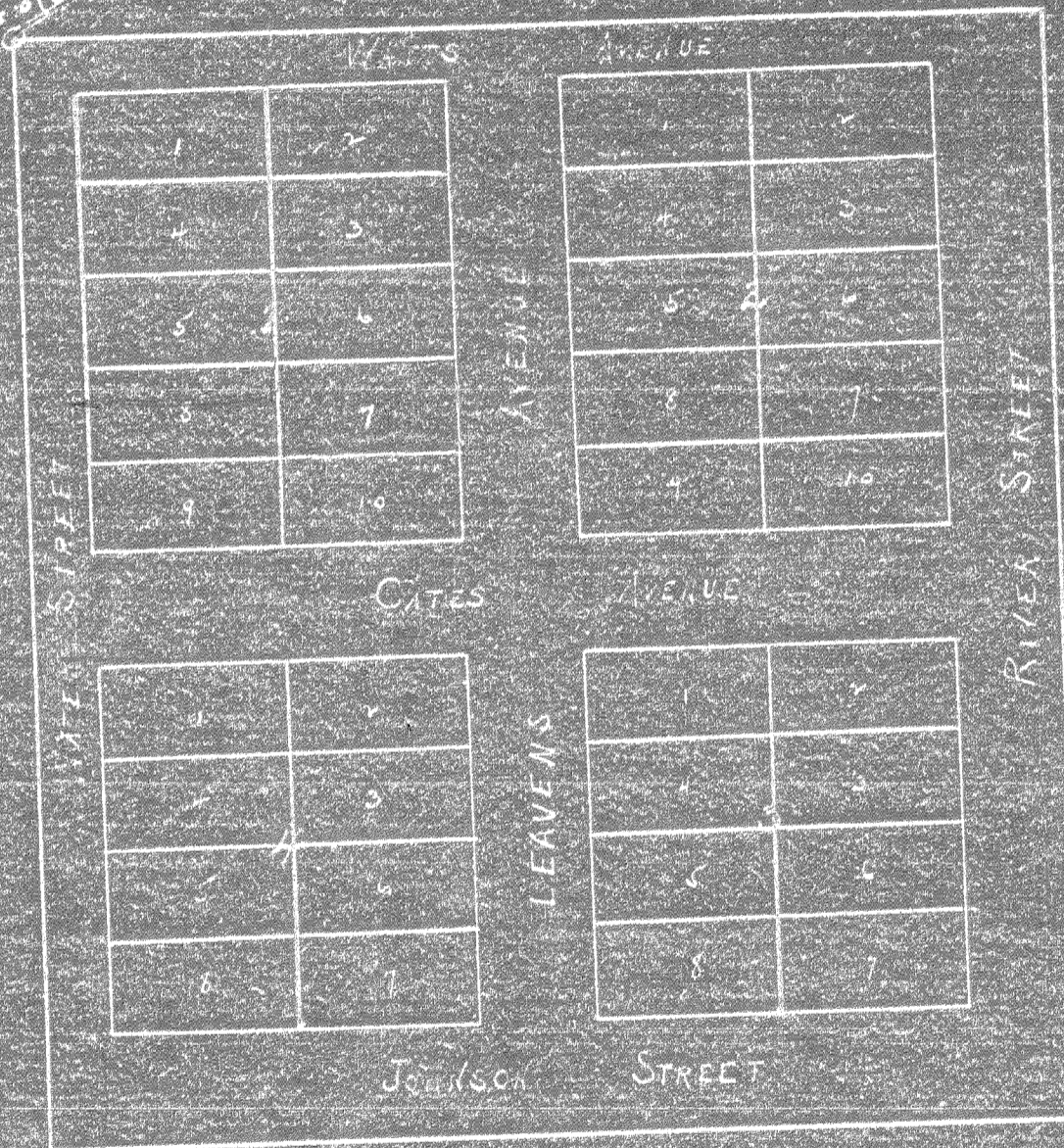

Scale 100 feet = 1 inch.

Thomas J. Elton and
 to
 J. P. McKinney } Filed for record Nov. 28th, 1894. @ 1:30 P. M.

This indenture, made on the 12th day of October A. D. One Thousand Eight Hundred and Eighty Nine by and between Thomas J. Elton and Clara E. Elton of Lincoln County, Mo. parties of the First Part and J. P. McKinney of the County of Wasco in the State of Oregon, party of the Second Part: Witnesseth.

That the said parties of the first part, in consideration of the sum of Fifty Two ⁰⁰/₁₀₀ Dollars, to them paid by the said party of the second part, the receipt of which is hereby acknowledged, do by these presents grant, bargain and sell, convey and confirm unto the said party of the second part, his heirs and assigns, the following described Lots, Tracts or Parcels of Land, lying, being and situate in Cells the County of Wasco and State of Oregon to wit:

Being west of and commencing at a point fifty feet from the line of a lot owned or occupied by R. M. Mallory as a Saloon in May 1867 on a line with the Saloon thence west one hundred and fifty six feet; thence South two hundred feet; thence East one hundred and fifty six feet; thence North two hundred feet to the place of beginning.

To have and to hold the premises aforesaid, with all and singular the rights, privileges, appurtenances and immunities thereto belonging or in any wise appertaining unto the said party of the second part and unto his heirs and assigns, Forever, the said Thomas J. Elton and Clara E. Elton hereby covenanting that they are lawfully seized of an indefeasible Estate in Fee in the premises herein conveyed; that they have good right to convey the same; that the said premises are free and clear of any incumbrances done or suffered by them or those under whom they claim, and that they will warrant and defend the title to the said premises unto the said party of the second party and unto his heirs and assigns forever, against the lawful claims and demands of all persons whomsoever.

In witness whereof, the said parties of the first part have hereunto set their hands and seals the day and year first above written;

signed, sealed and affixed
 at the presence of } Thomas J. Elton seal
 Clara E. Elton seal

State of Missouri } ss.
 County of Lincoln }

On this 12th day of October 1889 before me personally appeared Thomas J. Elton and Clara E. Elton his wife, to me known to be the persons described in and who executed the foregoing instrument, and acknowledged that they executed the same as their free act and deed.

In testimony whereof, I have hereunto set my hand and official seal, at my office in Tuxton the day and year first above written, my term expires November 23rd, 1889.

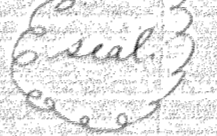

Wm. S. Pennington
 Notary Public

Filed for Record Nov. 30, 1894.

Leavens' Heights

Franklin

Adjoining Cascade Locks

As laid out by H.N. Leavens

and being a part of the NW 1/4 of the SE 1/4 of section 12, Township 2 North, Range 7 East
 Center of section 12. Williamette Meridian

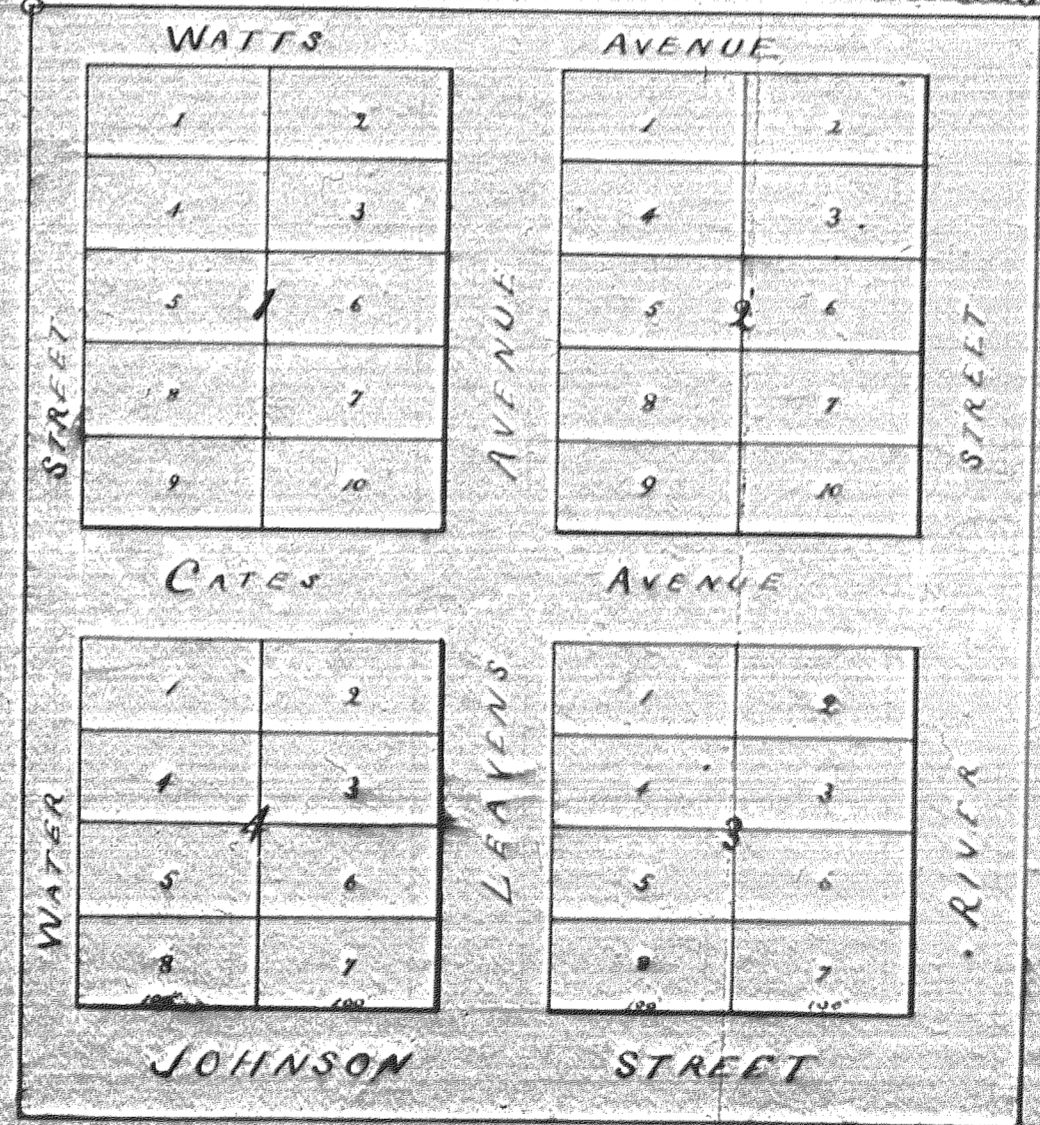

Scale 100 Feet = 1 Inch