

IDEWILDE ADDITION TO HOOD RIVER.

Scale 100 ft to an inch.

Situated in Sec. 26, T.3, N.R. 10 E.
W.M. Surveyed August, 1890 by S.A.
Detwiler & Co., Portland, Or.

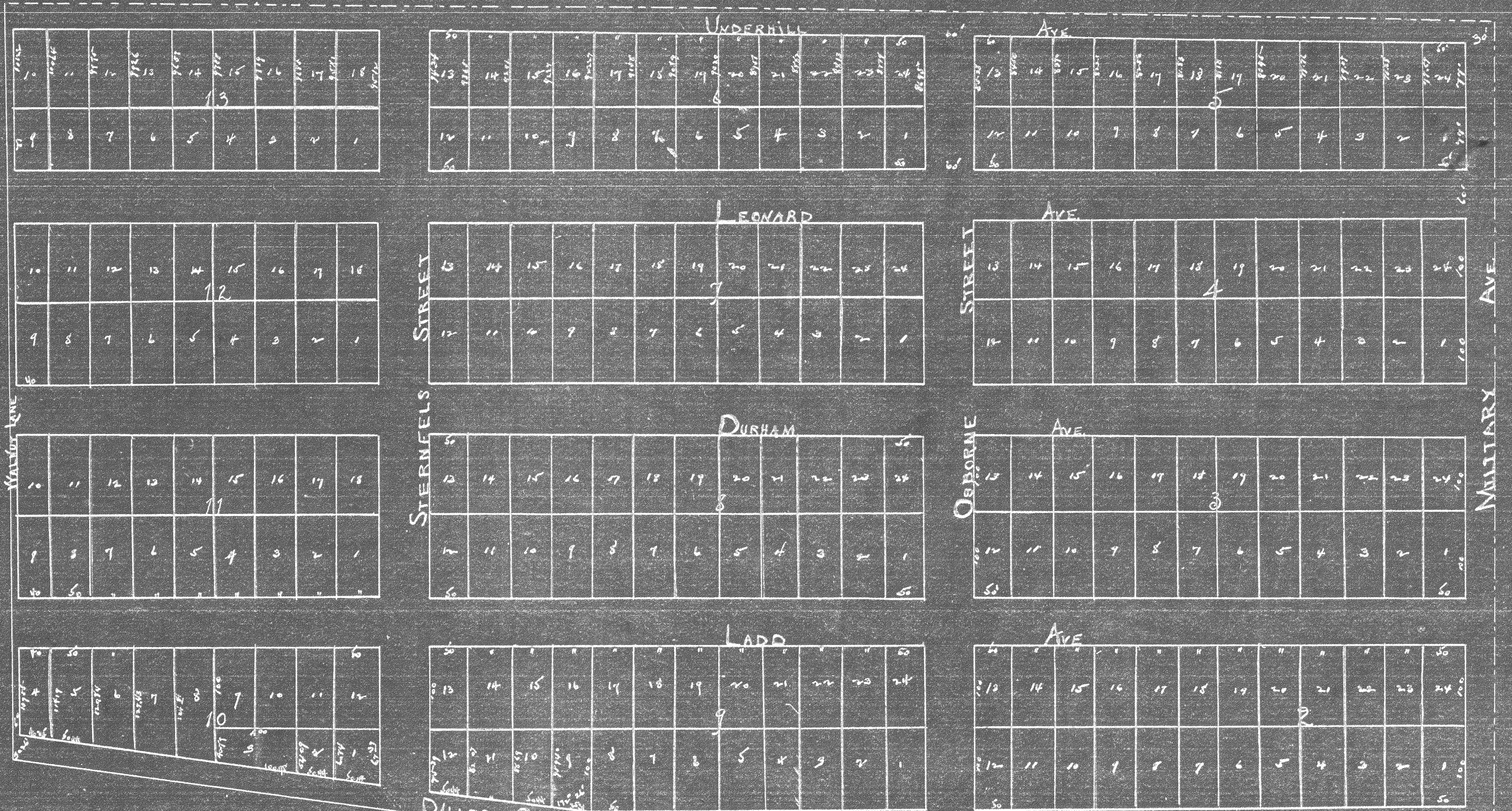

Know all men by these presents: That I, Leonard C. Jones, Trustee, in consideration of the premises do hereby dedicate unto the public the streets and alleys as laid down and set forth on the annexed plat for use as Streets and alleys.

In Witness whereof, I have hereunto set my hand and seal this 3rd day of September, A.D. 1890
Leonard C. Jones, Trustee.

Executed in the presence of:
T. J. Watson, Milton W. Runt,
State of Oregon)

County of Multnomah)

Be it remembered, that on this 3rd day of September, A.D. 1890, before me, the undersigned a Notary Public in and for said County and State, personally appeared Leonard C. Jones, Trustee, who is known to me, to be the individual described in and who executed the foregoing instrument and acknowledged to me that he executed the same for the uses and purposes set forth.

In Testimony whereof, I have hereunto set my hand and Notarial seal the day and year last above written.

(Seal)

Chas. J. Schnabel,
Notary Public for Oregon.

State of Oregon)
County of Multnomah)

I, S.A. Detwiler & Co., being first duly sworn depose and say I surveyed the land represented on the annexed plat; That I have correctly surveyed and marked with proper monuments the land as represented on said plat; That I planted a proper stone monument indicating the initial point of such survey of the following dimensions: 4" x 3" x 12" (Basalt Stone) commencing at the N.E. Corner of said tract, from which -- bears -- said monument is located at the N.E. Corner of claim 33 in township 3 North, range 10 E. Willamette Meridian.

S.A. Detwiler & Co.
Subscribed and sworn to before me this second day of September, 1890.

(Seal)

T. J. Watson, Notary Public
for State of Oregon.

Edley