

CS# 88045

NARRATIVE

Survey in Section 6, Twp. 1 North Range 11 East, W.M.
Aug. 1988

This survey was performed at the request of the Hood River County Forestry Dept. in order to locate property lines and corners in Sec. 6 T1NR11E.

All four quarter-corners and the NE and SE section corners were found and accepted and tied by field traverse. The section was then subdivided following procedures outlined in the 1973 Manual of Surveying Instructions. Property corners were then set, and some of the property lines were blazed (see drawing). The 20.78 foot strip of land in the SE 1/4 SE 1/4 highlighted on the plat of this survey (see drawing) is a result of a gap in the deeds. In 1969 Hood River County deeded "the South 214.5 feet of the SE1/4 SE1/4..." to John and Dorothea Long. It is obvious that the intent of this conveyance was to deed all the property south of the south line of what is now Tax Lot 900 to the Long's. All the deeds written in this quarter-quarter section assumed the north-south distance to be an even 1320 feet, however, the measured distance is considerably longer than 1320 feet, resulting in the gap. Hood River County has no desire to retain this strip, so a correction deed will be written to correct the 1969 conveyance.

Dick Arnold,

County Surveyor

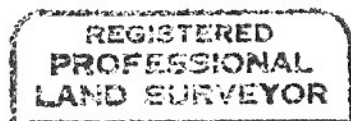

Richard E. Arnold

