

FIELD NOTES:

A survey for DAN GEHRIG of a tract of land in the S.E. 1/4, of the S. W. 1/4 of Section 21, T. 2 N., R. 10 E., W.M., Hood River County, Oregon.

CREW: David L. Tuttle, Partychief.
Robert L. Ulrich, Chainman.
Robert Wiggin, Chainman.

#7588

REFERENCES: Hood River County Surveyor's corner references.
T.E.C. Survey #4432 for E. L. Lewis, 1973.
T.E.C. Survey #2662 for Linville Agency, 1962.
Plog survey signed by Hurlburt, Co., Surveyor, 1939.

DATE COMPLETED:

December 3, 1975.

On October 29, 1975, our firm was retained by Dan Gehrig of Odell, Oregon, to survey a tract of land in the S. E. 1/4 of the S. W. 1/4 of Section 21, T. 2 N., R. 10 E., W.M., Hood River County, Oregon.

The survey was started by recovering the S. 1/4 corner of Section 21. This corner is monumented with an iron pipe and was recovered by our firm in April, 1973, during the course of a survey for E. L. Lewis, T.E.C. work order #4432. A true line was established to the apparent center 1/4 corner, a 1" iron pipe found buried about 1/2 foot under a paved driveway. This corner was pointed out to us by Mr. Chamberlin who owns the driveway in which it is located. He said this corner had been set or used by Mr. Jerry Mahoney, then employed by the Hood River County Surveyor's office during the course of a survey performed by him for Mr. Chamberlin. He also stated the county surveyors had recently uncovered this point for a survey they had conducted in this area.

A true line was run between these found points and the distance measured electronically. The 1/16 corner, the point of beginning of Gehrig's description, was set at the mid-point.

The County Surveyor's office was contacted in regard to additional surveys and corner references in this area. It was found that they had no records regarding the center 1/4 and did not recognize the existing monument. It was also stated that their personnel had not used this point and the party that had, was not licensed to practice land surveying. At this point it was necessary to locate and tie additional corners of record to prove or disprove the existing center 1/4 corner. A traverse was run from our temporary 1/16 corner to tie with the S. W. 1/16, a 2" iron pipe and the south 1/16 on the west boundary of Section 21, a 2" iron pipe set in a north-south fenceline. A straight line was computed between these two found points and found to agree with our temporary 1/16 corner set along the center of section line, insofar as the north-south position was concerned. The line formed between the S. 1/4 corner and the Center 1/4 in question was produced Northerly to the N. 1/4 corner. This point is a mound of stones found by our firm in 1962 during the course of a survey for Linville Agency. The line so produced fell 30.57 feet west of the N. 1/4 corner. Our temporary 1/16 corner was adjusted Easternly to its true position on the N-S center of section line. Its N-S position was held based on the supportive evidence

of being both midway between two corners and on a line common to the 1/16 corners to the West. A railroad spike was driven into the paved county roadway to monument this corner. From this 1/16 corner the deed description was followed in laying out Mr. Gehrig's corners and lines. All corners set were 5/8" iron rods except for the S. W. corner which is a concrete nail set in a paved drive strip. A newly constructed 22' X 50' building was found to encroach entirely within the S. W. corner of Mr. Gehrig's parcel. The south line also encompasses portions of lawn and shrubs of the party to the south. This matter was pointed out to Mr. Gehrig during his presence on the site in question. It was brought to our attention that the parcel to the south had been surveyed by an unlicensed surveyor. The parcels of land lying south of Mr. Gehrig's land have deed calls of 165' plus or minus, north of the north right-of-way of the county road to the south line of the Cameron tract.

It is felt that these distances were assumed to be exactly 165 feet and that survey was based on that erroneous assumption. It is also noted that the present existing county road may not be in its original or true position according to several alignment maps that were examined at the County Surveyor's office. Several of the adjoining property owners felt that the Plog Survey of 1939, of which these parcels with the related more or less distances from the county road were supposedly described from, was never actually performed in the field. This assumption was based upon the fact no monuments exist or were found relating to this survey.

Corners found and established in the course of the above survey, together with measured bearings, distances and ties, are shown on the attached map, T.E.C. Work Order #5216, which by reference is made a part hereof.

Signed

David L. Tuttle
David L. Tuttle

Oregon Registered Land Surveyor #872

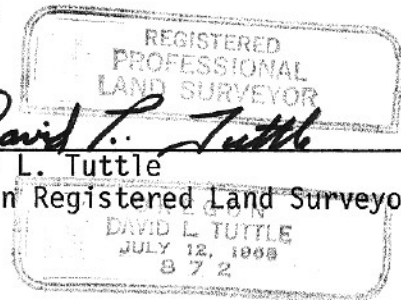

CHECKED AND APPROVED:

Tennessee Engineering Corporation

Donald J. Branton
Donald J. Branton, President

