

FIELD NOTES:

A survey for SCS DEVELOPMENT of Lots 9 and 10, Block 10, Hull's Subdivision of Tracts "A" and "B", Pleasant View Addition, City of Hood River, Hood River County, Oregon.

CREW: David L. Tuttle, Partychief.  
Robert A. Wiggin, Chainman.

REFERENCES: T.E.C. Work Order #4127.  
T.E.C. Work Order #3688.

# 7585

A search was made of available records. We found T.E.C. work order #4127, a survey of a portion of Lot 20, Block 10 of the same subdivision. We identified the N.W. corner of the block and several intermediate lot corners along the north line of the block and a 3/4" iron pipe in the N.E. corner of the block and also established the north line of the alley at 12th Street and found a 3/4" iron pipe at the N.E. corner of Lot 10.

The two found pipes on the east line of the block were found to check at plat call distances between them within .08 ft. and were used as the basis of this survey. The east line of the block was pushed south the call distance and east-west distances were measured along the north line of the alley and found to check with plat call within 0.13 ft.

At this point the south line of the block was established being parallel to the alley and a check made for monuments along that line. It became immediately apparent there were some wholesale discrepancies in surveys on either side of Wilson Street as monuments were found indicating the line being anywhere from 1 foot to 5 feet to the north. These discrepancies are believed to be due to the fact that the 1/4 corner located in 12th Street and the east-west section line which comes down Wilson Street has been adjusted over a period of years by different surveys. There are in fact maps showing three different positions for this corner differing by as much as 26 feet. The line established by using plat calls appears to fit the existing street improvements within reason. This plus the fact there was no record of how the previous monuments were set or by who, was weighed and a decision was made to use the existing plat calls in the north-south direction to proceed with the layout of the subject tract.

The lots were laid out prorating the east-west discrepancy with the lot lines being parallel with the alley line and north line of the block in the lines established by the found monuments on the east line of the block.

Monuments, angles and distances found and established in the course of this survey are shown on the attached map, T.E.C. Work Order #5211 which by reference is made a part hereof.

I certify this work was done under my direct supervision.

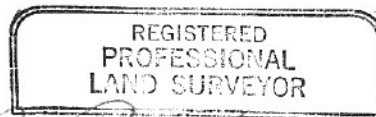

Signed Donald J. Branton  
Donald J. Branton, Oregon Land Surveyor #385  
President of Tennesson Engineering Corporation  
DONALD J. BRANTON  
385