

FIELD NOTES: A survey for HOOD RIVER CITY of a tract of land in Section 30 and Section 31, T.3 N., R.11 E., W.M., Hood River County, Oregon.

CREW: David L. Tuttle, Partychief.
Lawrence E. Jones, Partychief.
John J. Verellen, Transitman.
Robert Ulrich, Transitman.
Cris Cosby, Chainman.

7555

REFERENCES: Bonneville Land Map
Survey for Northwest Natural Gas Co., T.E.C. W.O. #3605
Hood River Co. Surveyor's Reference Files

DATE COMPLETED:

In September, 1973, our firm was retained by the City of Hood River to survey a tract of land in Sections 30 and 31, T.3 N., R.13 E., W.M. The intent of the survey was to establish the boundaries of a tract of land used as a garbage dump site, to clarify certain apparent bearing and distance discrepancies in the deed description and to check for possible gravel excavation encroachments by other parties.

Prior to starting the survey we researched the County Surveyor's files and our private files for existing monuments and prior surveys of record. Copies of the recorded information was obtained and used as reference during our search for existing monuments to carry out the required survey. Those corners found and used are as follows: The N. 1/4 corner, monumented with a Corps of Engineers' brass cap. The E. 1/4 corner, monumented with a Corps of Engineers' brass cap. The S. 1/4 corner, a 1" iron pipe. This corner is in agreement with the recorded information that was provided to us by the County Surveyor's Office. The W. 1/4 corner is a 1" iron pipe used by our firm in 1961 during the course of a survey for Northwest Natural Gas Co., T.E.C. work order #3605. This corner is also of record in the County Surveyor's Office. The N.W. corner is a Corps of Engineers' brass cap monument. The S.E. section corner is a 1-1/2" iron pipe and witnessed by a Forestry poster attached to a 12" oak tree, North, 5 ft.

All of the above corners were tied into a traverse network and connected into the U.S.C. & G.S. coordinate and bearing system. A search was made for the N.E. 1/16 corner, this point being the point of beginning of the City's tract of land. It was believed this corner was either set or found by Mart Perkins, #3388, in 1957. The old recorded notes are some what vague as to the history of this corner. The old notes indicated an oak bearing tree in reference to this corner. The search for this monument produced little evidence of its former location. Due to various gravel excavation activities in this area, the landscape has been completely altered and all trees removed along with the old bearing tree.

The section was subdivided into the necessary lines and corners to complete the survey. The N.E. corner was established theoretically by protraction of the North and East lines of the section. The remainder of the section was subdivided on this basis. The N. 1/16 corner on the East line of the section was set and monumented with a brass cap attached to a 3/4" iron pipe. Two bearing trees were set in reference to this corner. A 6" oak bears N. 21° W., 20.7 ft. A 10" oak bears S. 14° E., 27.3 ft. A found 1-1/2" pipe bears S. 35° 58' 10" E., 50.91 ft. No recorded information could be found relating to this pipe. Since this corner

could not of been set in accordance with the perscribed methods set forth in the B.L.M. manual and lacking any information to determine otherwise or substantiate its present location it was not excepted as the true corner. The S.E. corner of the N.W. 1/4 of the N.E. 1/4, the point of beginning of the City's property, was set and monumented with a 5/8" iron rod. Due to the present gravel excavation in this area this corner will probably be destroyed in the near future. A railroad spike was placed 152.85 ft. South of it as a reference. This point is in the centerline of the Old Columbia River Highway and is also on the 1/16 line. Several 5/8" iron rods were placed at random along this same line to the North of the corner. Another railroad spike was placed 143.65 ft. West of the 1/16 corner as a reference. This point is also at the intersection of the Highway and the 1/16 line.

The survey of the City's parcel was started at its point of beginning as described above. The 1/16 line was extended westerly 300 ft. and a 5/8" iron rod set. From this point the line was produced northwesterly to a large oak as called for in the deed description. This tree bears N. 11° 37' 27" W., 715.28 ft. The deed call is N. 18° 51' W., 713 ft. This tree is believed to be the one called for in the description dispite the discrepancies noted. In field book #31, taken from the City Engineer's Office, there is a copy of the narrative notes regarding the original survey of this tract. As stated forth in the these notes, the fence was built to an oak tree which was an angle point on the West boundary of the tract. The fence lines bear this relationship out. The old measurements were taken by stadia which could account for the distance discrepancies. The bearings were taken by compass and the notes show were various bearing readings were recorded and then altered to show other readings. From the oak tree we ran N. 29° 35' 56" W., 742.38 ft. to a point that was set 458 ft. East of the N. 1/4 corner. The deed calls for this line to be N. 33° 00' W., 790 ft. This discrepancy is again attributed to the methods used to survey the original parcel. A 1" iron pipe was found setting about 430 ft. East of the N. 1/4 corner and about 6 ft. North of the section line. No recorded survey or evidence could be found to correspond or relate to the presence of this pipe. Random iron pipes were placed along the West boundary to mark its location.

All measurements were made electronically and bearings are based on a tie to U.S.C. & G.S. triangulations stations.

Corners found and established in the course of the above survey, together with measured bearings, distances, and ties, are shown on the attached map, which by reference is made a part hereof.

Signed

David L. Tuttle

David L. Tuttle, Ore. Land Surveyor #872

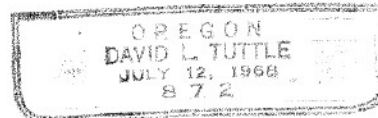
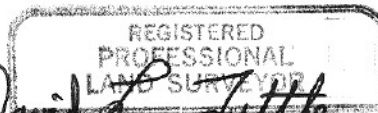

CHECKED AND APPROVED

Tenneson Engineering Corporation

Donald J. Branton

Donald J. Branton, President

