

1322

March 30, 1973
W.O. #4394

CS 7322
RECEIVED
DATE 4/18/73

FIELD NOTES:

A survey for R. W. Thoman of a tract of land in the S.W. 1/4 of the N.W. 1/4 of Section 35, T. 2 N., R. 10 E., Hood River County, Oregon.

CREW: David L. Tuttle, Party Chief
Larry Jones, Transitman

DATE COMPLETED: March 27, 1973

REFERENCES: Hood River County Surveyor's Corner Reference Materials.
Plat Map of Section 35.
Spitzmesser Deed.
T.E.C. 8-1/2" x 11" Map, W.O. #4394

On March 16, 1973 our firm was retained by Mr. R. W. Thoman of Parkdale, Oregon, to perform a survey near Odell, Oregon. The purpose of the survey was to establish the corners and lines for a 420' x 155' tract of land, and a 20' roadway connecting the tract to an existing County road to the East (Straight Road).

On March 16, 1973 we made a search of the County Surveyor's files for any recorded surveys conducted in the area. A copy of the existing corners and their references was obtained. The West 1/4 corner of Section 35 was not on file. The County was in the process of resetting this corner and provided us with the necessary information to reset it from their traverse lines and points.

On March 20, 1973 we searched the area for those corners pertinent in locating Mr. Thoman's parcel. The N.W. corner of Section 35 was found to be monumented with a 3" pipe driven flush with the ground and referenced with County Witness Tags attached to several trees. The North 1/4 corner of Section 35 was monumented with a 1" iron pipe buried about 1 foot below the paved surface of a County road. Two County Metal Witness Tags referenced the corner. The East 1/4 corner was monumented with a basalt stone marked "1/4". Two oak bearing trees were also found and appeared to be the original ones set by the government. The South 1/4 corner was monumented with a 2" axel buried about 1 foot below the surface of a paved roadway. All references to this corner have been lost or destroyed.

A traverse was run between the above mentioned corners, connecting them into a network. Distances were measured with a Hewlett Packard Distance Meter. The section was then subdivided according to the instructions set forth in the B.L.M. manual. It was found at this time that the position of the West 1/4 corner, as set from the County ties, was not in its true position. It was necessary at this time to check its position by tying the S.W. corner of Section 35. It was found to be monumented with a 2" axel and referenced with witness tags on power poles. The position of the missing West 1/4 corner was then calculated to a proportioned position between the found section corners.

On March 23, 1973 we surveyed and set the corners of Mr. Thoman's tract. The point of beginning, being the North 1/16 corner on the West line of Section 35, was set from our traverse line. Its position was monumented with a 1-1/2" pipe. The remainder of the survey was carried out using those distances recorded on the

FILED

JUL 27 1973

Carlos Van Elberg
COUNTY SURVEYOR

Spitzmesser deed. The West line being 420' North of the 1/16 corner and the South line running East along the 1/16 line to its intersection with Straight Road.

A 420' x 155' tract belonging to Mr. Thoman was then surveyed out of the West side of the Spitzmesser tract. A 20' roadway was run parallel with the South line, connecting Thoman's tract to Straight Road. An encroachment of an open shed was noted on the South line of the road and tied into the survey. Railroad spikes were set to locate the road intersects. The other corners are 3/8" iron rods.

Corners found and established in the course of the above survey, together with measured bearings, distances and ties, are shown on the attached map, which by reference is made a part hereof.

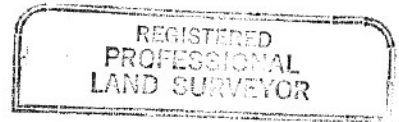

Signed

David L. Tuttle

David L. Tuttle - Oregon Land Surveyor #872

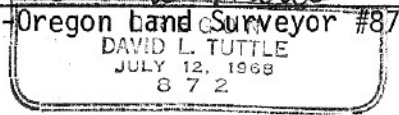

CHECKED AND APPROVED:

Tennessee Engineering Corporation

Donald J. Branton
Donald J. Branton, President

