

CONSULTING  
**Engineers** TENNESON ENGINEERING CORPORATION

PHONE Cypress 6-9177  
 412 WEST SECOND PLACE  
 THE DALLES, ORE. 97058

June 17, 1966

FIELD NOTES

FOR: Arne Udelius - Work Order #3596-66 - Survey in the Southwest one-quarter of the Southwest one-quarter of Section 23, Township 2 North, Range 10 East of the Willamette Meridian, Hood River County, Oregon.

CREW: Verl R. Fraley, Party Chief and Oregon Land Surveyor #187  
 Lowell Finn, Chainman  
 Stan Tenold, Chainman

**FILED**

DATE PERFORMED: June 6, 1966

WEATHER: Cool - 65° F.

JAN 19 1970

*Carroll H. Shoberg*  
 COUNTY SURVEYOR

On May 25, 1966, our firm was retained by Arne Udelius to ~~survey~~ survey a part of his property near Odell, Oregon.

We first acquired a copy of an Oregon Highway map which showed the Government corners in the vicinity.

We found a 1" iron pin with a painted white cross at the intersection of an East-West County Road and Oregon State Secondary Road #282. According to the Highway Map this is the Section corner common to Sections 22, 23, 26 and 27 and is 0.26 of a foot West of the centerline of the Highway.

At Highway Station 92 + 55 P.T., we found an iron rod and right-of-way post on the West right-of-way line of the Highway. The centerline of the Highway #282 was established from this iron rod and by setting a nail 0.26 feet East of the Section corner.

The centerline of the County Road was established by running a traverse East to the North one-quarter corner of Section 23, which is an iron rod marked with a painted white cross. The West one-quarter corner of Section 23, which is a 1" iron pin, was located but not necessarily needed on this survey.

Monuments found and set, together with the measured distances and bearings used on this survey, are shown on the attached map, which is by reference made a part of these notes.

1  
 2 N 10 23

FIELD NOTES  
Arne Udelius  
June 17, 1966

Page - 2 -

I certify that this work was done under my direct supervision.

Signed Verl R. Fraley, Oregon Land Surveyor #183

CHECKED AND APPROVED:

TENNESON ENGINEERING CORPORATION

*Donald J. Branton*

Donald J. Branton, President



DJB:kkk

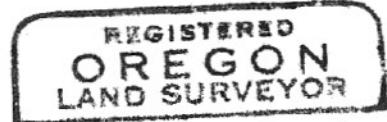

*Verl R. Fraley*

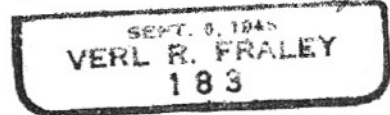

**FILED**

APR 29 1969

*Carl Van Elberg*  
COUNTY SURVEYOR

DEPUTY



FROM

**Tonnason Engineering Corporation**  
 Consulting Engineers  
 412 West Second Place  
 THE DALLES, OREGON 97058



TO

DATE	6/27/66	JOB NO.	3596-66
ATTENTION:			
RE:			

Hood River County Ordinance

Hood River County Court House

Hood River, Oregon

GENTLEMEN:

WE ARE SENDING YOU  ATTACHED  UNDER SEPARATE COVER VIA \_\_\_\_\_ THE FOLLOWING ITEMS:

- SHOP DRAWINGS   
  PRINTS   
  PLANS   
  SAMPLES   
  SPECIFICATIONS  
 COPY OF LETTER   
  Field Notes

COPIES	DATE OR NO.	DESCRIPTION
1	3596	Field Notes of Survey in the SW <sup>1</sup> / <sub>4</sub> of the SW <sup>1</sup> / <sub>4</sub> of Section 23, Township 2 North, Range 10 East of the Willamette Meridian, Hood River County, Oregon. (Arne Udellius)
1	3596	Map of Survey for Arne Udellius.

THESE ARE TRANSMITTED AS CHECKED BELOW:

- FOR APPROVAL   
  APPROVED AS SUBMITTED   
  RESUBMIT \_\_\_\_\_ COPIES FOR APPROVAL  
 FOR YOUR USE   
  APPROVED AS NOTED   
  SUBMIT \_\_\_\_\_ COPIES FOR DISTRIBUTION  
 AS REQUESTED   
  RETURNED FOR CORRECTIONS   
  RETURN \_\_\_\_\_ CORRECTED PRINTS  
 FOR REVIEW AND COMMENT   
  \_\_\_\_\_  
 FOR BIDS DUE \_\_\_\_\_ 19\_\_\_\_   
  PRINTS RETURNED AFTER LOAN TO US

REMARKS:

Please file enclosed map and survey notes of the Survey for Arne Udellius in the SW<sup>1</sup>/<sub>4</sub> of the SW<sup>1</sup>/<sub>4</sub> of Section 23, Township 2 North, Range 10 East of the Willamette Meridian, Hood River County, Oregon, performed by our firm.

cc - Arne Udellius

IF ENCLOSURES ARE NOT AS NOTED, KINDLY NOTIFY US AT ONCE.

SIGNED: *Donald J. Branton*  
 Donald J. Branton, President